

CENTRAL AVENUE

(99' PUBLIC R.O.W.)

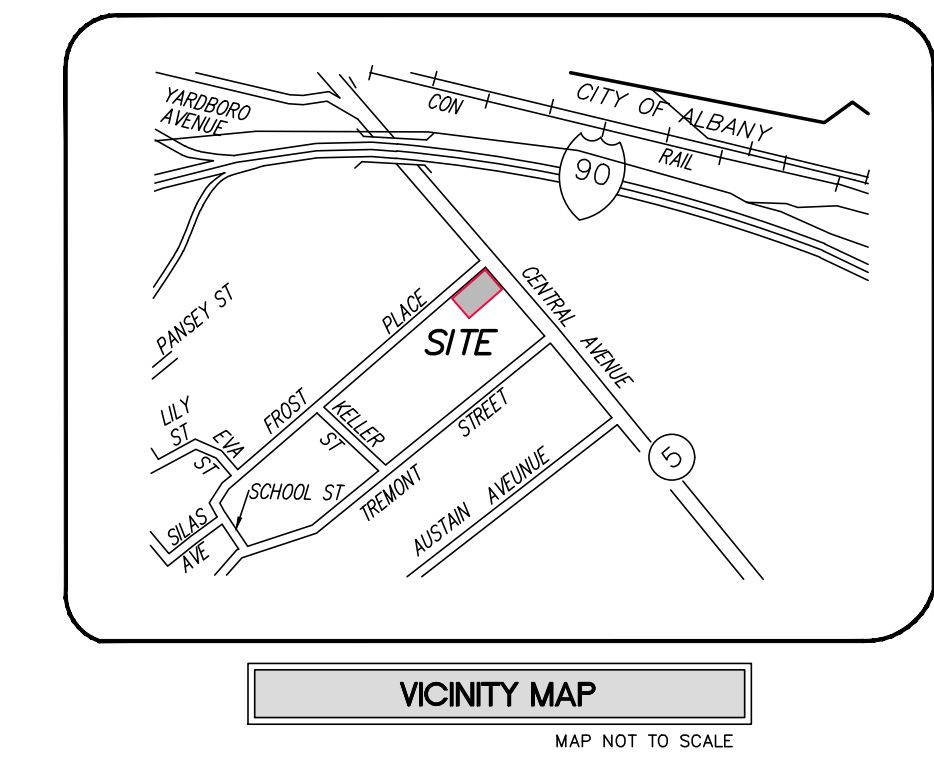
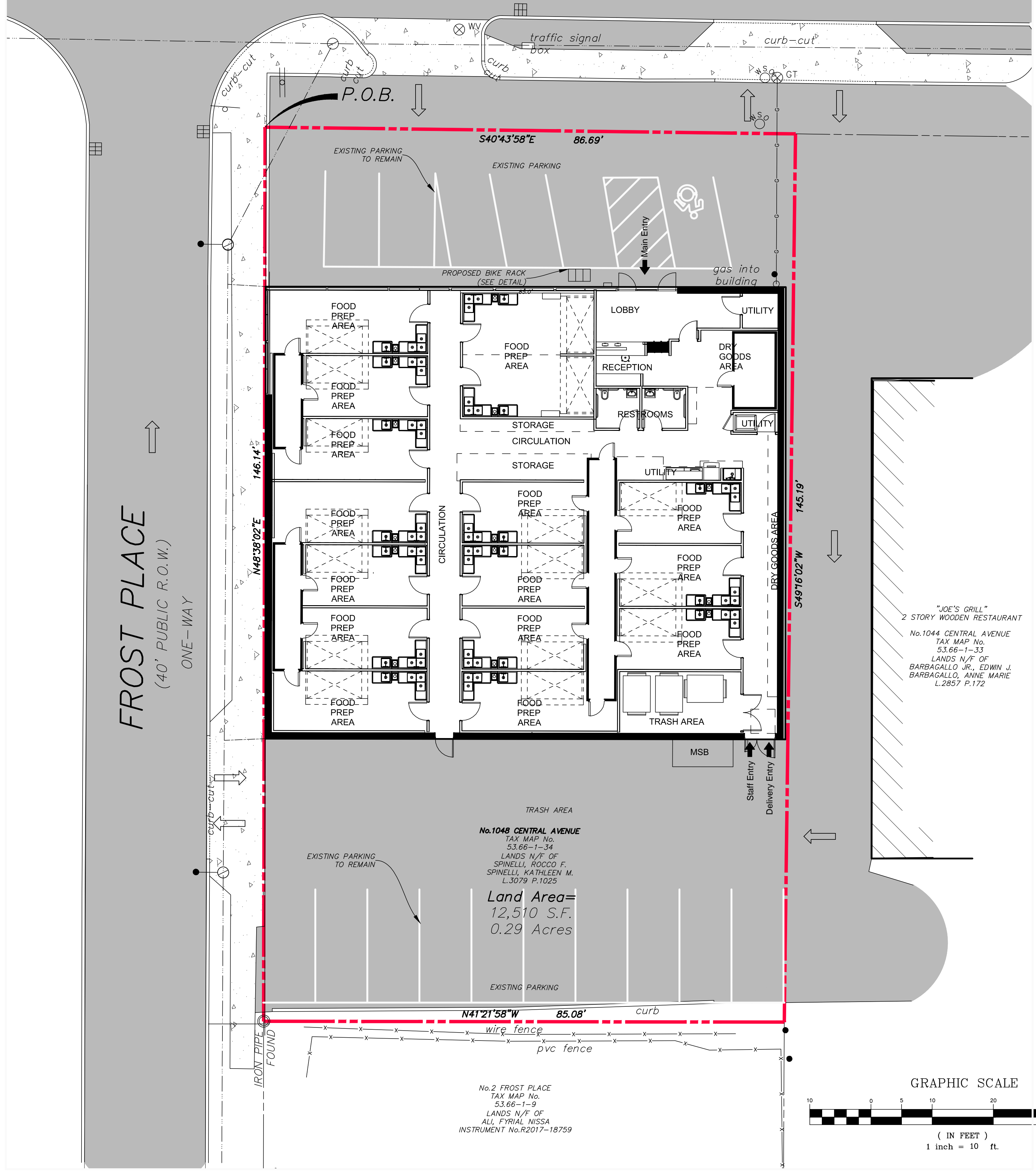

LEGEND			
R.O.W.	RIGHT OF WAY	○	IRON ROD
No.	NUMBER	■	CATCHBASIN
P.O.B.	POINT OF BEGINNING	—	SIGN
S.F.	SQUARE FEET	●	BOLLARD
N/F	NOW OR FORMERLY	—X—	FENCE LINE
(150')	RECORD	—○—	OVERHEAD WIRE, UTILITY POLE & GUY WIRE
MEASURED		↔	TRAFFIC FLOW ACCESS AREA
N	NORTH	⊕	WATER SHUT OFF
S	SOUTH	⊖	WATER VALVE
E	EAST	⊙	GAS VALVE
W	WEST	⊙	MANHOLE
L	LIBER	○	STREET LIGHT
P.	PAGE	■	CONCRETE
○	HANDICAPPED PARKING SPACE	■	PAVEMENT

CITY OF ALBANY NOTES

SITE REQUIREMENTS:
 THE CONTRACTOR WILL BE RESPONSIBLE FOR THE FOLLOWING:
 THE REMOVAL AND REPLACING OF ALL EXISTING SIDEWALKS, CURBS, STREET PAVEMENT, TREES, BRICK PAVERS, AND SHRUBBERY DAMAGED DURING THE COURSE OF THIS PROJECT AND WITHIN THE FULL LIMITATIONS OF THE PROJECT.
 IT WILL BE THE CONTRACTORS RESPONSIBILITY TO ENSURE THAT ALL METHODS AVAILABLE HAVE BEEN TAKEN TO PROTECT ALL THE AFOREMENTIONED ENTITIES BEFORE CONSTRUCTION WORK BEGINS.
 IF AT ANY TIME DURING SAID CONSTRUCTION, THE CITY ENGINEER OR HIS REPRESENTATIVE DEEM THAT ANY AND/OR ALL PORTIONS OF SIDEWALK, CURB PAVEMENT AND/OR ANY OTHER APPURTENANCES HAVE BEEN DAMAGED BY EITHER THE GENERAL CONTRACTOR OR ANY OF HIS SUB-CONTRACTORS, IT WILL BE THE RESPONSIBILITY OF THE GENERAL CONTRACTOR TO MAKE ALL REPAIRS AND/OR CORRECTIONS TO SAID AREAS WITHOUT ANY COST TO THE CITY OF ALBANY.

PERMIT REQUIREMENTS:
 THE GENERAL CONTRACTOR, PRIOR TO BEGINNING ANY WORK ON SAID PROJECT, WILL PROCURE THE FOLLOWING PERMITS WHERE APPLICABLE:
 *ENGINEERING DEPARTMENT *DEPARTMENT OF GENERAL SERVICES
 *GRADING AND MINING *CURB CUT APPLICATION
 *SANITARY/STORM SEWER *SIDEWALK/CURB RESTORATION
 *RETAINING WALL *STREET RESTORATION
 *WATER DEPARTMENT *WATER SERVICE

THE CONTRACTOR WILL NOTIFY THE ENGINEERING DEPARTMENT FORTY-EIGHT (48) HOURS PRIOR TO PERFORMING ALL UTILITY OR SITE RESTORATION WORK. FAILURE TO NOTIFY THE ENGINEERING DEPARTMENT BEFORE BEGINNING WORK COULD RESULT IN A ONE HUNDRED DOLLAR (\$100.00) FINE FOR EACH DAY THE OFFENSE OCCURS.

THE CONTRACTOR WILL NOTIFY THE DEPARTMENT OF WATER AND WATER SUPPLY FORTY-EIGHT (48) HOURS PRIOR TO SCHEDULE AN INSPECTION FOR WATER, SANITARY AND STORM UTILITY WORK.

INTERIOR GROSS AREA		
EXISTING BUILDING IGA:	6058 SF	
NEW CONSTRUCTION IGA:	6058 SF	
	AREA (NET)	%
KITCHEN	3486 SF	61%
STORAGE	538 SF	9%
DRY GOODS AREA	69 SF	1%
RECEPTION	168 SF	3%
LOBBY	177 SF	3%
RESTROOM	94 SF	2%
EMPLOYEE SPACE	23 SF	0%
UTILITY	309 SF	5%
CIRCULATION	814 SF	14%
NET AREA TOTAL	5677 SF	

"JOE'S GRILL"
 2 STORY WOODEN RESTAURANT
 No.1044 CENTRAL AVENUE
 TAX MAP No. 53.66-1-33
 LANDS N/F OF BARBAGALLO JR., EDWIN J. BARBAGALLO, ANNE MARIE L.2857 P.172

No.1048 CENTRAL AVENUE
 TAX MAP No. 53.66-1-34
 LANDS N/F OF SPINELLI, ROCCO F. SPINELLI, KATHLEEN M. L.3079 P.1025
 Land Area= 12,510 S.F.
 0.29 Acres

No.2 FROST PLACE
 TAX MAP No. 53.66-1-9
 LANDS N/F OF ALL, FYRIAL NISSA
 INSTRUMENT No.R2017-18759

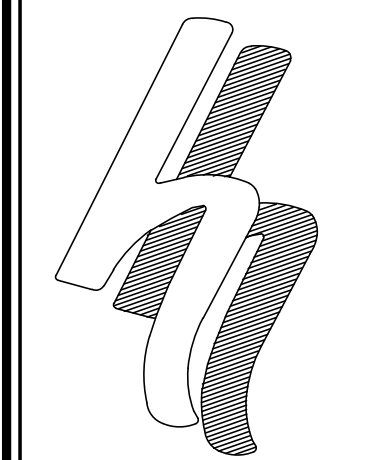
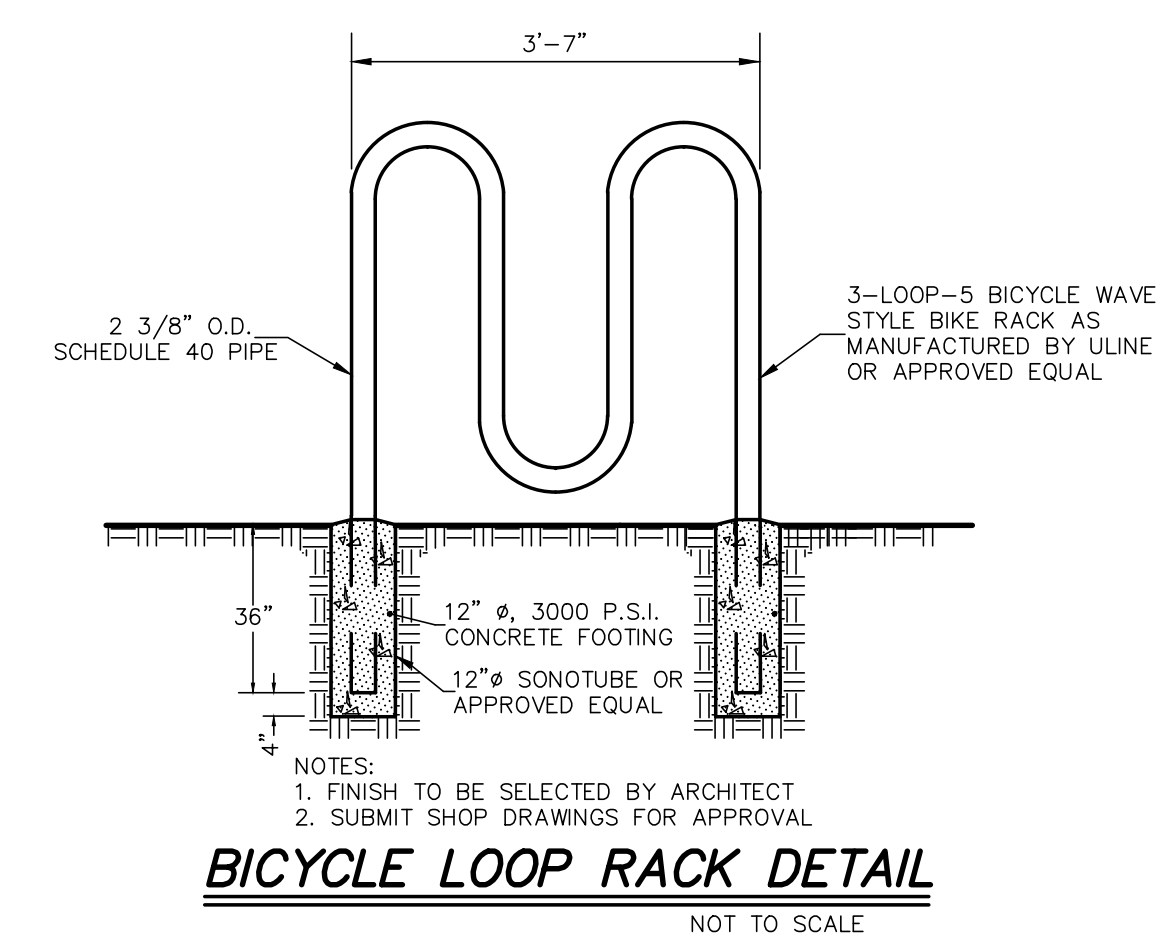
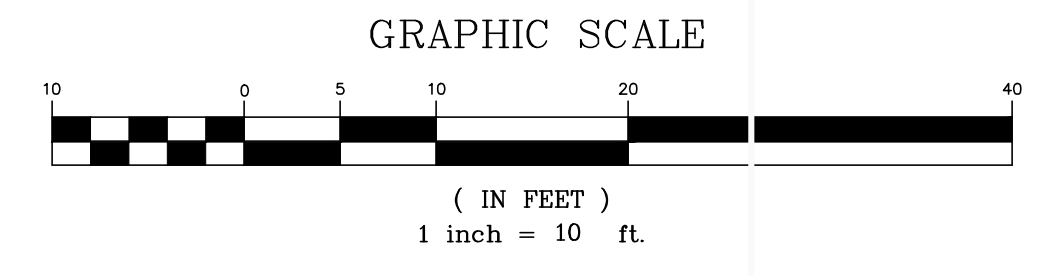

HERSHBERG & HERSHBERG
 Consulting Engineers and Land Surveyors
 18 Locust Street
 Albany, New York 12203

ALTERATION OF THIS DOCUMENT EXCEPT BY A LICENSED PROFESSIONAL ENGINEER OR LAND SURVEYOR, IS ILLEGAL.

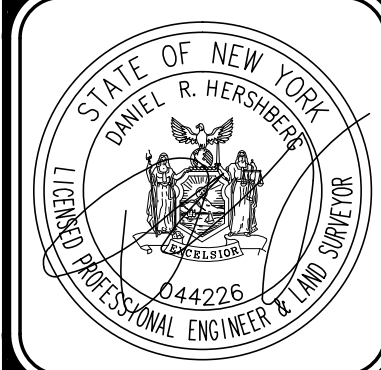

REVISIONS	DATE	REMARKS
GENERAL UPDATES	12/14/21	
COMMENT REVISIONS	1/20/22	
TRUCK ROUTING PLAN	2/17/22	

SITE PLAN FOR 1048 CENTRAL AVENUE
 CITY OF ALBANY, COUNTY OF ALBANY, STATE OF NEW YORK

DATE: 11-04-2021
 BY: TMD
 CHK: DRH
 SCALE: 1"=30'
 FILE: 2021-0002
 210002-1.DWG



LEGEND

- - - - - INGRESS ROUTE
- - - - - EGRESS ROUTE

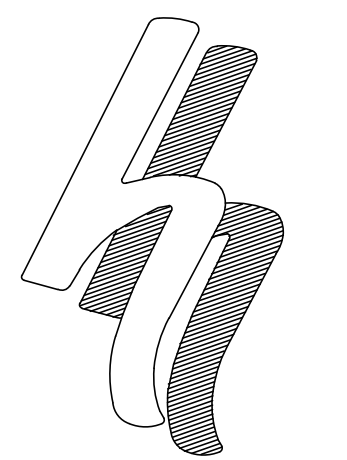
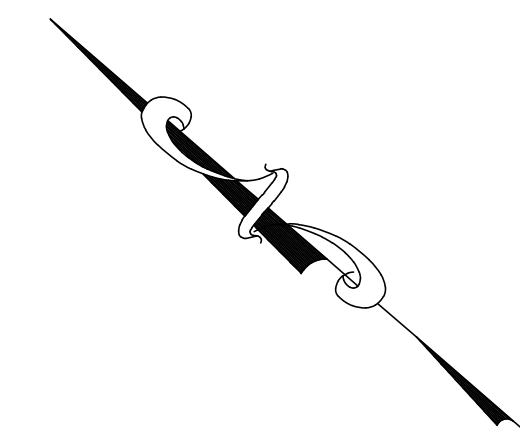
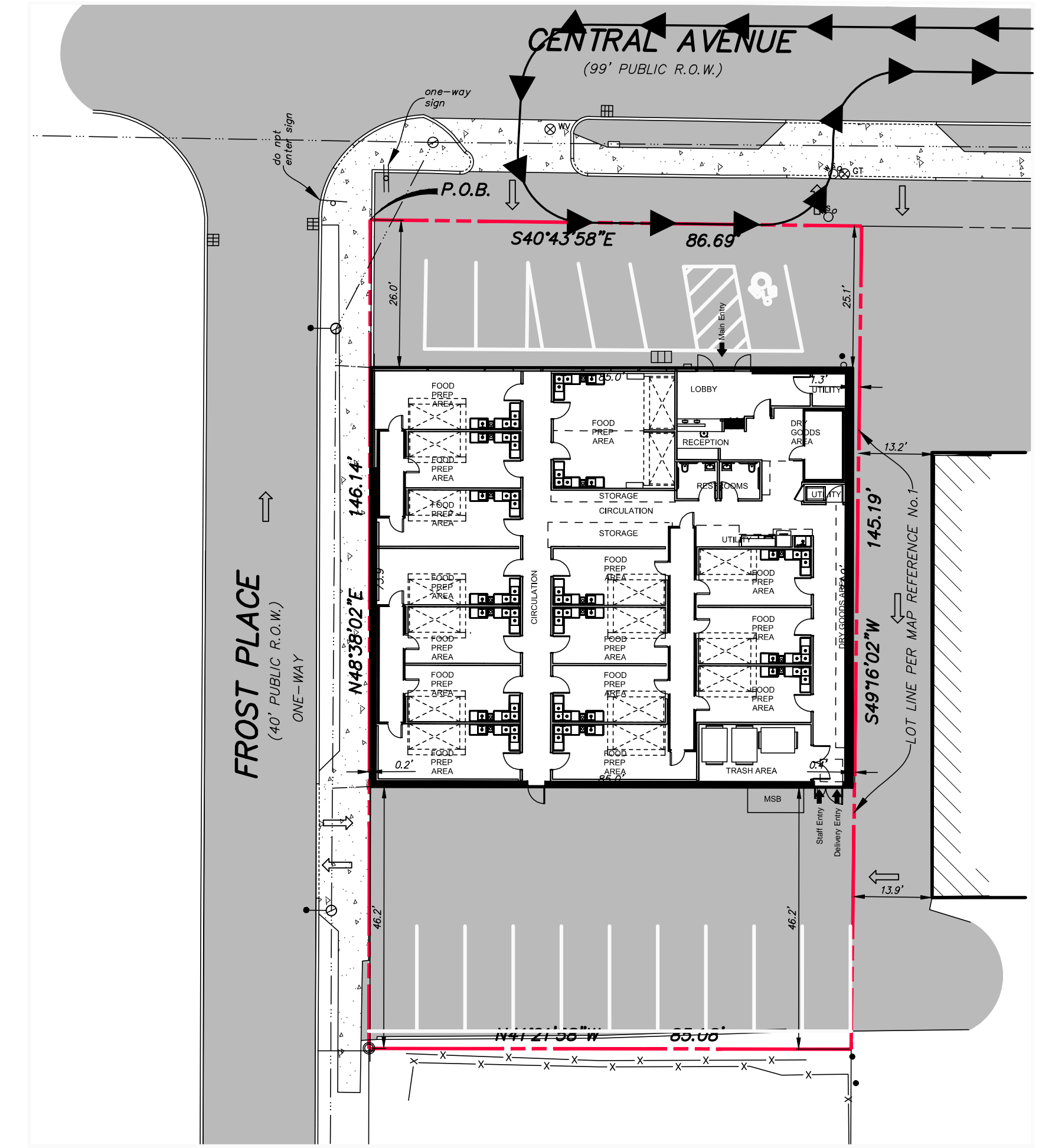
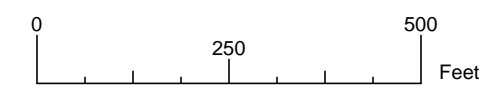

HERSHBERG & HERSHBERG
 Consulting Engineers
 and Land Surveyors
 18 Locust Street
 Albany, New York 12203

ALTERATION OF THIS DOCUMENT EXCEPT BY A LICENSED PROFESSIONAL ENGINEER OR LAND SURVEYOR IS ILLEGAL

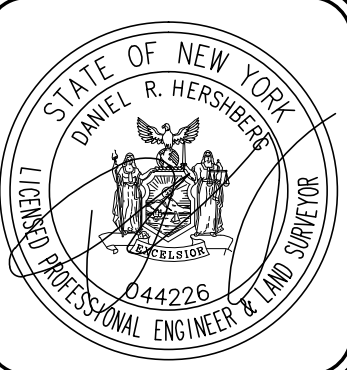

REMARKS	DATE
GENERAL UPDATES	12/14/21
COMMENT REVISIONS	1/20/22
TRUCK ROUTING PLAN	2/17/22

**TRUCK ROUTING PLAN FOR
 1048 CENTRAL AVENUE
 CITY OF ALBANY, COUNTY OF ALBANY,
 STATE OF NEW YORK**

SCALE: AS NOTED
 BY: TMO
 CHK: DRH
 DATE: 11-04-2021
 FILE: 2021-0002
 210002-1.DWG