

ELECTRICAL NOTES:

ALL ELECTRICAL WORK SHALL BE IN ACCORDANCE WITH THE LATEST EDITION OF THE N.E.C. AND INSPECTED BY THE NYS BOARD OF FIRE UNDERWRITERS

NOTE: EXHAUST FAN DUCTS TO GO THRU ROOF OR A LOCATION APPROVED BY ALBANY'S HRC.

BATHROOM EXHAUST FANS:
NUTONE # QTXEN150FLT
80 CFM, ENERGY STAR,
3" DIA. GALV. STEEL DUCT
MIN. R-4 INSULATED,
WALL CAP w/ DAMPER
(2) 18W HIGH EFFICIENCY GU24
FLUORESCENT BULBS
INSTALL ON GFCI CIRCUIT



NEW FIRST FLOOR PLAN

SCALE: 1/4"=1'-0"

NOTE: CARBON MONOXIDE DETECTORS MUST BE WITHIN 15 FEET OF SLEEPING ROOMS.

RENOVATION OF:
336 CLINTON AVE., ALBANY, NY
KEITH CRAMER, ARCHITECT (518) 438-8352
cramerkeith@msn.com
95 HURST AVE. ALBANY, NY 12208
SH. NO. 5 OF: 8 DATE: JAN. 5, 2021

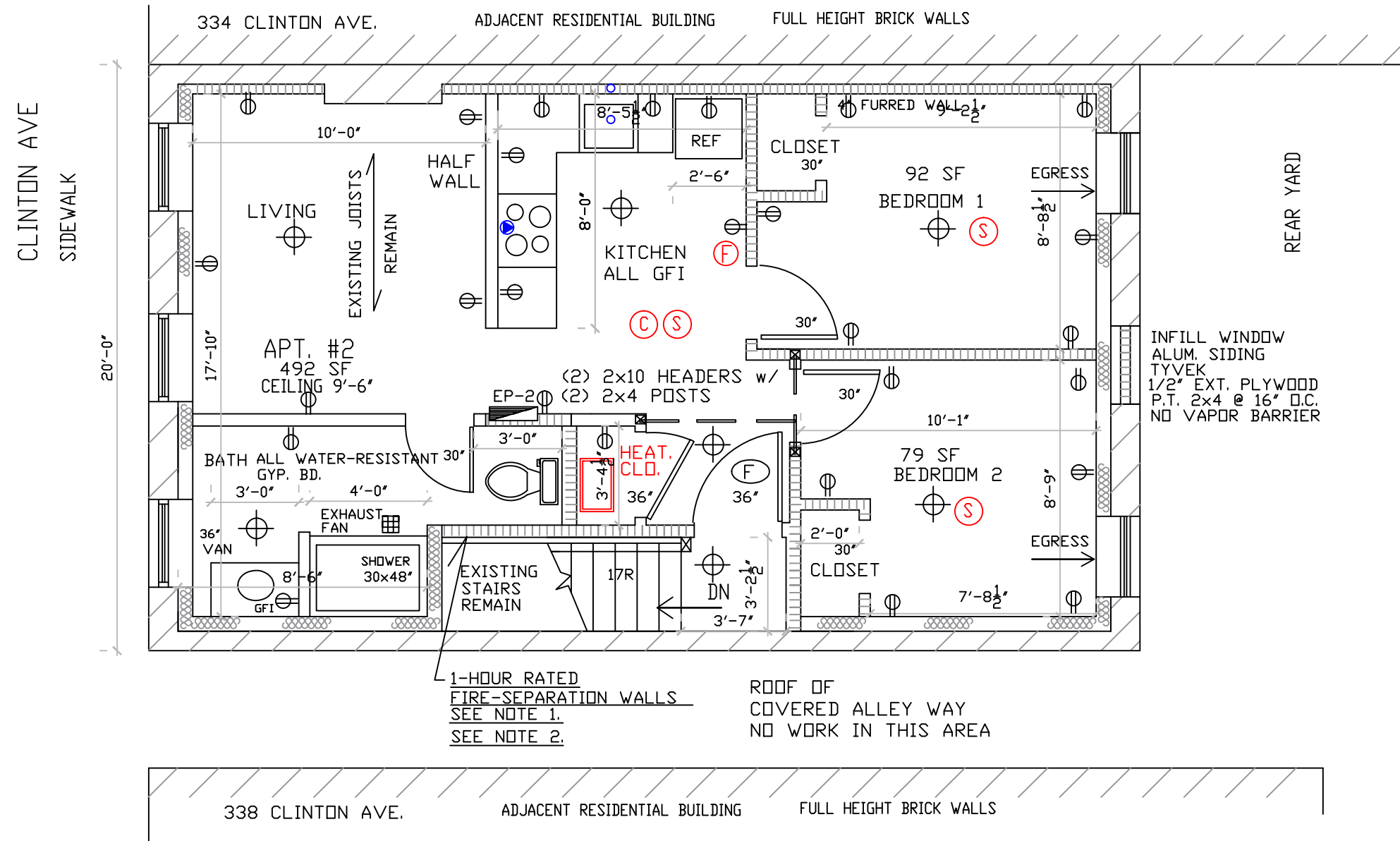

NEW ATTIC INSULATION: R-49 FIBERGLASS
OVER 3-MIL POLY VAPOR BARRIER
REPAIR EXISTING ATTIC VENTS, NEW INSECT SCREENS

NOTE: ALL RECESSED CEILING LIGHTS BETWEEN APARTMENTS SHALL BE 1-HOUR FIRE-RATED; WITH MANUFACTURERS LIGHT HOUSING; SEPARATE 'DOME' ENCLOSURE; OR SITE-BUILT 5/8" TYPE X FIRE-CODE GYP. BD. BOX, FULLY SEALED WITH 1-HOUR RATED FIRE SEALANT/CAULK.

NOTE: ON TOP FLOOR, AVOID RECESSED CEILING LIGHTS.
INSTALL WALL LIGHTS WHEREVER PRACTICAL.

TOP FLOOR CEILING LIGHTS- RECESSED LIGHTING INSTALLED IN THE THERMAL ENVELOPE SHALL BE SEALED TO LIMIT AIR LEAKAGE. ALL RECESSED LUMINAIRES SHALL BE IC-RATED AND LABELED AS HAVING AN AIR LEAKAGE RATE NOT MORE THAN 2.0 CFM AND SHALL BE SEALED WITH A GASKET OR CAULK BETWEEN THE HOUSING AND INTERIOR WALL OR COVERING.

BEDROOMS MUST HAVE (1) EGRESS WINDOW
SIZED TO CURRENT NYS RESIDENTIAL CODE
MIN. NET CLEAR OPENING AREA: 5.7 SF
GRADE FLOOR: 5 SF NET CLEAR OPENING
MIN. NET CLEAR OPENING HEIGHT: 24 IN.
MIN. NET CLEAR OPENING WIDTH: 20 IN.

NOTE: IF WINDOW OPENINGS NEED
TO BE WIDENED, ADD STEEL ANGLE TO
SUPPORT BRICK, MIN. L3.5x3.5x1/4"



NEW SECOND FLOOR PLAN

SCALE: 1/4"=1'-0"

RENOVATION OF:
336 CLINTON AVE., ALBANY, NY
KEITH CRAMER, ARCHITECT (518) 438-8352
cramerkeith@msn.com
95 HURST AVE. ALBANY, NY 12208
SH. NO. 6 OF: 8 DATE: JAN. 5, 2021