

VICINITY MAP  
MAP NOT TO SCALE

LEGEND

R.O.W.	RIGHT OF WAY	□	MONUMENT
No.	NUMBER	○	IRON ROD
enc.	ENCROACHMENT	MH	MANHOLE
P.O.B.	POINT OF BEGINNING	⊞	CATCHBASIN
S.F.	SQUARE FEET	—	SIGN
N/F	NOW OR FORMERLY	—X—	FENCE LINE
R	RECORD	—+—	GUARD RAIL
M	MEASURED	—○—	OVERHEAD WIRE, UTILITY POLE & GUY WIRE
N	NORTH	↑	TRAFFIC FLOW ACCESS AREA
S	SOUTH	↓	WATER SHUT OFF
E	EAST	⊗	WATER VALVE
W	WEST	⊗	HYDRANT
tel.	TELEPHONE	⊗	GAS VALVE
elec.	ELECTRIC	○	STREET LIGHT
L	LIBER	☆	LIGHT POLE
P.	PAGE	●	CLEAN OUT
O	PARKING METER	●	VENT
ST	STORM LINE	▨	CONCRETE
S	SEWER LINE	▨	PAVEMENT
C	COMBINED SEWER LINE	▨	COBBLESTONE
W	WATER LINE	▨	STONE
G	GAS LINE		
UE	UNDERGROUND ELECTRIC		
T	UNDERGROUND TELEPHONE		

GENERAL NOTES

1. UNAUTHORIZED ALTERATION OR ADDITION TO A SURVEY MAP BEARING A LICENSED LAND SURVEYOR'S SEAL IS A VIOLATION OF SECTION 7209-2, OF THE NEW YORK STATE EDUCATION LAW.
2. ONLY COPIES FROM THE ORIGINAL OF THIS SURVEY MARKED WITH THE LAND SURVEYOR'S SIGNATURE AND AN ORIGINAL EMBOSSED OR INK SEAL SHALL BE CONSIDERED VALID TRUE COPIES.
3. THIS SURVEY WAS PREPARED FOR THE PARTIES AND PURPOSE INDICATED HEREON. ANY EXTENSION OF THE USE BEYOND THE PARTIES OR PURPOSE INDICATED IS EXPRESSLY FORBIDDEN WITHOUT WRITTEN RELEASE OR PERMISSION OF FRANCIS G. McCLOSKEY, LICENSE NO. 049441.
4. SUBSURFACE AND ENVIRONMENTAL CONDITIONS WERE NOT SURVEYED OR EXAMINED OR CONSIDERED AS PART OF THIS SURVEY.
5. THIS SURVEY MAP IS SUBJECT TO WHATEVER FACTS AN ACCURATE AND CURRENT ABSTRACT OF TITLE MAY SHOW.
6. SPOT ELEVATIONS AND CONTOURS ARE BASED ON NAVD83 DATUM.
7. UNDERGROUND UTILITIES SHOWN ARE TAKEN FROM FIELD LOCATION WHERE POSSIBLE AND FROM RECORD DATA. THEIR EXACT LOCATION IN THE FIELD MAY DIFFER FROM THAT SHOWN HEREIN AND ADDITIONAL UTILITIES MAY EXIST. CALL 800-487-7862 TO HAVE UTILITIES MARKED ON SITE PRIOR TO COMMENCEMENT OF CONSTRUCTION.

GRAPHIC SCALE

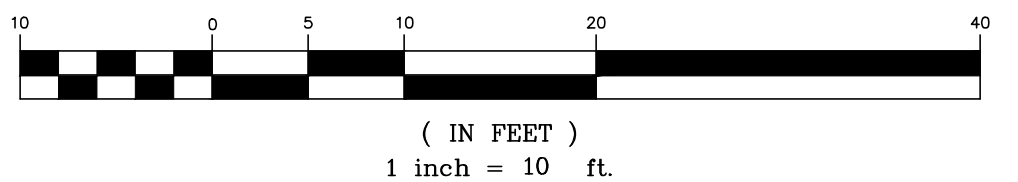

FOR MUNICIPAL APPROVAL ONLY-NOT INTENDED FOR CONSTRUCTION

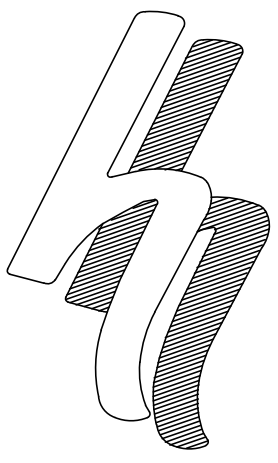

**HERSHBERG & HERSHBERG**

Consulting Engineers and Land Surveyors

18 Locust Street  
Albany, New York 12203

ALTERATION OF THIS DOCUMENT EXCEPT BY A LICENSED PROFESSIONAL ENGINEER OR LAND SURVEYOR, IS ILLEGAL

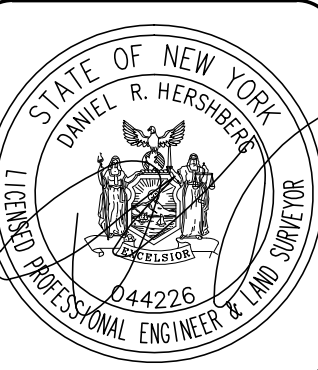

DATE	REVISIONS
8-27-2019	UTILITIES UPDATED
10-21-2019	GENERAL UPDATE
1-30-2020	BUILDING FOOTPRINT REVISED
5-18-2020	NEW BUILDING FOOTPRINT
6-23-2020	NEW BUILDING AND UTILITIES UPDATED

EXISTING CONDITIONS PLAN  
No. 67 LIVINGSTON AVENUE  
CITY OF ALBANY STATE OF NEW YORK

C1



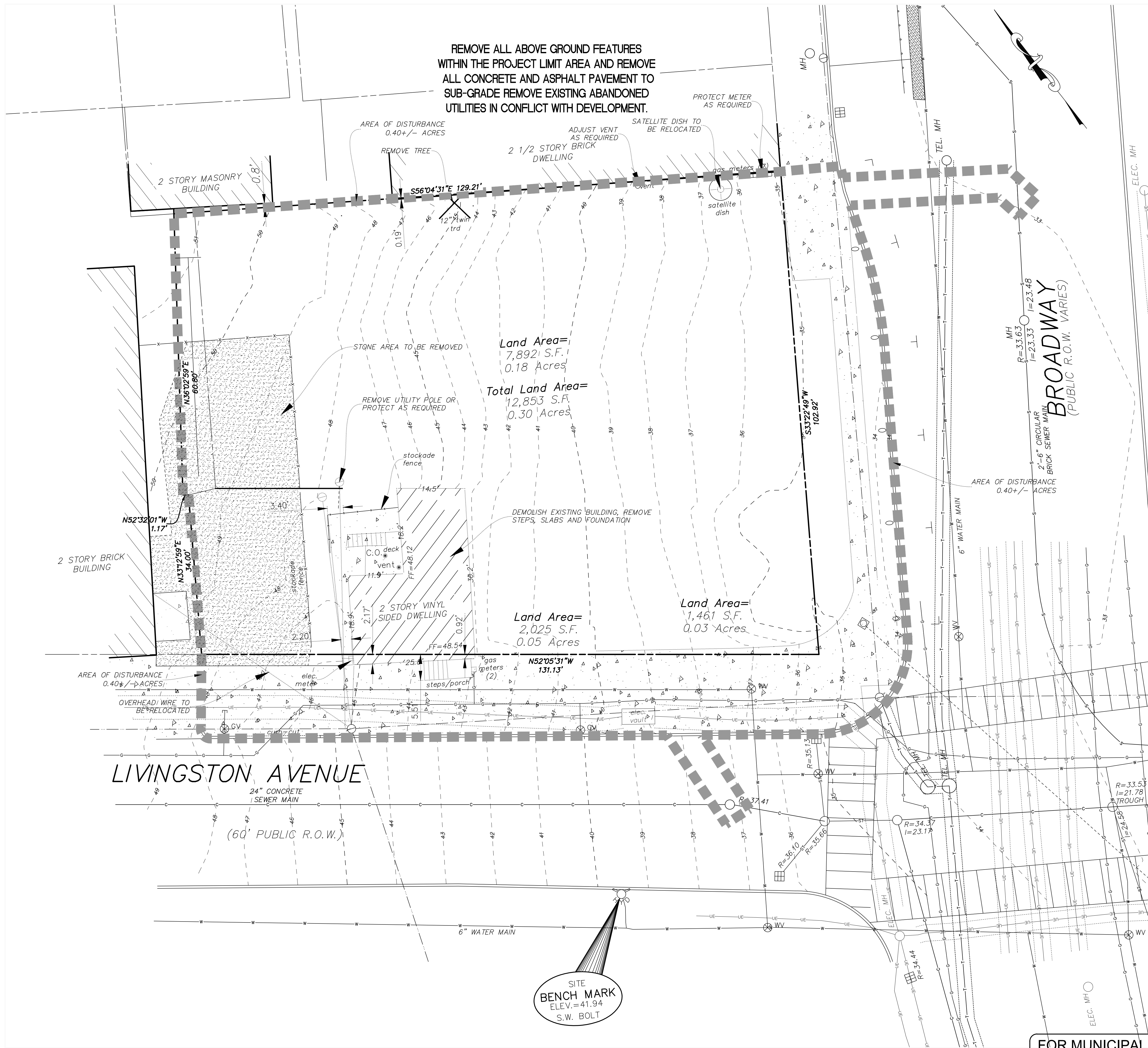

LEGEND

- EXISTING TREE TO BE REMOVED
- PROJECT LIMIT LINE
- EXISTING CONTOURS
- EXISTING WATER LINE  
RECORD LOCATION TAKEN FROM THE CITY OF ALBANY WATER ATLAS MAPS
- EXISTING STORM SEWER
- EXISTING SANITARY SEWER
- EXISTING GAS SERVICE
- EXISTING ELECTRICAL SERVICE
- EXISTING TELEPHONE/COMMUNICATION SERVICE
- EXISTING TREE TO REMAIN
- IRON PIPE FOUND
- EXISTING SIGN

DEMOLITION NOTES

- COORDINATE ALL REMOVALS WITH CONSTRUCTION SCHEDULE AND OWNER. MAINTAIN OPERATION OF EXISTING FACILITY THROUGHOUT CONSTRUCTION
- PRIOR TO DEMOLITION IDENTIFY AND PROTECT ALL STREET TREES TO REMAIN.
- ALL EXISTING WATER SERVICES AT THE MAIN AND SEWER LATERALS SHALL BE ABANDONED IN ACCORDANCE WITH THE CITY OF ALBANY. REMOVE, PLUG AND CAP AS REQUIRED BY THE CITY OF ALBANY.
- REMOVE, STORE AND PROTECT EXISTING GRANITE CURBING THAT WILL BE REUSED.
- VERIFY ALL UTILITIES WHICH HAVE BEEN ABANDONED ARE NOT ACTIVE. RECONNECT ANY ACTIVE UTILITY LINES FOUND.
- ALL EXISTING BUILDINGS TO BE DEMOLISHED SHALL HAVE THE FOUNDATIONS REMOVED IN THEIR ENTIRETY.
- PETROLEUM TANKS, OIL STORAGE TANKS, ETC SHALL BE REMOVED IN ACCORDANCE WITH LOCAL, STATE AND FEDERAL GUIDELINES.
- GRADING PERMIT REQUIRED. CONTACT PATRICK MCCUTCHEON, ENGINEERING DIVISION, CITY OF ALBANY AT 518-434-2387 FOR APPLICATION FORM. BOND WILL BE REQUIRED.
- STREET OPENING PERMITS ARE REQUIRED. CONTACT GARY BOHL, DEPARTMENT OF GENERAL SERVICES, CITY OF ALBANY AT 518-462-3519 FOR THE APPLICATION FORM.

NOTES

- LOCATIONS OF SEWER AND WATER LINES FOR BUILDINGS TO BE DEMOLISHED ARE UNKNOWN. LOCATE IN FIELD.
- A FULL ENVIRONMENTAL REVIEW OF ALL BUILDINGS FOR LEAD AND ASBESTOS IS REQUIRED PRIOR TO DEMOLITION.

GRAPHIC SCALE

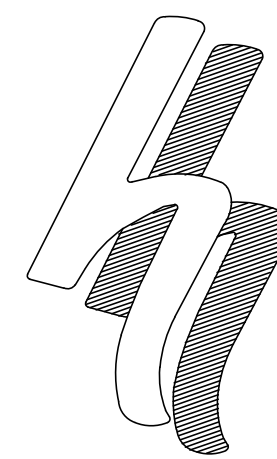
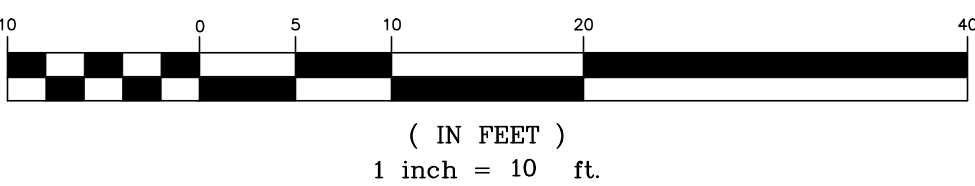

**HERSHBERG & HERSHBERG**  
Consulting Engineers  
and Land Surveyors

18 Locust Street  
Albany, New York 12203

ALTERATION OF THIS  
DOCUMENT EXCEPT BY A  
LICENSED PROFESSIONAL  
ENGINEER OR LAND  
SURVEYOR, IS ILLEGAL



DATE	REVISIONS
8-27-2019	UTILITIES UPDATED
10-21-2019	GENERAL UPDATE
1-30-2020	BUILDING FOOTPRINT REVISED
5-18-2020	NEW BUILDING FOOTPRINT

DEMOLITION PLAN  
No. 67 LIVINGSTON AVENUE  
CITY OF ALBANY STATE OF NEW YORK

FILE: 180196 DATE: 7-29-2019 CHK: DRH GY: SAC SCALE: 1"=10' 180196-LONG

C2

FOR MUNICIPAL APPROVAL ONLY-NOT INTENDED FOR CONSTRUCTION



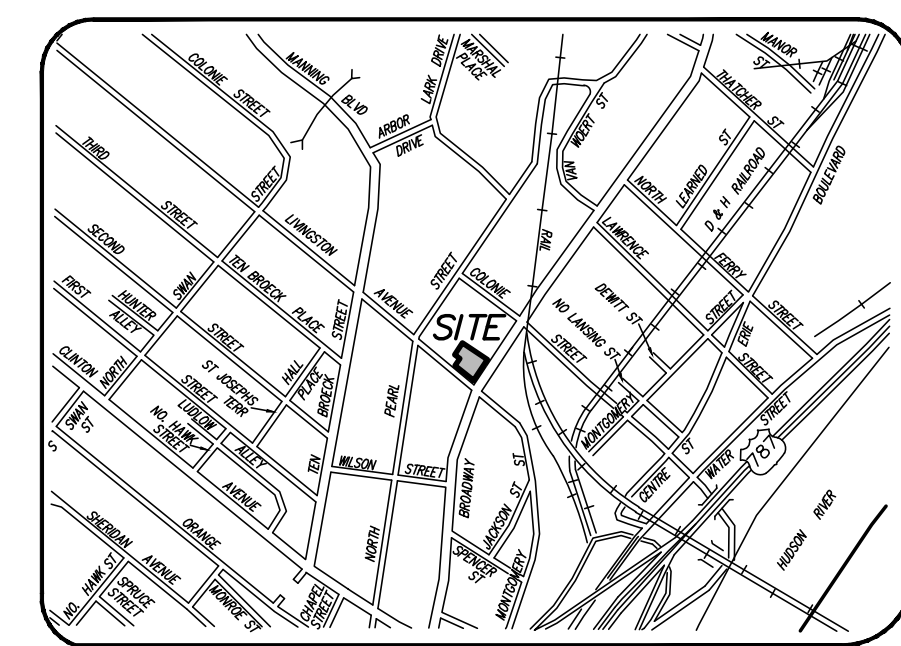
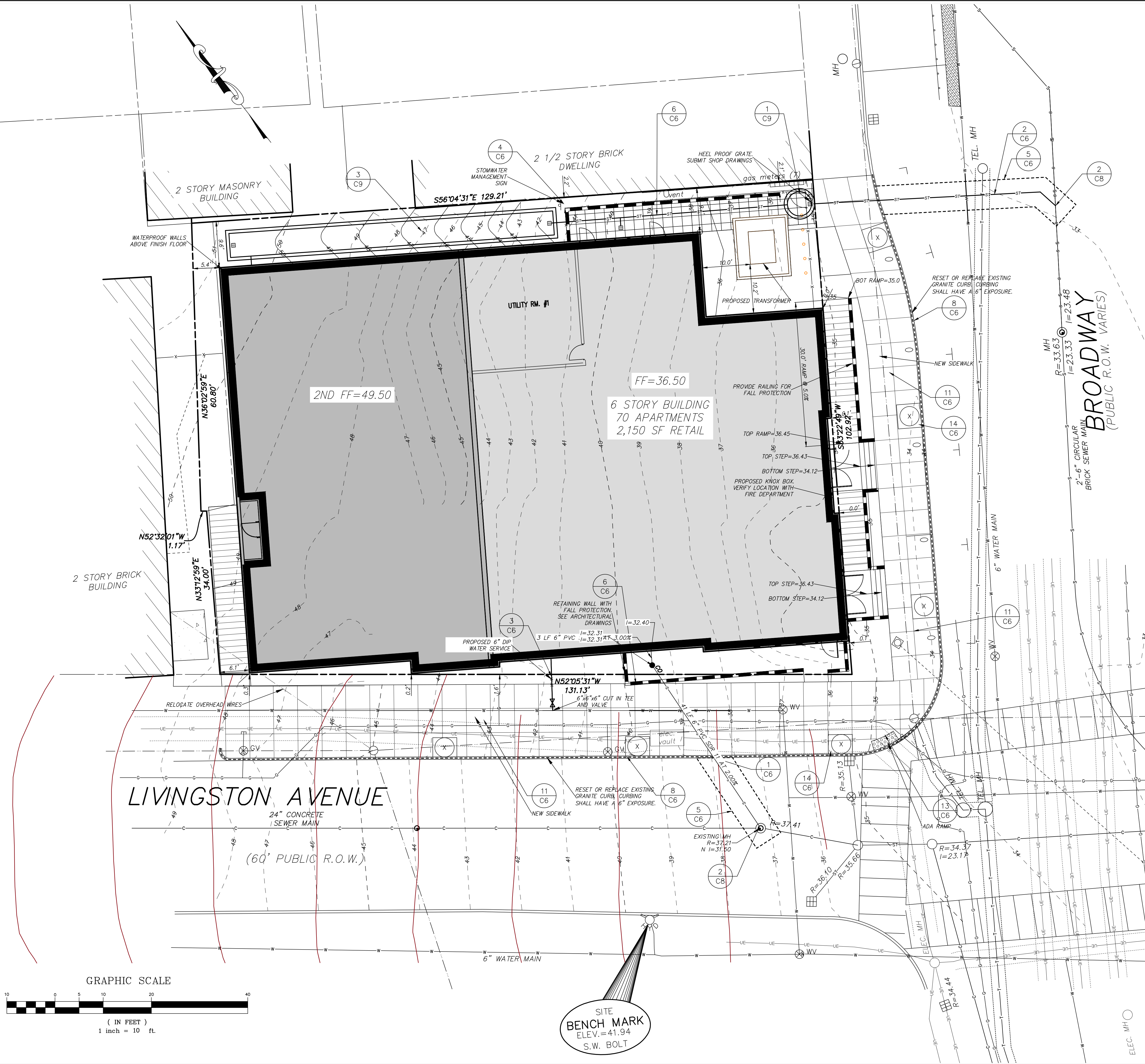

VICINITY MAP  
MAP NOT TO SCALE

LEGEND

R.O.W.	RIGHT OF WAY	□	MONUMENT
No.	NUMBER	○	IRON ROD
enc.	ENCROACHMENT	MH	MANHOLE
P.O.B.	POINT OF BEGINNING	⊞	CATCH-BASIN
S.F.	SQUARE FEET	—	SIGN
N/F	NOW OR FORMERLY	—X—	FENCE LINE
R	RECORD	—	GUARD RAIL
M	MEASURED	—	OVERHEAD WIRE, UTILITY POLE & GUY WIRE
N	NORTH	→	TRAFFIC FLOW ACCESS AREA
S	SOUTH	⊞	WATER SHUT OFF
E	EAST	⊞	WATER VALVE
W	WEST	⊞	HYDRANT
tel.	TELEPHONE	⊞	GAS VALVE
elec.	ELECTRIC	○	STREET LIGHT
L	LIBER	☆	LIGHT POLE
P.	PAGE	●	CLEAN OUT
O	PARKING METER	●	VENT
ST	STORM LINE		
S	SEWER LINE		
C	COMBINED SEWER LINE		
W	WATER LINE		
G	GAS LINE		
UE	UNDERGROUND ELECTRIC		
T	UNDERGROUND TELEPHONE		
-49	EXISTING GRADE		
-35	FINISHED GRADE		
		—	PROPOSED CURB
		—	PROPOSED SIDEWALK

GENERAL NOTES

1. GRADING PERMIT REQUIRED. CONTACT PATRICK MCCUTCHEON, ENGINEERING DIVISION, CITY OF ALBANY AT 518-434-2387 FOR APPLICATION FORM. BOND WILL BE REQUIRED.
2. STREET OPENING PERMITS ARE REQUIRED. CONTACT GARY BOHL, DEPARTMENT OF GENERAL SERVICES, CITY OF ALBANY AT 518-462-3519 FOR THE APPLICATION FORM.
3. PRIOR TO USE ALL WATER LINES MUST BE CHLORINATED AND HAVE A BACTERIOLOGICAL TEST PERFORMED IN ACCORDANCE WITH CITY OF ALBANY STANDARDS.
4. 48 HOURS NOTICE MUST BE GIVEN TO DEPARTMENT OF WATER FOR INSPECTIONS.
5. ALBANY WATER DEPARTMENT MUST TAP THEIR OWN MAINS.
6. PRESSURE AND LEAKAGE TESTING OF THE WATER MAIN SHALL BE WITNESSED BY DEPARTMENT STAFF AND ACCEPTABLE BACTERIOLOGICAL TEST MUST BE SUBMITTED AND ACCEPTED BY THE DEPARTMENT PRIOR TO FINAL OF THE NEW WATER MAIN.

EXISTING SITE COVERAGE STATISTICS

description	s.f.	acres	%
building area	699	0.02	5.4
green area	10,304	0.24	80.2
paved/conc area	1,850	0.04	14.4
total area	12,853	0.30	100.0

PROPOSED SITE COVERAGE STATISTICS

description	s.f.	acres	%
building area	10,234	0.24	79.6
green area	1,677	0.04	13.1
paved/conc area	942	0.02	7.3
total area	12,853	0.30	100.0

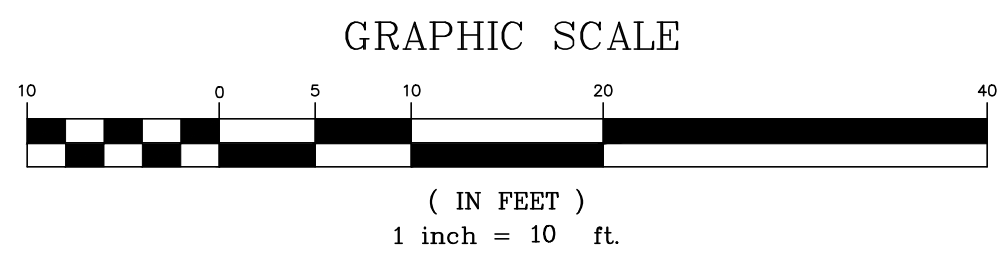

SITE BENCH MARK  
ELEV.=41.94  
S.W. BOLT

FOR MUNICIPAL APPROVAL ONLY-NOT INTENDED FOR CONSTRUCTION

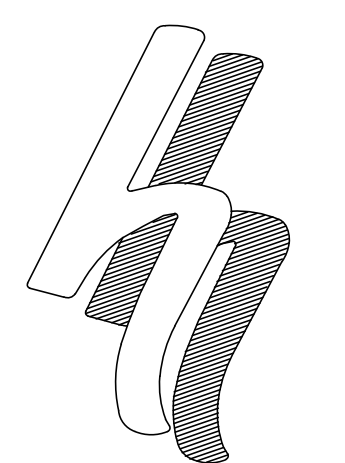

HERSHBERG & HERSHBERG  
Consulting Engineers and Land Surveyors

18 Locust Street  
Albany, New York 12203

ALTERATION OF THIS DOCUMENT EXCEPT BY A LICENSED PROFESSIONAL ENGINEER OR LAND SURVEYOR, IS ILLEGAL

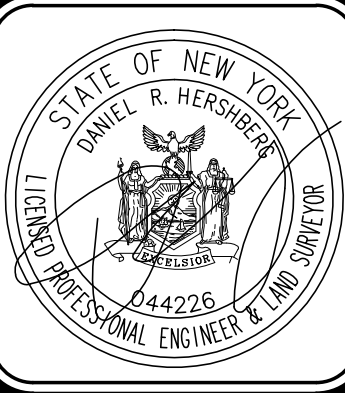

DATE	REMARKS
8-27-2019	UTILITIES UPDATED
10-21-2019	GENERAL UPDATE
1-30-2020	BUILDING FOOTPRINT REVISED
5-18-2020	NEW BUILDING FOOTPRINT
	REVISIONS

SITE PLAN  
No.67 LIVINGSTON AVENUE  
CITY OF ALBANY STATE OF NEW YORK

C3



# EROSION AND SEDIMENT CONTROL LEGEND

- 6' HIGH SECURITY FENCE
- PROPOSED SEDIMENT CONTROL FENCE
- JERSEY BARRIER WITH SECURITY FENCE ON TOP
- PROPOSED SEDIMENT CONTROL FENCE

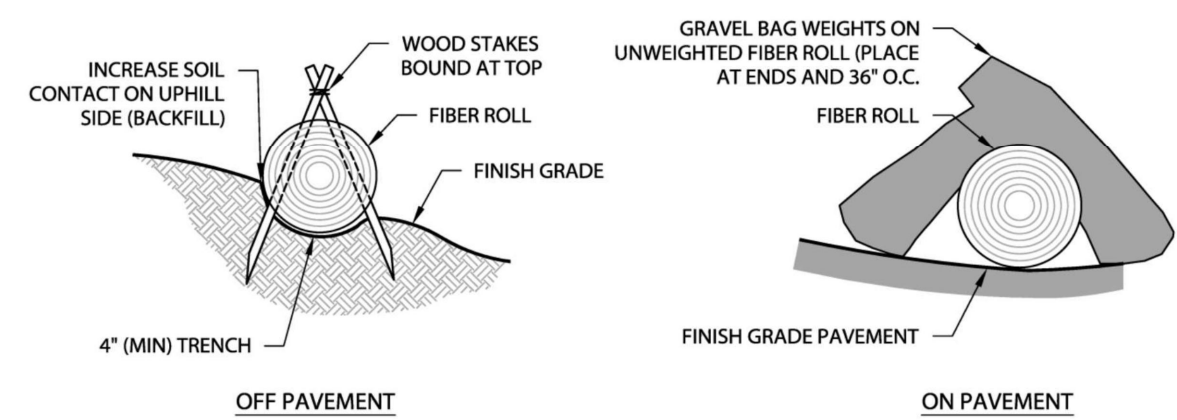

**FIBER ROLLS DETAIL**  
NOT TO SCALE

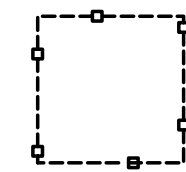

**PLAN VIEW**

**SILT SACK FOR CB DETAIL**  
NOT TO SCALE

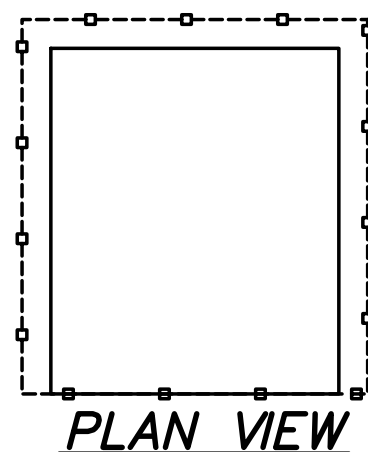

**PLAN VIEW**

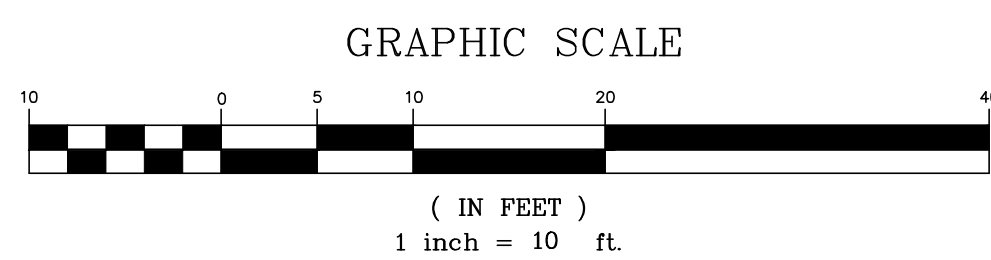
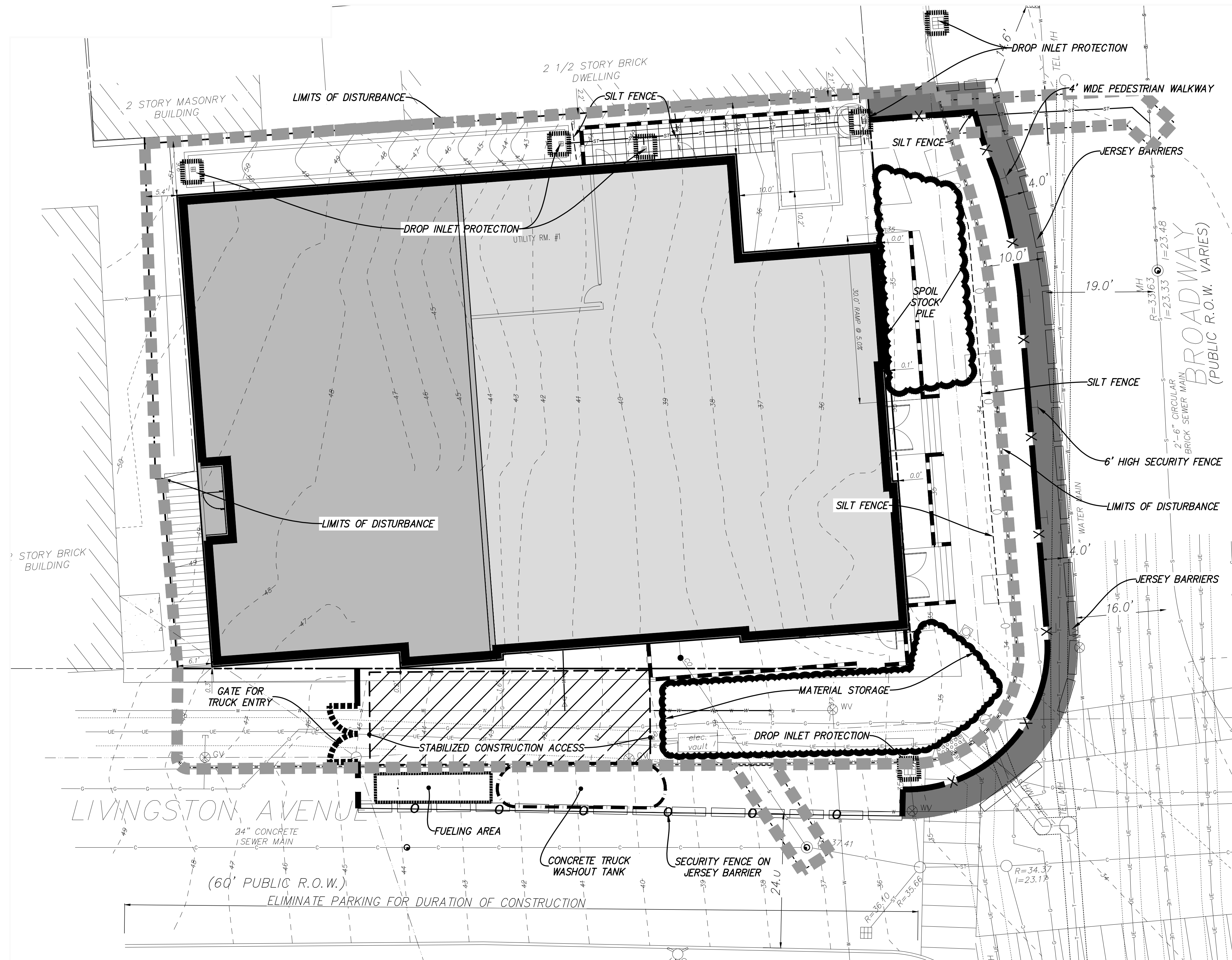

FOR MUNICIPAL APPROVAL ONLY-NOT INTENDED FOR CONSTRUCTION

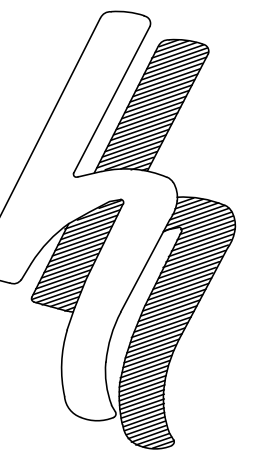

**HERSHBERG & HERSHBERG**  
Consulting Engineers and Land Surveyors  
18 Locust Street  
Albany, New York 12203

ALTERATION OF THIS DOCUMENT EXCEPT BY A LICENSED PROFESSIONAL ENGINEER OR LAND SURVEYOR, IS ILLEGAL

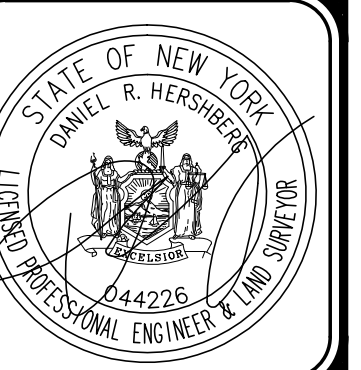

DATE	REVISIONS
8-27-2019	UTILITIES UPDATED
10-21-2019	GENERAL UPDATE
1-30-2020	BUILDING FOOTPRINT REVISED
5-18-2020	NEW BUILDING FOOTPRINT
6-23-2020	NEW BUILDING AND UTILITIES UPDATED

EROSION AND SEDIMENT CONTROL  
No.67 LIVINGSTON AVENUE  
CITY OF ALBANY STATE OF NEW YORK

FILE: 180196 SCALE: 1"=10' CHK: DRH DATE: 7-29-2019 BY: SAC

C4



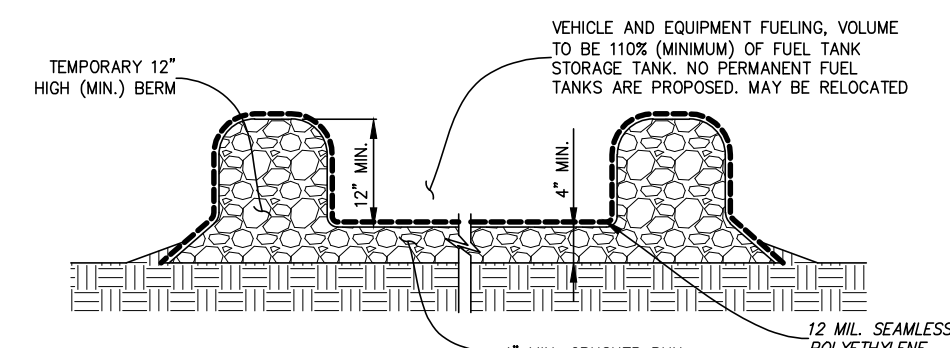

**VEHICLE AND EQUIPMENT FUELING DETAIL**  
NOT TO SCALE

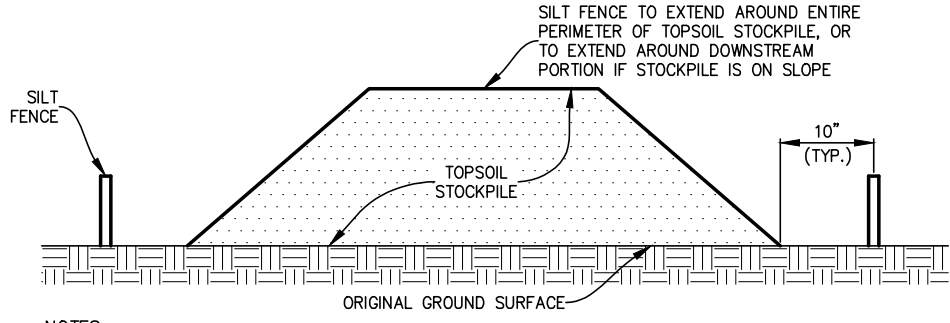

**TEMPORARY TOPSOIL STOCKPILE DETAIL**  
NOT TO SCALE

**EROSION AND SEDIMENT CONTROL NOTES**

1. ANY CONTRACTOR INVOLVED IN EARTHWORK ACTIVITIES, INCLUDING BUT NOT LIMITED TO: CLEARING, GRADING AND TRENCHING, SHALL REVIEW ALL PERMIT CONDITIONS AND CERTIFY UNDERSTANDING OF THESE CONDITIONS. IN WRITING, IT IS THE CONTRACTOR'S RESPONSIBILITY TO IMPLEMENT ALL EROSION CONTROLS DESCRIBED IN THE NEW YORK STATE EROSION AND SEDIMENT CONTROL MANUAL DATED JULY 2016, AND IT IS NOT THE INTENT OF THESE DRAWINGS TO REPLACE OR DISSEMINATE THE PERMIT REQUIREMENTS. THE CONTRACTOR SHALL REMAIN IN COMPLIANCE WITH THE PERMIT AT ALL TIMES.
2. AT ALL TIMES SOIL DISTURBING ACTIVITIES SHALL REMAIN LESS THAN 1 ACRE. THE CONTRACTOR SHALL COORDINATE EARTHWORK ACTIVITIES AND IMPLEMENTATION OF SOIL STABILIZATION MEASURES TO ENSURE COMPLIANCE TO THIS PERMIT REQUIREMENT. THE SITE WILL BE MONITORED AT ALL TIMES TO ENSURE SOIL DISTURBANCE DOES NOT EXCEED 1 ACRE. IF THE SOIL DISTURBANCE EXCEEDS ONE ACRE AT ANY TIME, A STOP WORK ORDER WILL ISSUED UNTIL THE SITE RECEIVES COVERAGE UNDER SPDES GENERAL PERMIT FOR CONSTRUCTION ACTIVITY.
3. THE CONTRACTOR SHALL MAINTAIN A CLEAN CONSTRUCTION AND EQUIPMENT ENTRANCE WHENEVER PRACTICABLE.
4. DISTURBED AREAS SHALL BE STABILIZED WITHIN 14 DAYS OF COMPLETION OR SUSPENSION OF GRADING OPERATIONS.
5. INSTALL TEMPORARY & PERMANENT SEEDING IN ACCORDANCE WITH THE NEW YORK GUIDELINES FOR URBAN EROSION AND SEDIMENT CONTROL. STANDARD AND SPECIFICATION FOR TEMPORARY CONSTRUCTION AREA SEEDING AND FOR MULCHING.

STANDARD AND SPECIFICATIONS FOR TEMPORARY CONSTRUCTION AREA PLANTINGS, PAGE 4-58.  
WATER MANAGEMENT PRACTICES MUST BE INSTALLED AS APPROPRIATE FOR SITE CONDITIONS. THE AREA MUST BE ROUGH GRADED AND SLOPES PHYSICALLY STABLE. LARGE DEBRIS AND ROCKS ARE USUALLY SEEDING MUST BE SEEDD WITHIN 24 HOURS OF DISTURBANCE OR SCARIFICATION OF THE SOIL SURFACE WILL BE NECESSARY PRIOR TO SEEDING.

FERTILIZER OR LIME ARE NOT TYPICALLY USED FOR TEMPORARY SEEDINGS.

IF: SPRING OR SUMMER OR EARLY FALL, THEN SEED THE AREA WITH RYEGRASS (ANNUAL OR PERENNIAL) AT 30 LBS. PER ACRE. (APPROXIMATELY 0.7 LB./1000 SQ. FT. OR USE 1 LB./1000 SQ. FT.)

IF: LATE FALL OR EARLY WINTER, THEN SEED CERTIFIED "ARROSTOCK" WINTER RYE (CEREAL RYE) AT 1000 LBS. PER ACRE (2.5 LBS./1000 SQ. FT.).

ANY SEEDING METHOD MAY BE USED THAT WILL PROVIDE UNIFORM APPLICATION OF SEED TO THE AREA AND RESULT IN RELATIVELY GOOD SOIL TO SEED CONTACT.

MULCH THE AREA WITH HAY OR STRAW AT 2 TONS/ACRE (APPROX. 90 LBS./1000 SQ. FT. OR 2 BALES). QUALITY OF HAY OR STRAW MULCH ALLOWABLE WILL BE DETERMINED BASED ON LONG TERM USE AND VISUAL CONCERNS. MULCH ANCHORING WILL BE REQUIRED WHERE WIND OR AREAS OF CONCENTRATED WATER ARE OF CONCERN. WOOD FIBER HYDROMULCH OR OTHER SPRAYABLE PRODUCTS APPROVED FOR EROSION CONTROL (NYLON WEB OR MESH) MAY BE USED IF APPLIED ACCORDING TO MANUFACTURERS' SPECIFICATIONS. CAUTION IS ADVISED WHEN USING NYLON OR OTHER SYNTHETIC PRODUCTS; THEY MAY BE DIFFICULT TO REMOVE PRIOR TO FINAL SEEDING AND CAN BE A HAZARD TO YOUNG WILDLIFE SPECIES.

MULCH ANCHORING GUIDE - TABLE 4.3, PAGE 4-41.

MULCH ANCHORING GUIDE		
ANCHORING METHOD OR MATERIAL	KIND OF MULCH TO BE ANCHORED	HOW TO APPLY
PEG AND TWINE	HAY OR STRAW	AFTER MULCHING, DIVIDE AREAS INTO BLOCKS APPROXIMATELY 1 SO. YD. IN SIZE. DRIVE 4-6 PEGS PER BLOCK TO WITHIN 2" TO 3" OF SOIL SURFACE. SECURE MULCH TO SURFACE BY STRETCHING TWINE BETWEEN PEGS IN CRISS-CROSS PATTERN ON SECURE TWINE AROUND EACH PEG WITH 2 OR MORE TIGHT TURNS. DRIVE PEGS FLUSH WITH SOIL, DRIVING STAKES INTO GROUND TIGHTLYNS THE TWINE.
MULCH NETTING	HAY OR STRAW	STAPLE THE LIGHT-WEIGHT PAPER, JUTE, WOOD FIBER, OR PLASTIC NETTINGS TO SOIL SURFACE ACCORDING TO MANUFACTURER'S RECOMMENDATIONS. SHOULD BE BIODEGRADABLE. MOST PRODUCTS ARE NOT SUITABLE FOR FOOT TRAFFIC.
WOOD CELLULOSE FIBER	HAY OR STRAW	APPLY WITH HYDROSEEDER IMMEDIATELY AFTER MULCHING. USE 500 LBS. WOOD FIBER PER ACRE. SOME PRODUCTS CONTAIN AN ADHESIVE MATERIAL ("TACKIFIER"), POSSIBLY ADVANTAGEOUS.
MULCH ANCHORING TOOL	HAY OR STRAW	APPLY MULCH AND PULL A MULCH ANCHORING TOOL (BLUNT, STRAIGHT DISCS) OVER MULCH AS NEAR TO THE CONTOUR AS POSSIBLE. MULCH MATERIAL SHOULD BE "TUCKED" INTO SOIL SURFACE ABOUT 3".
TACKIFIER	HAY OR STRAW	MIX AND APPLY POLYMERIC AND GUM TACKIFIERS ACCORDING TO MANUFACTURER'S INSTRUCTIONS. AVOID APPLICATION DURING RAIN. A 24-HOUR CURING PERIOD AND A SOIL TEMPERATURE HIGHER THAN 45° FAHREHEIT ARE REQUIRED.

6. INSTALL PERMANENT RIP-RAP AT ALL PIPE END SECTIONS AT TIME OF INSTALLATION OF PIPE.
7. DURING EXCAVATION OF TEMPORARY SEDIMENT BASIN, FIELD VERIFY A MINIMUM OF 2' SEPARATION DISTANCE FROM GROUND WATER ELEVATION TO SURFACE SAND FILTERS WITH AN IMPERMEABLE BOTTOM AND 3' WITH A PERMEABLE BOTTOM. NOTIFY ENGINEER IMMEDIATELY IF THESE MINIMUM SEPARATION REQUIREMENTS DO NOT EXIST FOR ALTERNATIVE MEANS OF STORMWATER POLLUTION PREVENTION.
8. SEE REMAINDER OF PLANS FOR PERMANENT IMPROVEMENTS. PERMANENT IMPROVEMENTS SHOWN ON THIS PLAN ARE FOR REFERENCE ONLY.
9. PAVED AREAS ARE TO BE SWEEP DAILY TO REMOVE ANY SEDIMENT AND ALL NEWLY PAVED AREAS SHALL BE DIRECTED TO THE TEMPORARY OR FINAL SEDIMENT CONTROL BASINS.

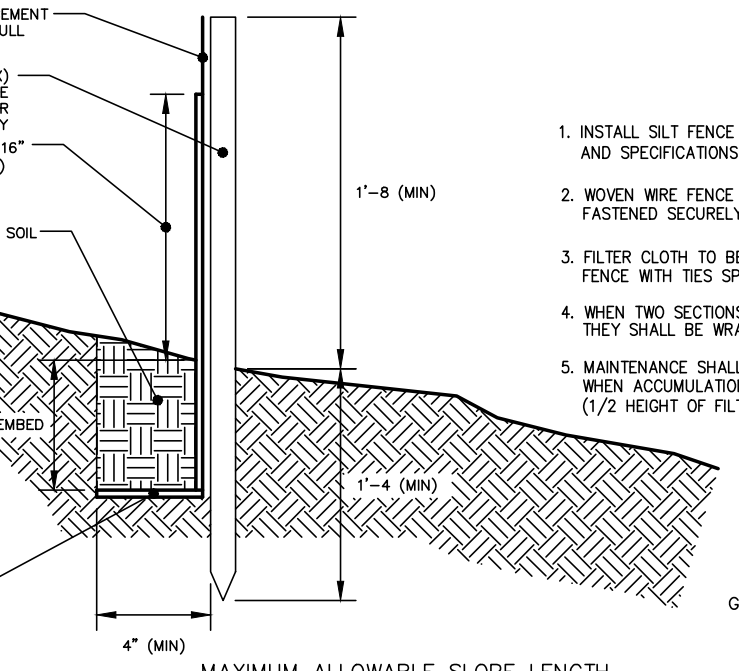

**CONSTRUCTION NOTES FOR FABRICATED SILT FENCE**

1. INSTALL SILT FENCE IN ACCORDANCE WITH THE "NEW YORK STANDARDS AND SPECIFICATIONS FOR EROSION AND SEDIMENT CONTROL", SECTION 7A.
2. WOVEN WIRE FENCE SHALL BE 12 1/2 GA., 6" MAXIMUM MESH OPENING, FASTENED SECURELY TO FENCE POSTS WITH WIRE TIES OR STAPLES.
3. FILTER CLOTH TO BE FASTENED SECURELY TO WOVEN WIRE FENCE WITH TIES SPACED EVERY 24" AT TOP AND MID SECTION.
4. WHEN TWO SECTIONS OF FILTER CLOTH ADJOIN EACH OTHER THEY SHALL BE WRAPPED TOGETHER PER SILT FENCE JOINT DETAIL ON THIS PAGE.
5. MAINTENANCE SHALL BE PERFORMED AS NEEDED AND SEDIMENT REMOVED WHEN ACCUMULATION REACHES 1/2 OF EROSION CAPACITY OF FENCE (1/2 HEIGHT OF FILTER FABRIC) OR WHEN "BULGES" DEVELOP IN FENCING.

POSTS: STEEL EITHER "T" OR "U" TYPE OR 2" HARDWOOD  
FENCE: WOVEN WIRE, 12 1/2 GA. 6" MAX. MESH OPENING  
FILTER CLOTH: FILTER X, MIRAFI 100X, STABILINKA T140N OR APPROVED EQUAL.  
PREFABRICATED UNIT: GEOTAB, ENVIROFENCE, OR APPROVED EQUAL.



**SILT FENCE JOINT DETAIL**  
NOT TO SCALE

**TEMPORARY EROSION AND SEDIMENT CONTROL NOTES**

1. EROSION AND SEDIMENT CONTROL MEASURES SHALL BE IMPLEMENTED IN ACCORDANCE WITH THE LATEST EDITION OF "NEW YORK STANDARDS AND SPECIFICATIONS FOR EROSION AND SEDIMENT CONTROL." (aka: THE BLUE BOOK) EROSION CONTROL DEVICES SHALL BE INSTALLED PRIOR TO ANY CONSTRUCTION ACTIVITIES.
2. IT IS THE INTENT OF THESE PLANS AND NOTES TO BE USED AS A GUIDE BY THE CONTRACTOR TO ENSURE THAT NO ERODED MATERIAL MIGRATES FROM THE SITE OR ENTERS ANY WATER COURSE. IT IS THE CONTRACTOR'S RESPONSIBILITY TO ENSURE THAT THIS GOAL IS MET, BY IMPLEMENTING THESE PLANS AND ANY ADDITIONAL MEANS THAT MAY BE NECESSARY. FURTHER MEASURES MAY BE REQUIRED BY THE CITY, VILLAGE, OR TOWN ENGINEER, WHILE MANY OF THE EROSION CONTROL DETAILS CONTAINED WITHIN THESE PLANS ARE TAKEN DIRECTLY FROM THE BLUE BOOK, THE CONTRACTOR SHOULD CONSIDER ANY OF THE DETAILS CONTAINED IN SECTION 7A OF THE BLUE BOOK AS ACCEPTABLE PRACTICE IN THE APPROPRIATE APPLICATION.
3. THE DEVELOPER/CONTRACTOR OR HIS BUILDER SHALL INSPECT AND MAINTAIN EROSION CONTROL MEASURES WEEKLY AND AFTER EACH RAINFALL EVENT THROUGH THE ENTIRE DEVELOPMENT PROCESS. TO ASSURE PROPER FUNCTION, SILTATION BARRIERS SHALL BE MAINTAINED IN GOOD CONDITION AND REINFORCED, EXTENDED, REPAIRED, RE-SEEDD AND PROTECTED FROM FURTHER EROSION. ALL SEDIMENT ACCUMULATED SHALL BE REMOVED AND CONTAINED IN APPROPRIATE SPILL AREAS. WATER SHALL BE APPLIED TO NEWLY SEEDD AREAS AS NEEDED UNTIL GRASS COVER IS WELL ESTABLISHED. DURING THESE PERIODIC INSPECTIONS, THE FOLLOWING ITEMS SHOULD BE PAID PARTICULAR ATTENTION:

- A. THE BASIN INLET LOCATIONS SHALL BE INSPECTED FOR SILT ACCUMULATION CAUSED BY THE LACK OF ESTABLISHED SURROUNDING VEGETATION.
- B. CATCH BASINS SHALL BE CHECKED FOR SEDIMENT ACCUMULATION.
- C. RIP-RAP OUTLET PROTECTION SHALL ALSO BE CHECKED FOR SEDIMENT ACCUMULATION. IF SIGNIFICANT AMOUNTS OF SEDIMENT ACCUMULATE, RIP-RAP SHALL BE REMOVED AND REPLACED.
- D. SILT FENCING SHALL BE INSPECTED REGULARLY FOR UNDERMINING AND DETERIORATION.
- E. SEEDD/MULCHED AREAS SHALL BE INSPECTED REGULARLY TO SEE THAT A GOOD STAND IS MAINTAINED. AREAS SHALL BE REPAIRED AS NECESSARY.

4. EROSION CONTROL DEVICES SHALL NOT BE REMOVED UNTIL THE CITY, VILLAGE OR TOWN ENGINEER HAS APPROVED FINAL STABILIZATION.
5. CHECK DAMS AND SILT FENCE SHALL BE INSTALLED IN ACCORDANCE WITH PLAN AND DETAIL LOCATIONS AND AS DESCRIBED IN GPO-010-01.
6. PRIOR TO CONSTRUCTION OF ANY PHASE, THE STABILIZED CONSTRUCTION ENTRANCES SHALL BE INSTALLED.
7. CONSTRUCTION TRAFFIC SHALL NOT CROSS STREAMS OR DITCHES EXCEPT AT SUITABLE CROSSING FACILITIES. EQUIPMENT SHALL NOT OPERATE, UNNECESSARILY.
8. EXISTING PAVEMENT AREAS SHALL BE CLEANED AT THE DIRECTION OF THE CITY, VILLAGE, OR TOWN ENGINEER.
9. WATER TRUCKS SHALL BE USED TO MINIMIZE DUST POLLUTION ON SITE, AND ON ADJACENT ROADWAY AREAS AS DIRECTED BY THE CITY, VILLAGE, OR TOWN ENGINEER.
10. ANY WATER PUMPED AS A RESULT OF DEWATERING ACTIVITIES SHALL BE PUMPED INTO A DEWATERING PIT.
11. CONCRETE WASHOUT AREAS SHALL BE DESIGNATED BY THE DEVELOPER OR CONTRACTOR AND PROTECTED IN ACCORDANCE WITH GPO-010-01.
12. ALL AREAS DISTURBED IN THE CONSTRUCTION PROCESS SHALL BE RE-SEEDD AS SOON AS PRACTICABLE. PARTICULAR CARE SHALL BE TAKEN TO RE-SEED DISTURBED SLOPES IN A TIMELY MANNER.
13. IT IS RECOMMENDED THAT ALL EROSION CONTROL DEVICES BE PLACED FOR THE ENTIRE PHASE AS SHOWN ON THE EROSION CONTROL PLAN. PLACEMENT MAY BE DONE, HOWEVER, TO SUIT CONSTRUCTION SEQUENCING AS APPROVED BY THE CITY, VILLAGE, OR TOWN ENGINEER.
14. STOCK PILES SHALL BE PROTECTED BY HAY BALE BERMS PER GPO-010-01. THESE BERMS SHALL BE MAINTAINED IN GOOD CONDITION UNTIL SAID STOCK PILES ARE REMOVED AND STOCK PILING AREAS ARE PERMANENTLY STABILIZED.
15. STOCK PILES SHALL BE SEEDD UPON SUSPENSION OF WORK OR IF MATERIAL IS NOT TO BE USED WITHIN 14 DAYS, IN ACCORDANCE WITH GPO-010-01.
16. IN NO CASE SHALL ERODIBLE MATERIALS BE STOCKPILED WITHIN 25 FEET OF ANY DITCH, STREAM OR OTHER SURFACE WATER BODY.
17. SILT FENCING SHALL BE INSTALLED AT THE DOWN GRADIENT PERIMETERS OF ALL SLOPES TO BE GRADED, PRIOR TO GRADING OPERATIONS.
18. SEDIMENT STILLING BASINS SHALL BE UTILIZED TO PREVENT OFF SITE EROSION.
19. THE STORMWATER DETENTION PONDS AND CUT-OFF SWALES SHALL BE COMPLETED PRIOR TO CONSTRUCTION OF ADJACENT AREAS.
20. WHERE NECESSARY, TEMPORARY GRADING WILL BE REQUIRED TO ROUTE STORMWATER TO CUT OFF SWALES AND DETENTION PONDS.
21. UPON INSTALLATION OF ANY CATCH BASIN, FILTER FABRIC SHALL BE PLACED UNDER THE GRATE AND SHALL REMAIN UNTIL THE DRAINAGE AREA IS STABILIZED.
22. CLEARING OPERATIONS SHALL BE LIMITED TO ACTIVE WORK AREAS.
23. CARE SHALL BE TAKEN TO PRESERVE AS MUCH EXISTING VEGETATION AS POSSIBLE AND HEALTHY TREES OF DESIRABLE SPECIES SHALL BE PROTECTED.
24. STORM INLET PROTECTION: IMMEDIATELY FOLLOWING COMPLETION OF ANY AND ALL OF THE PROPOSED STORM DRAIN INLETS, STORM DRAIN INLET PROTECTION SHALL BE CONSTRUCTED. THIS PROTECTION SHALL FUNCTION TO PREVENT SEDIMENT ENTRANCE INTO THE STORM DRAINS. PROTECTION SHALL BE MAINTAINED IN GOOD CONDITION UNTIL THE DRAINAGE AREAS HAVE BEEN PERMANENTLY STABILIZED.

**EROSION AND SEDIMENT CONTROL NOTES**

1. ANY CONTRACTOR INVOLVED IN EARTHWORK ACTIVITIES, INCLUDING BUT NOT LIMITED TO: CLEARING, GRADING AND TRENCHING, SHALL REVIEW ALL PERMIT CONDITIONS AND CERTIFY UNDERSTANDING OF THESE CONDITIONS. IN WRITING, IT IS THE CONTRACTOR'S RESPONSIBILITY TO IMPLEMENT ALL EROSION CONTROLS DESCRIBED IN GPO-008-01, AND IT IS NOT THE INTENT OF THESE DRAWINGS TO REPLACE OR DISSEMINATE THE PERMIT REQUIREMENTS. THE CONTRACTOR SHALL REMAIN IN COMPLIANCE WITH THE PERMIT AT ALL TIMES.
2. AT NO TIME, SHALL MORE THAN FIVE (5) ACRES REMAIN UNSTABILIZED. THE CONTRACTOR SHALL COORDINATE EARTHWORK ACTIVITIES AND IMPLEMENTATION OF SOIL STABILIZATION MEASURES TO ENSURE COMPLIANCE TO THIS PERMIT REQUIREMENT.
3. THE CONTRACTOR SHALL MAINTAIN A CLEAN CONSTRUCTION AND EQUIPMENT ENTRANCE WHENEVER PRACTICABLE.
4. DISTURBED AREAS SHALL BE STABILIZED WITHIN 14 DAYS OF COMPLETION OR SUSPENSION OF GRADING OPERATIONS.
5. INSTALL TEMPORARY & PERMANENT SEEDING IN ACCORDANCE WITH THE NEW YORK GUIDELINES FOR URBAN EROSION AND SEDIMENT CONTROL STANDARD AND SPECIFICATION FOR CROPPED AREA SEEDING, PAGE 3.3 AND FOR MULCHING PAGE 3.31.
6. IMPROVEMENTS SHOWN ARE FOR REFERENCE ONLY SEE OTHER SHEETS FOR SITE UTILITY AND GRADING.
7. PAVED AREAS ARE TO BE SWEEP DAILY TO REMOVE ANY SEDIMENT AND ALL NEWLY PAVED AREAS SHALL BE DIRECTED TO THE TEMPORARY OR FINAL SEDIMENT CONTROL BASINS.

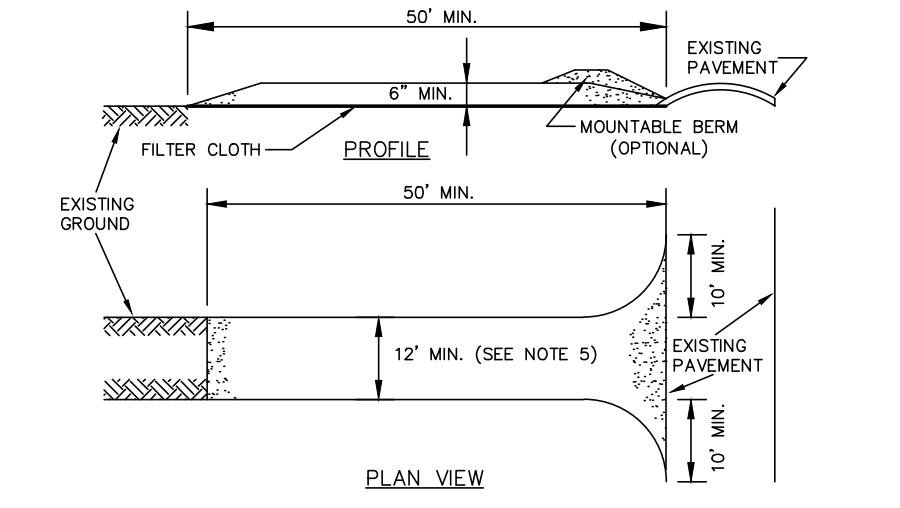

**CONSTRUCTION SPECIFICATIONS**  
NOT TO SCALE

1. INSTALL CONSTRUCTION ENTRANCE IN ACCORDANCE WITH "NEW YORK STANDARDS AND SPECIFICATIONS FOR EROSION AND SEDIMENT CONTROL", SECTION 7A.
2. STONE SIZE - USE 2" STONE, OR RECLAIMED OR RECYCLED CONCRETE EQUIVALENT.
3. LENGTH - NOT LESS THAN 50 FEET (EXCEPT ON A SINGLE RESIDENCE LOT WHERE A 30 FOOT MINIMUM LENGTH WOULD APPLY).
4. THICKNESS - NOT LESS THAN (6) INCHES.
5. WIDTH - TWELVE (12) FOOT MINIMUM, BUT NOT LESS THAN THE FULL WIDTH AT POINTS WHERE INGRESS OR EGRESS OCCURS. IF CONSTRUCTED AS THE ONLY ENTRANCE TO THE SITE, WIDTH SHALL BE TWENTY-FOUR (24) FEET.
6. SURFACE WATER - ALL SURFACE WATER FLOWING OR DIVERTED TOWARD CONSTRUCTION ENTRANCES SHALL BE PIPED ACROSS THE ENTRANCE. IF PIPING IS IMPRACTICAL, A MOUNTABLE BERM WITH 5:1 SLOPES WILL BE PERMITTED.
7. MAINTENANCE - THE ENTRANCE SHALL BE MAINTAINED IN A CONDITION WHICH WILL PREVENT TRACKING OR FLOWING OF SEDIMENT ONTO PUBLIC RIGHTS-OF-WAY. ALL SEDIMENT, SPILLED, DROPPED, WASHED OR TRACKED ONTO PUBLIC RIGHTS-OF-WAY MUST BE REMOVED IMMEDIATELY.
8. WHEN WASHING IS REQUIRED, IT SHALL BE DONE ON AN AREA STABILIZED WITH STONE AND WHICH DRAINS ONTO AN APPROVED SEDIMENT TRAPPING DEVICE.
9. PERIODIC INSPECTION AND NEEDED MAINTENANCE SHALL BE PROVIDED AFTER EACH RAIN.

**STABILIZED CONSTRUCTION ACCESS DETAIL**  
NOT TO SCALE

**STANDARD AND SPECIFICATIONS FOR WINTER STABILIZATION**



**Definition & Scope**

A temporary site specific, enhanced erosion and sediment control plan to manage runoff and sediment at the site during construction activities in the winter months to protect off-site water resources.

**Conditions Where Practice Applies**

This standard applies to all construction activities involved with ongoing land disturbance and exposure between November 15<sup>th</sup> to the following April 1<sup>st</sup>.

**Design Criteria**

1. Prepare a snow management plan with adequate storage for snow and control of melt water, requiring cleared snow to be stored in a manner not affecting ongoing construction activities.
2. Enlarge and stabilize access points to provide for snow management and stockpiling. Snow management activities must not destroy or degrade installed erosion and sediment control practices.
3. A minimum 25 foot buffer shall be maintained from all perimeter controls such as silt fence. Mark silt fence with tall stakes that are visible above the snow pack.
4. Edges of disturbed areas that drain to a waterbody within 100 feet will have 2 rows of silt fence, 5 feet apart, installed on the contour.
5. Drainage structures must be kept open and free of snow and ice dams. All debris, ice dams, or debris from plowing operations, that restrict the flow of runoff and meltwater, shall be removed.
6. Sediment barriers must be installed at all appropriate

perimeter and sensitive locations. Silt fence and other practices requiring earth disturbance must be installed before the ground freezes.

7. Soil stockpiles must be protected by the use of established vegetation, anchored straw mulch, rolled stabilization matting, or other durable covering. A barrier must be installed at least 15 feet from the toe of the stockpile to prevent soil migration and to capture loose soil.
8. In areas where soil disturbance activity has temporarily stabilized measures should be initiated by the end of the next business day and completed within three (3) days. Rolled erosion control blankets must be used on all slopes 3 horizontal to 1 vertical or steeper.
9. If straw mulch alone is used for temporary stabilization, it shall be applied at double the standard rate of 2 tons per acre, making the application rate 4 tons per acre. Other manufactured mulches should be applied at double the manufacturer's recommended rate.
10. To ensure adequate stabilization of disturbed soil in advance of a melt event, areas of disturbed soil should be stabilized at the end of each work day unless:
  - a. work will resume within 24 hours in the same area and no precipitation is forecast or;
  - b. the work is in disturbed areas that collect and retain runoff, such as open utility trenches, foundation excavations, or water management areas.

11. Use stone paths to stabilize access perimeters of buildings under construction and areas where construction vehicle traffic is anticipated. Stone paths should be a minimum 10 feet in width but wider as necessary to accommodate equipment.

**Maintenance**

The site shall be inspected frequently to ensure that the erosion and sediment control plan is performing its winter stabilization function. If the site will not have earth disturbing activities ongoing during the "winter season", all bare exposed soil must be stabilized by established vegetation, straw or other acceptable mulch, matting, rock, or other approved material such as rolled erosion control products. Seeding of areas with mulch cover is preferred but seeding alone is not acceptable for proper stabilization.

Compliance inspections must be performed and reports filed properly in accordance with the SWPPP for all sites under a winter shutdown.

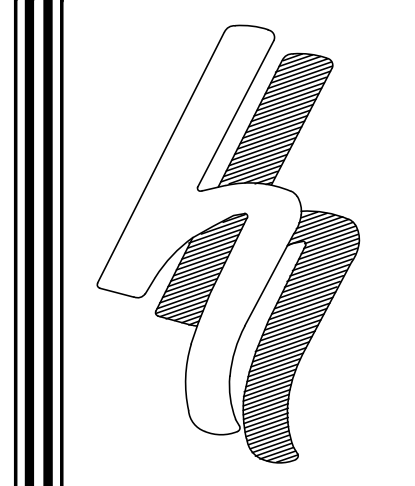

**HERSHBERG & HERSHBERG**  
Consulting Engineers and Land Surveyors  
18 Locust Street  
Albany, New York 12203

ALTERATION OF THIS DOCUMENT EXCEPT BY A LICENSED PROFESSIONAL ENGINEER OR LAND SURVEYOR, IS ILLEGAL

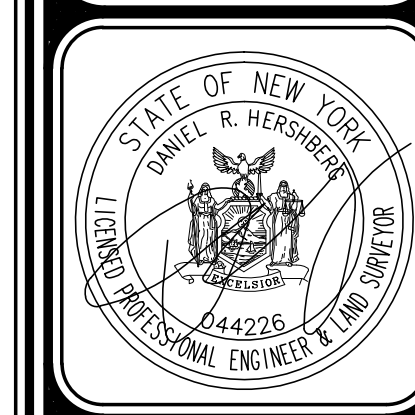

DATE	REMARKS
8-27-2019	UTILITIES UPDATED
10-21-2019	GENERAL UPDATE
1-30-2020	BUILDING FOOTPRINT REVISED
5-18-2020	NEW BUILDING FOOTPRINT
6-23-2020	NEW BUILDING AND UTILITIES UPDATED
REVISIONS	

**EROSION AND SEDIMENT CONTROL NOTES AND DETAILS**  
**No.67 LIVINGSTON AVENUE**  
**CITY OF ALBANY STATE OF NEW YORK**



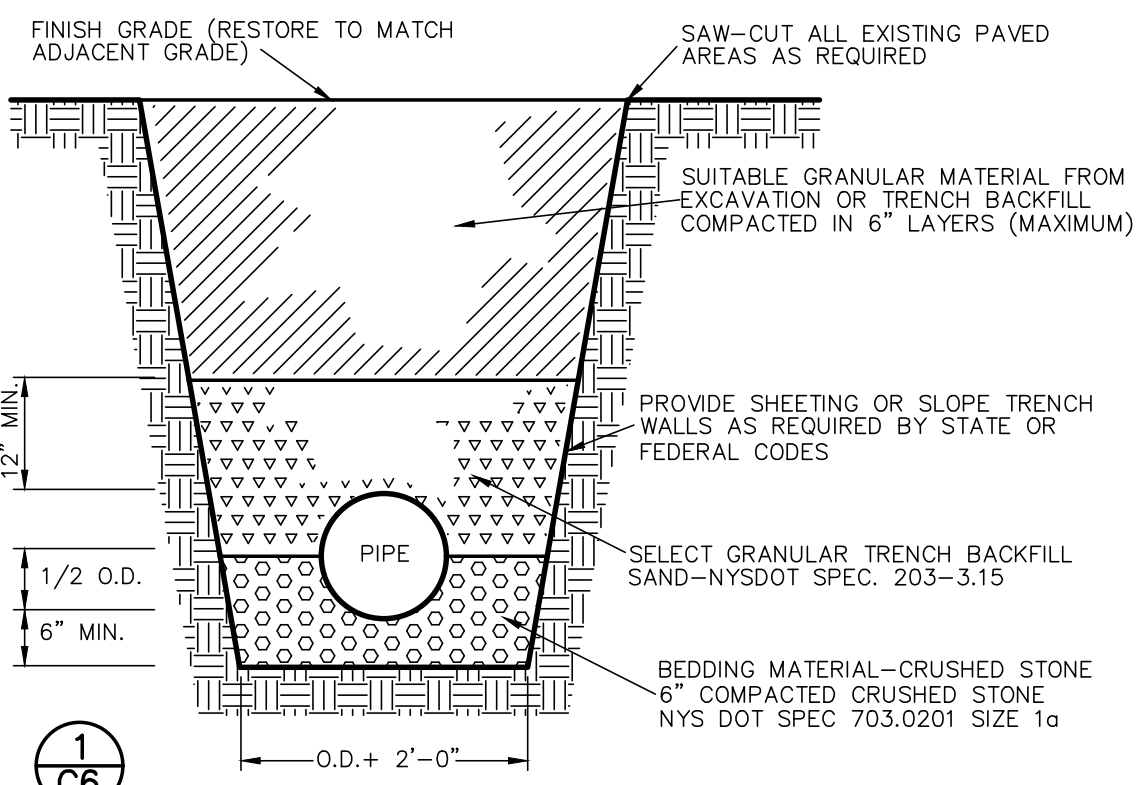

**1 C6** **SANITARY SEWER TRENCH DETAIL**  
NOT TO SCALE

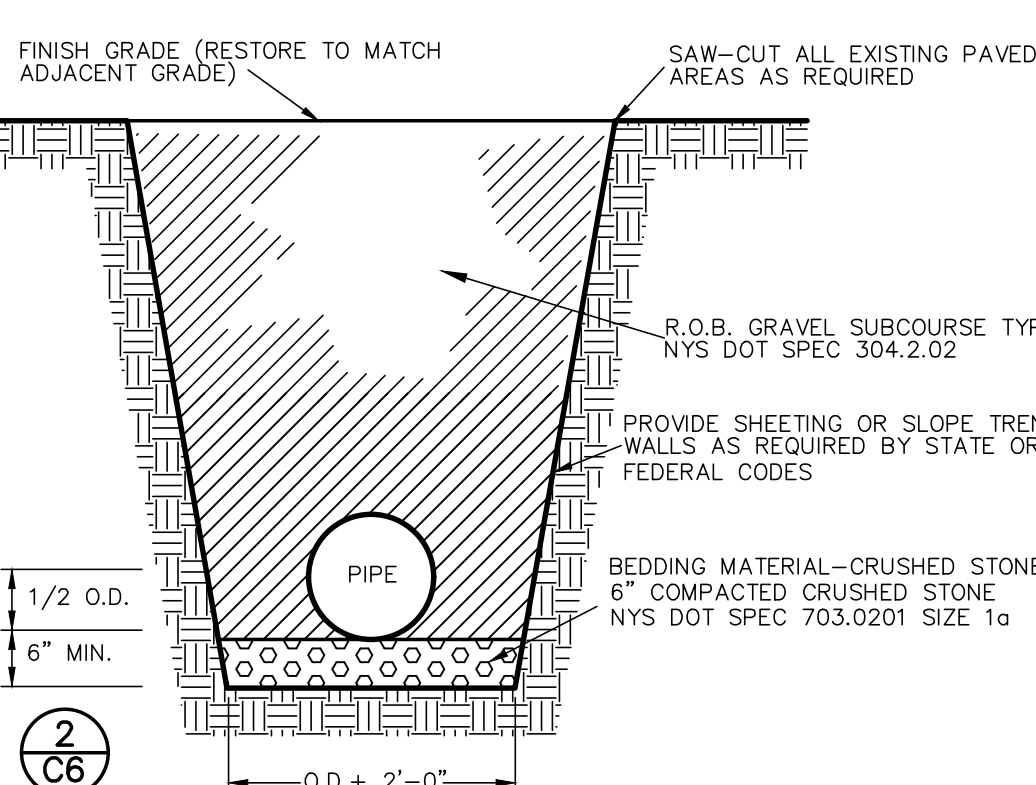

**2 C6** **STORM SEWER TRENCH DETAIL**  
NOT TO SCALE

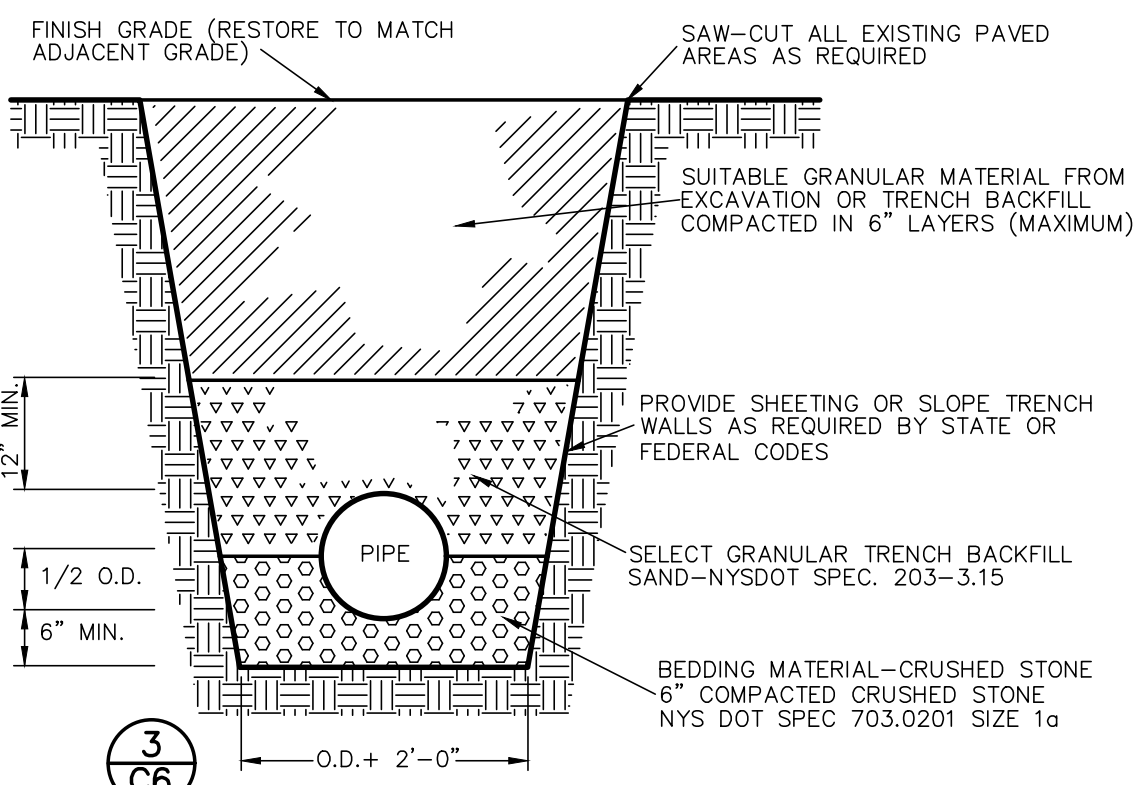

**3 C6** **WATER MAIN TRENCH DETAIL**  
NOT TO SCALE

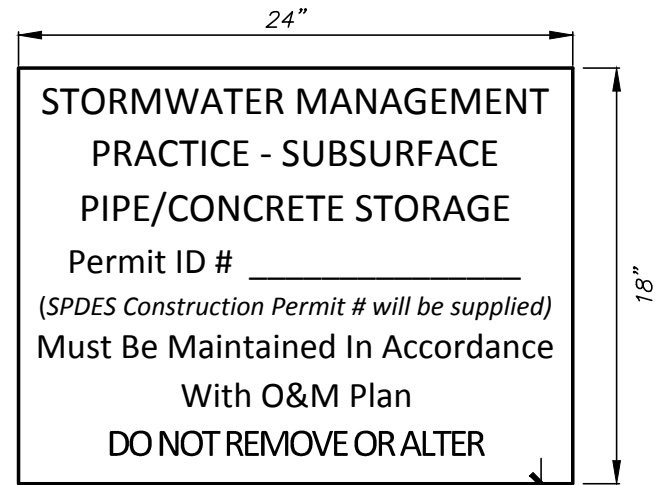

**4 C6** **STORMWATER MANAGEMENT PRACTICE SIGN**  
(AT SUBSURFACE STORAGE LOCATIONS)  
NOT TO SCALE

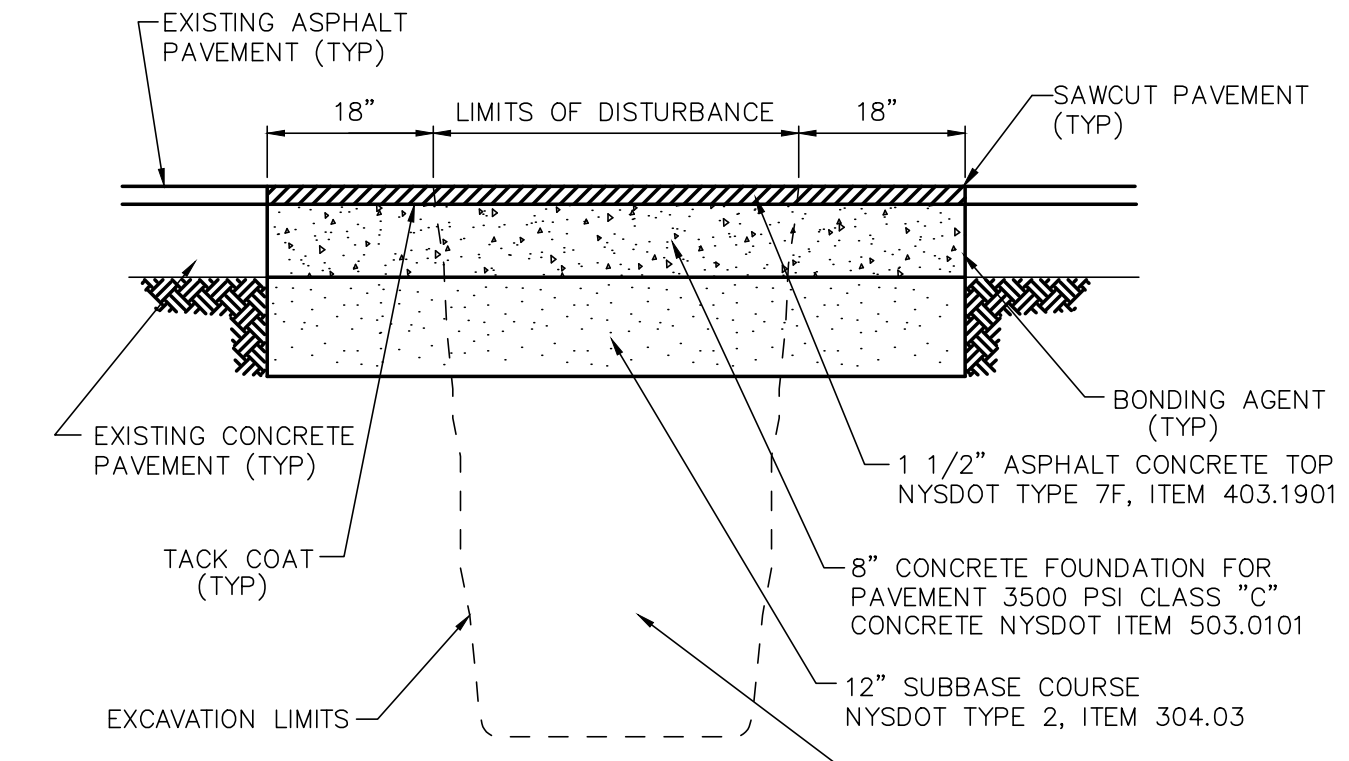

- NOTE:**
- IF LIMITS OF TRENCHING EXCEEDS 50 FEET, CONTRACTOR SPECIFICATIONS SHALL COMPLETE CURB TO CURB MILLING PER CITY DETAILS
  - ALL PAVEMENT MARKINGS DISTURBED SHALL BE RESTORED TO THE SATISFACTION OF THE CITY
  - ALL JOINTS TO BE SEALED WITH ASPHALT EMULSION (AC-20) NYSDOT ITEM 702-0500

**5 C6** **STREET RESTORATION CONCRETE PAVEMENT DETAIL (CITY R.O.W.)**  
NOT TO SCALE

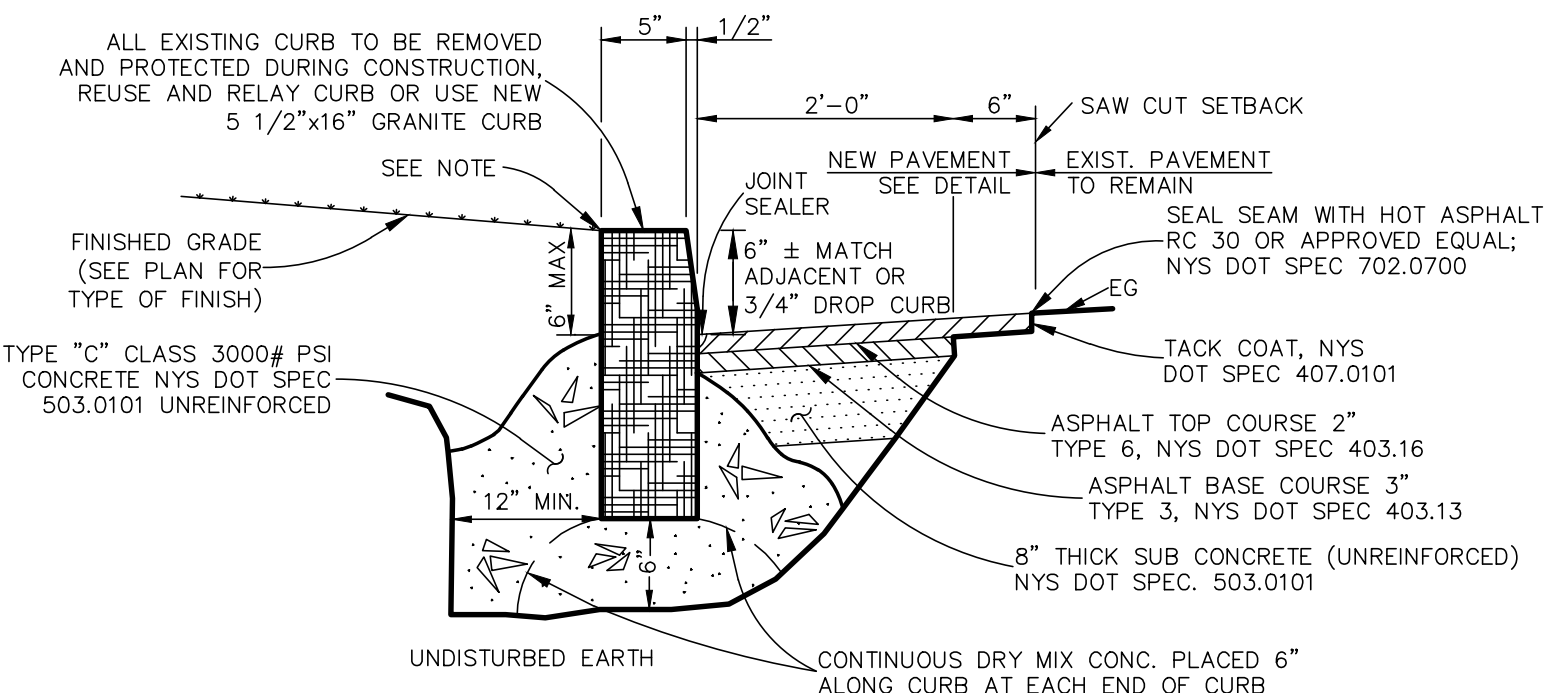

**8 C6** **NEW OR RELAY CURB DETAIL (CITY R.O.W.)**  
NOT TO SCALE

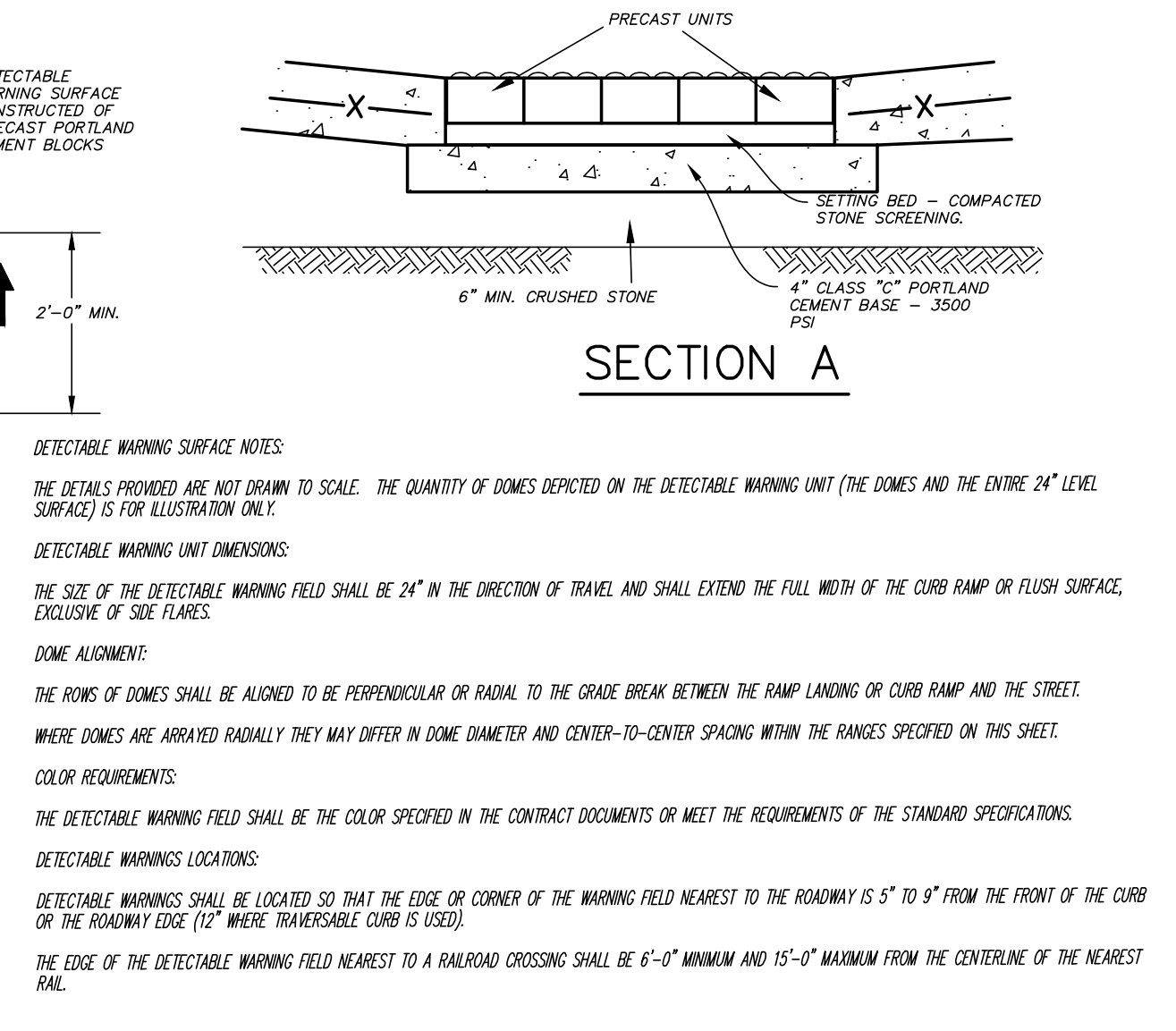
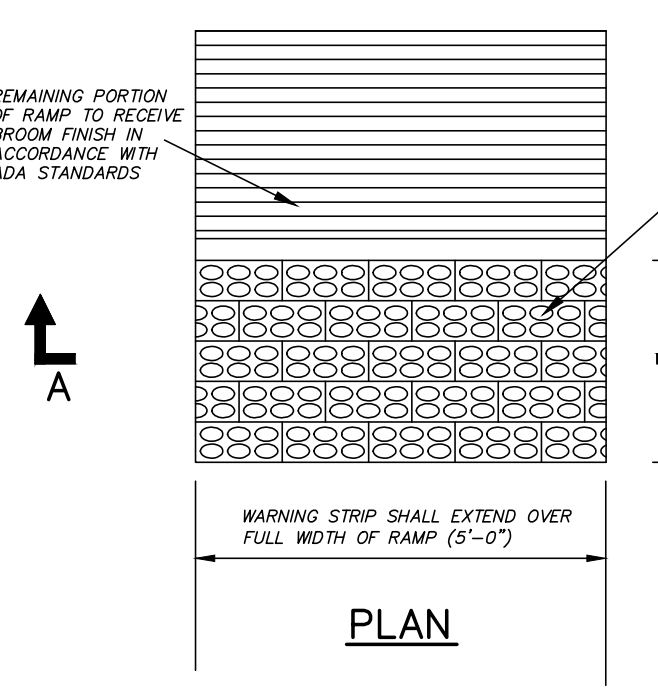

**13 C6** **ADA DETECTABLE WARNING STRIP DETAIL**  
NOT TO SCALE

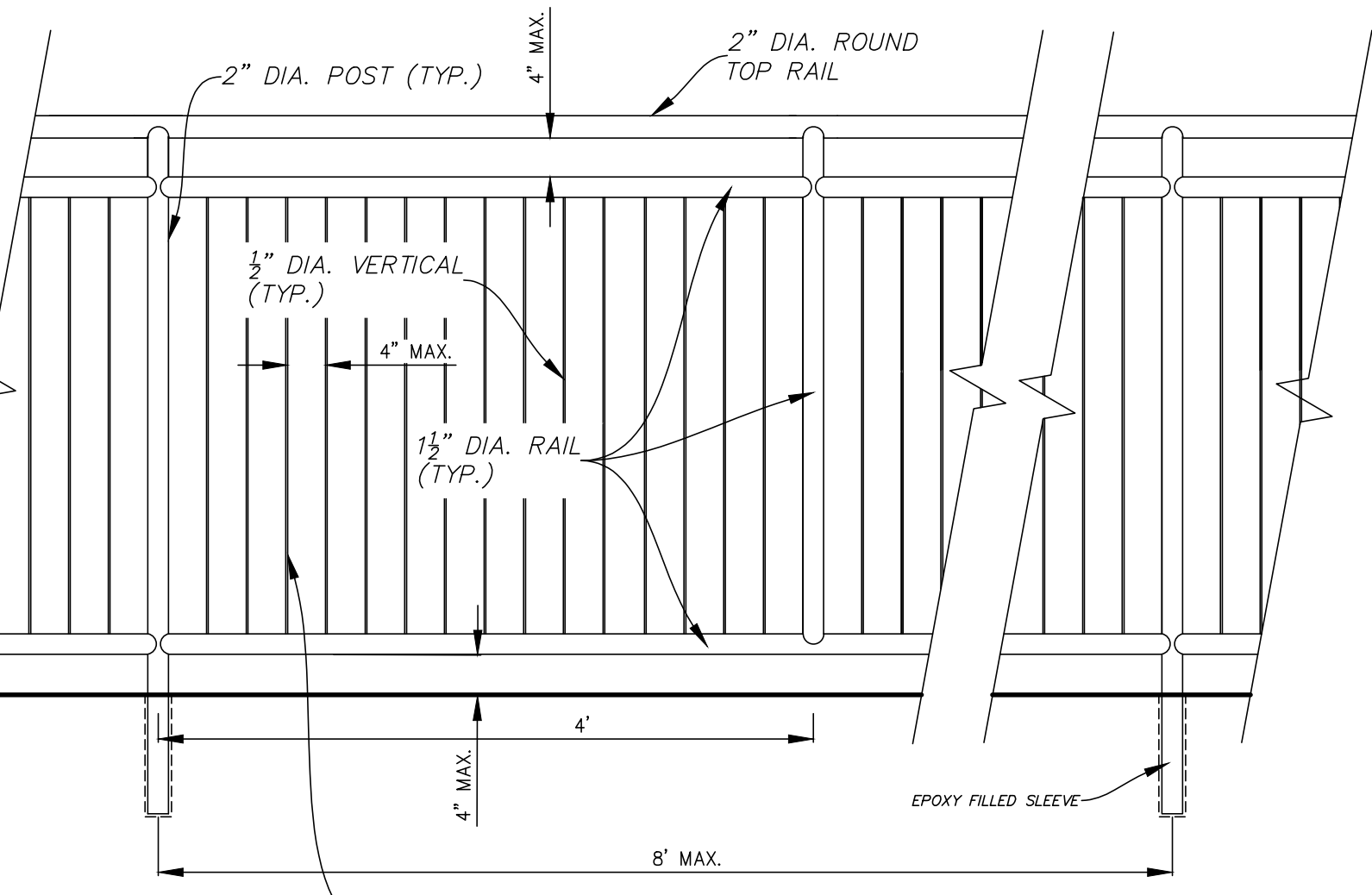

**6 C6** **FALL PROTECTION RAILING**  
NOT TO SCALE

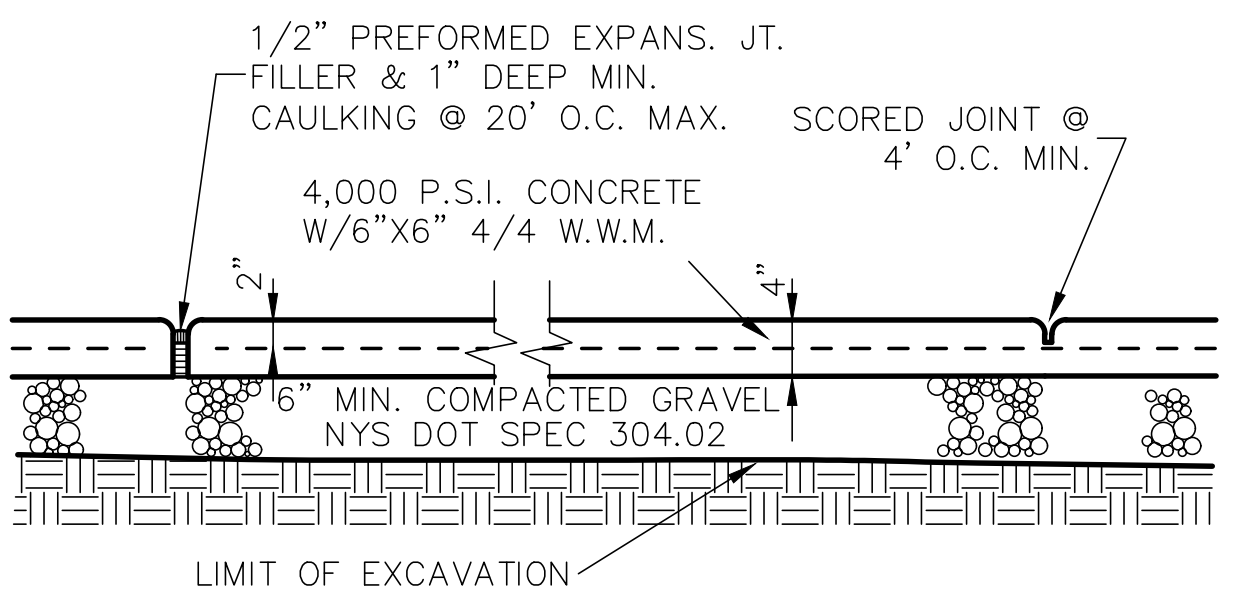

**LONGITUDINAL SECTION**

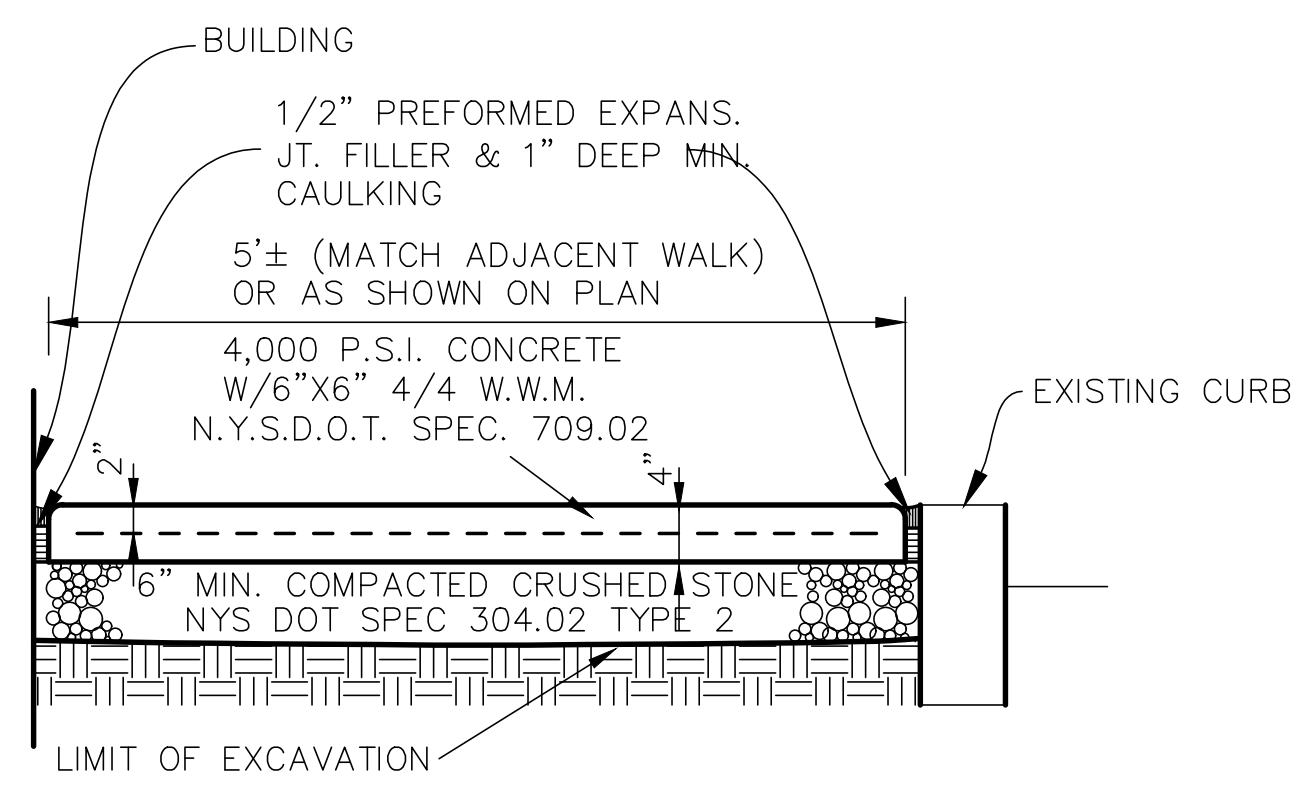

**CROSS SECTION**

- NOTES:**
- SIDEWALK SLOPE FROM BUILDING WALL TO CURB TO BE 1/8" PER FOOT
  - SIDEWALK FINISH TO BE MAGNESIUM FLOAT FINISH
  - CONCRETE WALK TO CONFORM TO CITY OF ALBANY ENGINEERING SPECIFICATIONS
  - CONCRETE USED SHALL HAVE AN AIR CONTENT OF 5% MIN. TO 7% MAX., AND A SLUMP OF THREE INCHES MIN. TO FIVE INCHES MAX.
  - ALL CONCRETE SIDEWALK REPLACEMENT SHALL BE TO FULL PANEL LIMITS. PARTIAL REPLACEMENTS WILL NOT BE ALLOWED.
  - EXPANSION JOINTS TO BE PLACED BETWEEN ADJACENT SLABS, AT BUILDING LINE OR PENETRATING STRUCTURES.
  - ALL CURBING SHALL BE RESET OR REPLACED AS REQUIRED IN ACCORDANCE WITH CITY DETAILS.

**11 C6** **NEW CONCRETE WALK DETAIL**  
NOT TO SCALE

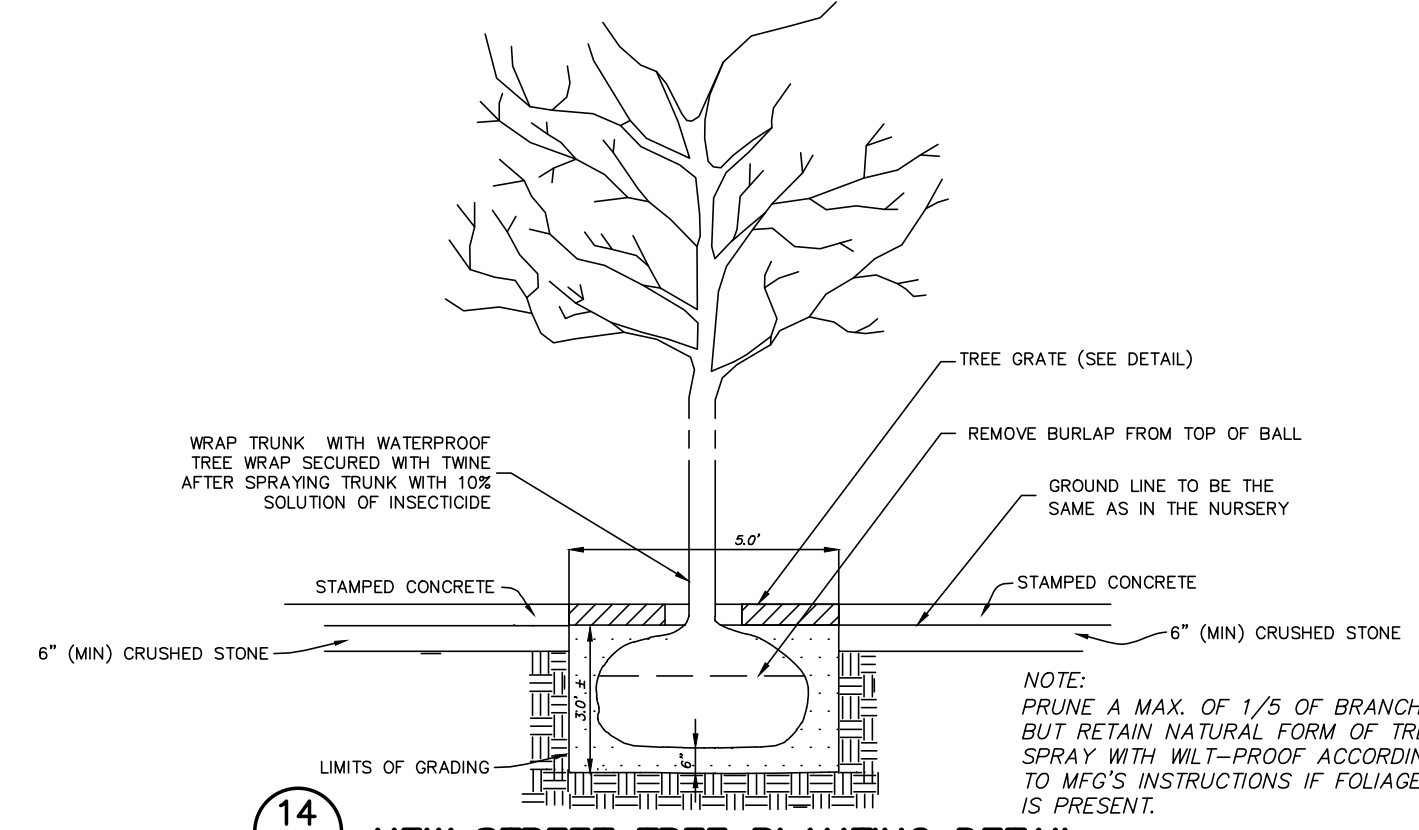

**14 C6** **NEW STREET TREE PLANTING DETAIL**  
NOT TO SCALE

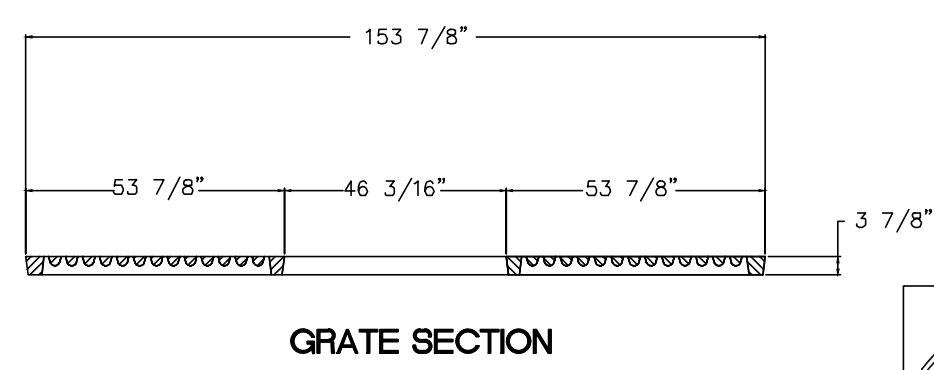

- NOTES:**
- MATERIAL SHALL BE GRAY CAST IRON CONFORMING TO A.S.T.M. A48 (LATEST REVISION) CLASS 35B.

Syracuse Castings	PATTERN #	DIMENSIONS (INCHES)					AMOUNT
	A	B	C	D	E		
91886425	60"	30"	18"	60"	1 1/2"	4	

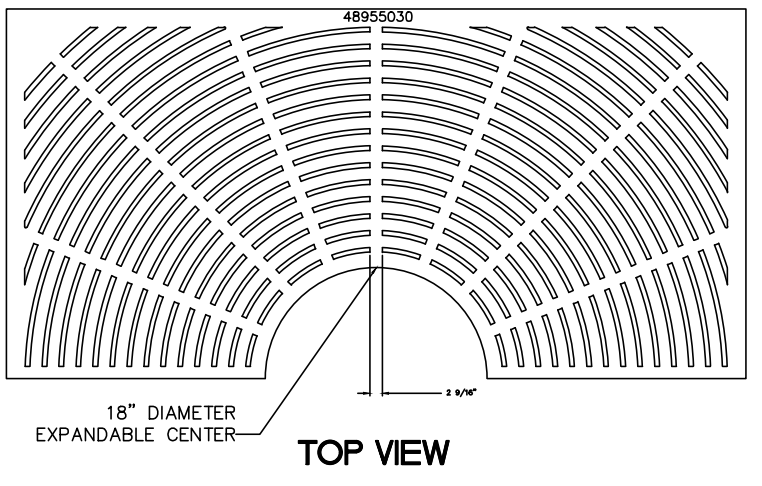

**TREE GRATE DETAIL**  
NOT TO SCALE

**GENERAL NOTES**

- ALL WORK SHALL BE DONE IN STRICT COMPLIANCE WITH ALL APPLICABLE NATIONAL, STATE AND LOCAL CODES, STANDARDS, ORDINANCES, RULES AND REGULATIONS AND DIVISION 1 OF SPECIFICATIONS.
- EXISTING UTILITY INFORMATION SHOWN HEREON WAS OBTAINED FROM FIELD LOCATION WHERE POSSIBLE AND FROM RECORD DATA. THE LOCATION OF ALL UNDERGROUND UTILITIES ARE APPROXIMATE. ACTUAL LOCATION SHALL BE VERIFIED BY THE CONTRACTOR. CONTACT DIG SAFELY NEW YORK (1-800-952-7962) AND MUNICIPAL AGENCIES HAVING JURISDICTION 72 HOURS PRIOR TO ANY EXCAVATING AND/OR CONSTRUCTION TO HAVE UTILITIES MARKED ON SITE.
- CONSTRUCTION OF WATER MAINS, STORM AND SANITARY SEWERS MUST BEGIN AT ITS POINT OF CONNECTION TO THE EXISTING WATER MAINS, SEWER OR AT THE LOWEST POINT IN THE SYSTEM. VALVES, HYDRANTS, RIMS, GRATES, INVERTS, CLEARANCES AND LOCATION AT CROSSINGS MUST BE VERIFIED PRIOR TO THE BEGINNING OF CONSTRUCTION. THE ENGINEER MUST BE NOTICED AT LEAST 24 HOURS IN ADVANCE OF ANY INSTALLATION SO THAT HE WILL BE ABLE TO PROVIDE SUPERVISION AS REQUIRED. THE CONTRACTOR MUST KEEP A RECORD OF ALL UNDERGROUND UTILITIES INSTALLED OR ENCOUNTERED SO THE ENGINEER WOULD BE ABLE TO USE THESE RECORDS FOR THE PREPARATION OF RECORD DRAWINGS AS REQUIRED BY THE LOCAL MUNICIPALITY.
- ALL SANITARY SEWERS, STORM SEWERS, AND WATER MAINS AND APPURTENANCES SHALL BE CONSTRUCTED IN COMPLIANCE WITH THE LOCAL MUNICIPALITY'S CODES AND REGULATIONS GOVERNING THE INSTALLATION OF SUCH UTILITIES.
- THE ENGINEER RESERVES THE RIGHT TO EXAMINE ANY WORK DONE ON THIS PROJECT AT ANY TIME TO DETERMINE THE CONFORMANCE WITH THE REQUIREMENTS OF THE CONTRACT DOCUMENTS OF THIS PROJECT, AS INTENDED AND INTERPRETED BY THE ENGINEER.
- INCIDENTAL WORK NOT SPECIFICALLY SHOWN ON THE CONTRACT DRAWINGS SUCH AS PATCHING, BLOCKING, TRIMMING, ETC. SHALL BE PERFORMED AS REQUIRED TO MAKE THE WORK COMPLETE.
- ALL DISTURBED AREA SHALL RECEIVE TOPSOIL AND SEED, EXCEPT AS OTHERWISE NOTED.
- THE CONTRACTOR SHALL:
  - VERIFY ALL CONDITIONS IN THE FIELD PRIOR TO COMMENCEMENT OF WORK AND NOTIFY THE ENGINEER OF ANY DISCREPANCIES.
  - EXAMINE THE SITE AND INCLUDE IN HIS WORK THE EFFECT OF ALL EXISTING CONDITIONS ON THE WORK.
  - PROVIDE AND INSTALL ALL MATERIALS AND PERFORM ALL WORK IN ACCORDANCE WITH RECOGNIZED GOOD STANDARD PRACTICE.
  - COMMENCE WORK IMMEDIATELY UPON AWARDING OF THE CONTRACT AND PROCEED DILIGENTLY AND CONTINUALLY TO COMPLETION OF ALL WORK.
  - PROVIDE CERTIFICATE OF INSURANCE ACCEPTABLE TO THE OWNER PRIOR TO COMMENCEMENT OF THE WORK.
  - HOLD THE OWNER HARMLESS AGAINST ANY AND ALL CLAIMS ARISING FROM WORK DONE BY THE CONTRACTOR ON THE SITE.
- IF WATER MAINS ARE REQUIRED TO BE RELOCATED DUE TO CROSSING CONFLICTS SHALL BE INSTALLED, TESTED AND ACCEPTED IN ACCORDANCE WITH LOCAL MUNICIPALITY RULES AND REGULATIONS.
- SANITARY SEWER CONNECTION SHALL BE INSTALLED AND ACCEPTED IN ACCORDANCE WITH THE ALBANY COUNTY HEALTH DEPARTMENT RULES AND REGULATIONS.
- ALL BACKFILL USED IN TRENCHES EXCAVATED IN EXISTING ROADWAYS SHALL BE PLACED IN MAXIMUM SIX (6) INCH LIFTS AND COMPACTED BY MEANS OF A MECHANICAL COMPACTOR BETWEEN LIFTS.
- WHEN BACKFILLING AROUND PROPOSED OR EXISTING STRUCTURES, MATERIAL SHALL BE PLACED IN MAXIMUM SIX (6) INCH LIFTS AND COMPACTED BY MEANS OF A COMPACTOR BETWEEN LIFTS.
- SEWER MAINS IN RELATION TO WATER MAINS: WHERE POSSIBLE SEWERS SHALL BE LAID AT LEAST 10.0 FEET HORIZONTALLY FROM ANY EXISTING OR PROPOSED WATER MAIN. VERTICAL SEPARATION SHALL BE MAINTAINED TO PROVIDE A MINIMUM OF EIGHTEEN (18) INCHES BETWEEN THE SEWER AND WATER MAIN. CROSSINGS, WHEN IMPOSSIBLE TO OBTAIN THE VERTICAL SEPARATION, DUCTILE IRON CLASS 52 OR POLYVINYL CHLORIDE (PVC) C1 160, SDR 26 PIPE SHALL BE USED FOR THE SEWER MAINS.
- NEW WATER MAINS AND LATERALS WILL BE INSPECTED BY THE ALBANY WATER DEPARTMENT BEFORE BACKFILL.
- NEW REINFORCED CONCRETE SIDEWALKS: THE CONTRACTOR WILL INSTALL ALL NEW REINFORCED CONCRETE SIDEWALKS WITHIN THE CITY R.O.W. AT A SLOPE OF 1/4" PER FOOT TOWARDS THE CURB. NO VARIANCES AND/OR DEVIATION OF THE SLOPE WILL BE ALLOWED UNLESS PREVIOUSLY APPROVED BY THE CITY ENGINEER'S REPRESENTATIVE.
- PROVIDE EROSION CONTROL MEASURES TO PREVENT EROSION OR DISPLACEMENT OF SOILS AND DISCHARGE OF SOIL BEARING WATER RUNOFF OR AIRBORNE DUST TO ADJACENT PROPERTIES AND WALKWAYS. THIS WILL INCLUDE BUT NOT LIMITED TO HAY BALES, SILTATION FENCES AND OTHER ACCEPTABLE METHODS OF EROSION CONTROL. THE INTENT OF THESE MEASURES IS TO INSURE THE PREVENTION OF SILTATION OF WATER COURSES DOWN STREAM FROM THIS PROJECT IN COMPLIANCE WITH THE NEW YORK STATE DEPARTMENT OF ENVIRONMENTAL CONSERVATION "GENERAL PERMIT FOR STORM WATER DISCHARGE ASSOCIATED WITH INDUSTRIAL ACTIVITY FROM CONSTRUCTION ACTIVITIES".
- ALL VEHICLES HAULING MATERIAL SHALL BE EQUIPPED WITH CANVAS COVERS TO PREVENT DUST AND LOOSE MATERIAL FROM EXITING THE VEHICLE.
- CONFORM TO NYSDOT EROSION & SEDIMENT CONTROL 2016 STANDARDS.
- ALL DISTURBED AREAS SHALL BE SEEDS AND MULCHED PROMPTLY TO MINIMIZE EROSION POTENTIAL.
- ALL EXISTING DRAINAGE MUST BE MAINTAINED.
- FINISHED GRADES SHOWN HEREON DEPICT THE GRADE. UPON COMPLETION OF CONSTRUCTION, FINISHED GRADES AT TIME OF RECLAMATION MAY BE LOWER DUE TO EXCAVATION FOR TOPSOIL, SUB-BASE MATERIAL, AT ROADS, PARKING, CONCRETE SLABS, OR FLOOR SLABS.
- CONTRACTOR SHALL USE DUST CONTROL MEASURES DURING CONSTRUCTION.
- EXISTING GRANITE CURBS WHICH ARE TO BE REMOVED MAY BE REUSED IN LIEU OF NEW CURB IF IN THE OPINION OF THE ENGINEER THEY ARE SUITABLE FOR REUSE.
- ALL NEW WALKS SHALL HAVE A CROSS PITCH OF 1/4" PER FOOT TOWARDS THE CURB AND/OR AWAY FROM BUILDINGS.
- ALL LAYOUT TO BE PERFORMED BASED UPON ASSUMED COORDINATE SYSTEM WHICH IS UNIQUE TO THIS PROJECT.
- CONTOUR ELEVATION AND SPOT ELEVATION ARE BASED UPON NVD0 DATUM.
- THE CONTRACTOR SHALL VERIFY THAT NO OTHER CONNECTIONS EXIST OTHER THAN SHOWN, CONCERNING SEWER LINES LABELED "TO BE ABANDONED" OR "TO BE REMOVED". MOST EXISTING UTILITIES SHOWN HERE WERE TAKEN FROM OLD AND INCOMPLETE RECORD DRAWINGS. THE ENGINEER AND THE OWNER ARE NOT RESPONSIBLE FOR THE ACCURACY OF THIS INFORMATION. THE CONTRACTOR MUST VERIFY THESE CONDITIONS ON HIS OWN, PRIOR TO COMMENCEMENT OF WORK.
- WHENEVER A PORTION OF EXISTING PAVEMENT IS TO BE REMOVED IT SHALL FIRST BE SAWCUT TO FULL DEPTH.
- NO TREES SHALL BE REMOVED WITHOUT THE ENGINEER'S CONSENT.
- SEEDING OF ALL CUT AND FILL AREAS SHALL BE DONE IMMEDIATELY AFTER CONSTRUCTION.
- RESTORATION AT ALL UTILITY CUTS IN SIDEWALK AREA SHALL HAVE FULL PANEL RESTORATION.
- ALL NEW CURBING WITHIN CITY RIGHT OF WAY SHALL BE GRANITE CURBING.
- CONTRACTOR SHALL CONFORM TO ALL RECOMMENDATIONS IN GEOTECHNICAL EVALUATION PREPARED BY DENTE ENGINEERING.
- CONTRACTOR SHALL BE RESPONSIBLE FOR ANY DAMAGE AND OR REPAIR TO EXISTING ROADWAY SYSTEM DUE TO CONSTRUCTION ACTIVITIES.

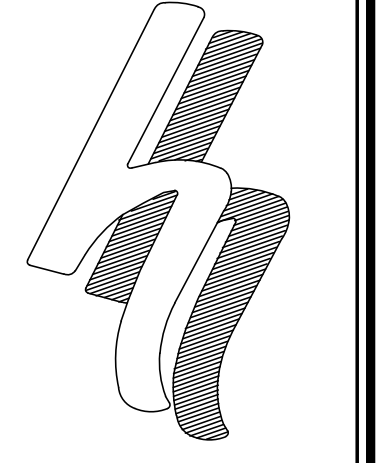

**HERSHBERG & HERSHBERG**  
Consulting Engineers and Land Surveyors  
18 Locust Street  
Albany, New York 12203

ALTERATION OF THIS DOCUMENT EXCEPT BY A LICENSED PROFESSIONAL ENGINEER OR LAND SURVEYOR, IS ILLEGAL

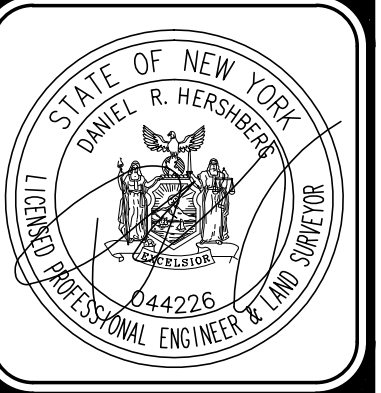

DATE	REMARKS
8-27-2019	UTILITIES UPDATED
10-27-2019	GENERAL UPDATE
1-30-2020	BUILDING FOOTPRINT REVISED
5-18-2020	NEW BUILDING FOOTPRINT
6-23-2020	NEW BUILDING AND UTILITIES UPDATED
REVISIONS	



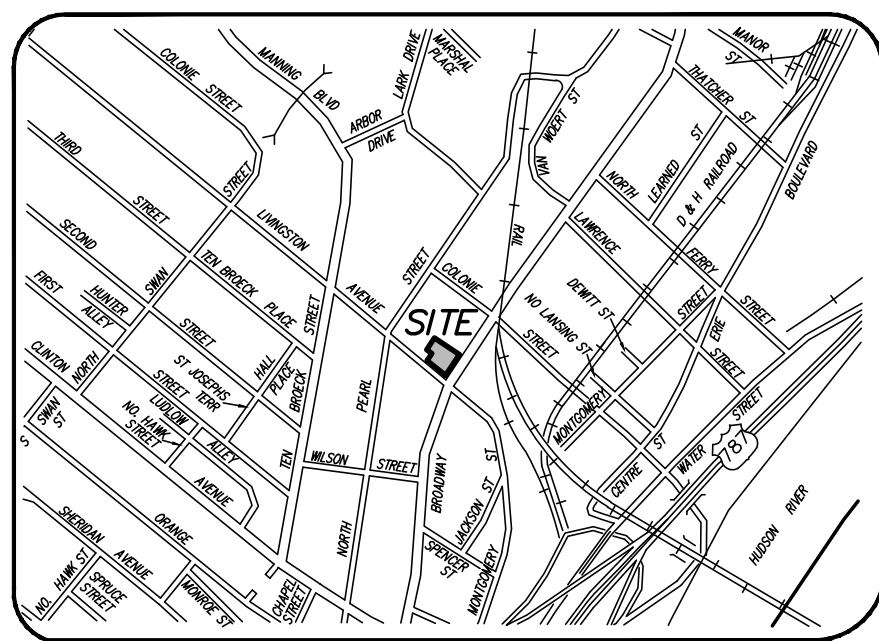

VICINITY MAP

MAP NOT TO SCALE

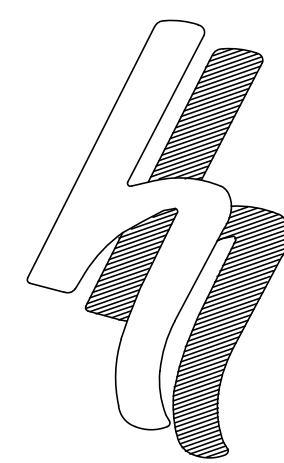

*HERSHBERG  
&  
HERSHBERG*

*Consulting Engineers  
and Land Surveyors*

18 Locust Street  
Albany, New York 12203

ALTERATION OF THIS  
DOCUMENT EXCEPT BY A  
LICENSED PROFESSIONAL  
ENGINEER OR LAND  
SURVEYOR, IS ILLEGAL

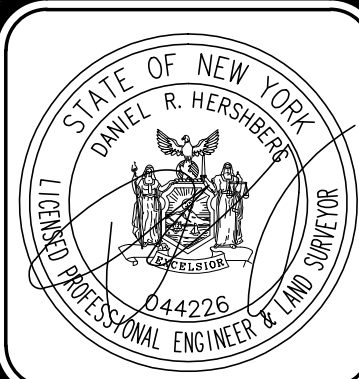

REMARKS	DATE
UTILITIES UPDATED	8-27-2019
GENERAL UPDATE	10-21-2019
BUILDING FOOTPRINT REVISED	1-30-2020
NEW BUILDING FOOTPRINT	5-18-2020
NEW BUILDING AND UTILITIES UPDATED	6-23-2020

WORK ZONE TRAFFIC PROTECTION PLAN  
No.67 LIVINGSTON AVENUE  
CITY OF ALBANY STATE OF NEW YORK

FILE: 180196

BY: SMCC

CHK: DRH

DATE: 7-29-2019

180196-1.DWG

FOR MUNICIPAL APPROVAL ONLY-NOT INTENDED FOR CONSTRUCTION

C7



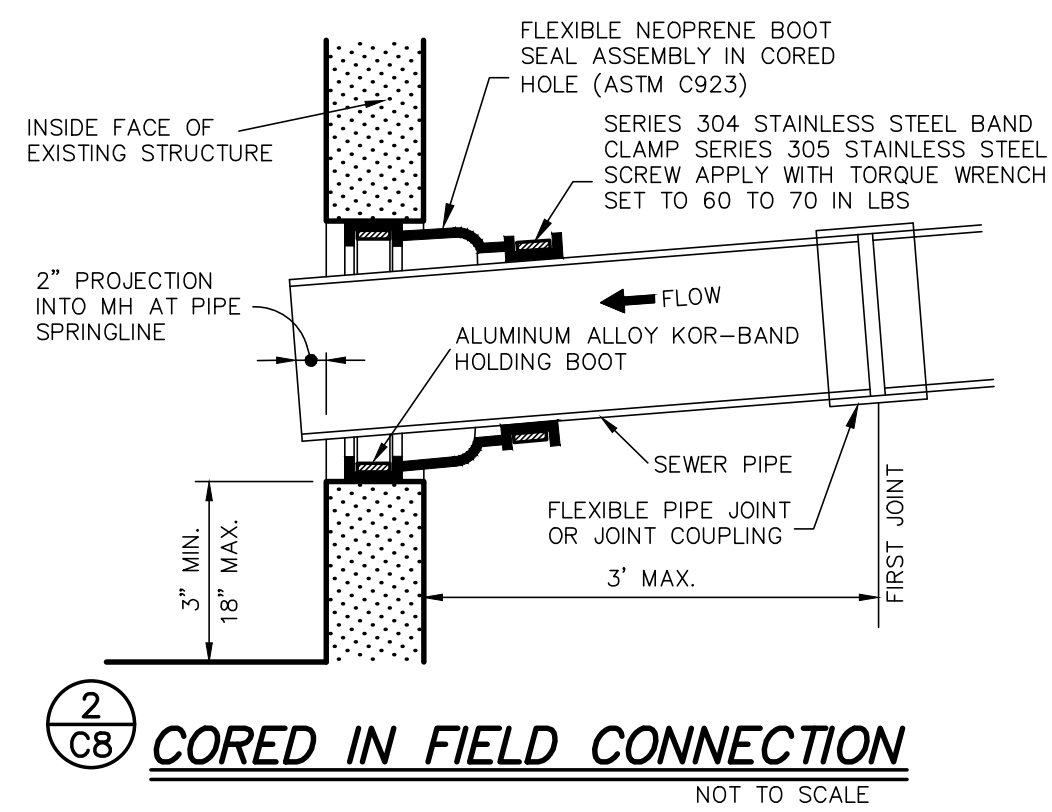

- NOTES:
1. 48 HOURS NOTICE MUST BE GIVEN TO DEPARTMENT OF WATER FOR INSPECTIONS.
  2. ALBANY WATER DEPARTMENT MUST TAP THEIR OWN MAINS.
  3. PRESSURE AND LEAKAGE TESTING OF THE WATER MAIN SHALL BE WITNESSED BY DEPARTMENT STAFF AND ACCEPTABLE BACTERIOLOGICAL TEST MUST BE SUBMITTED AND ACCEPTED BY THE DEPARTMENT PRIOR TO FINAL OF THE NEW WATER MAIN.

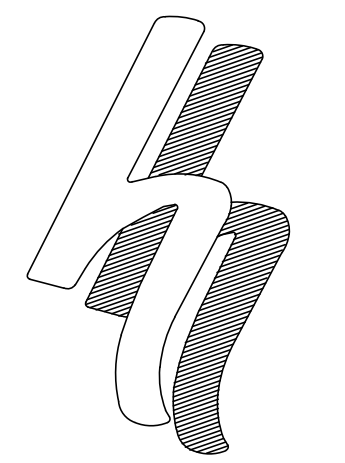
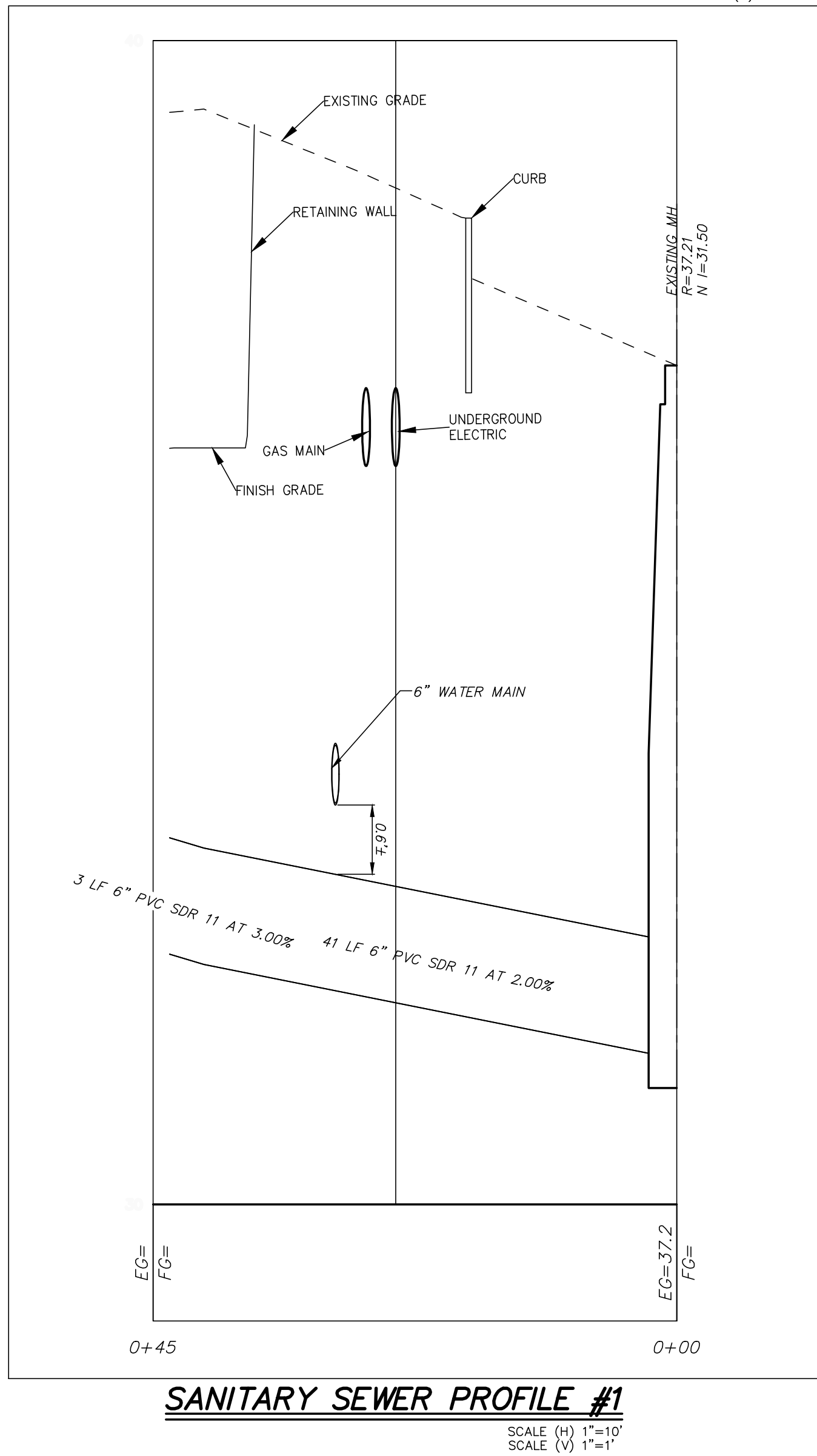
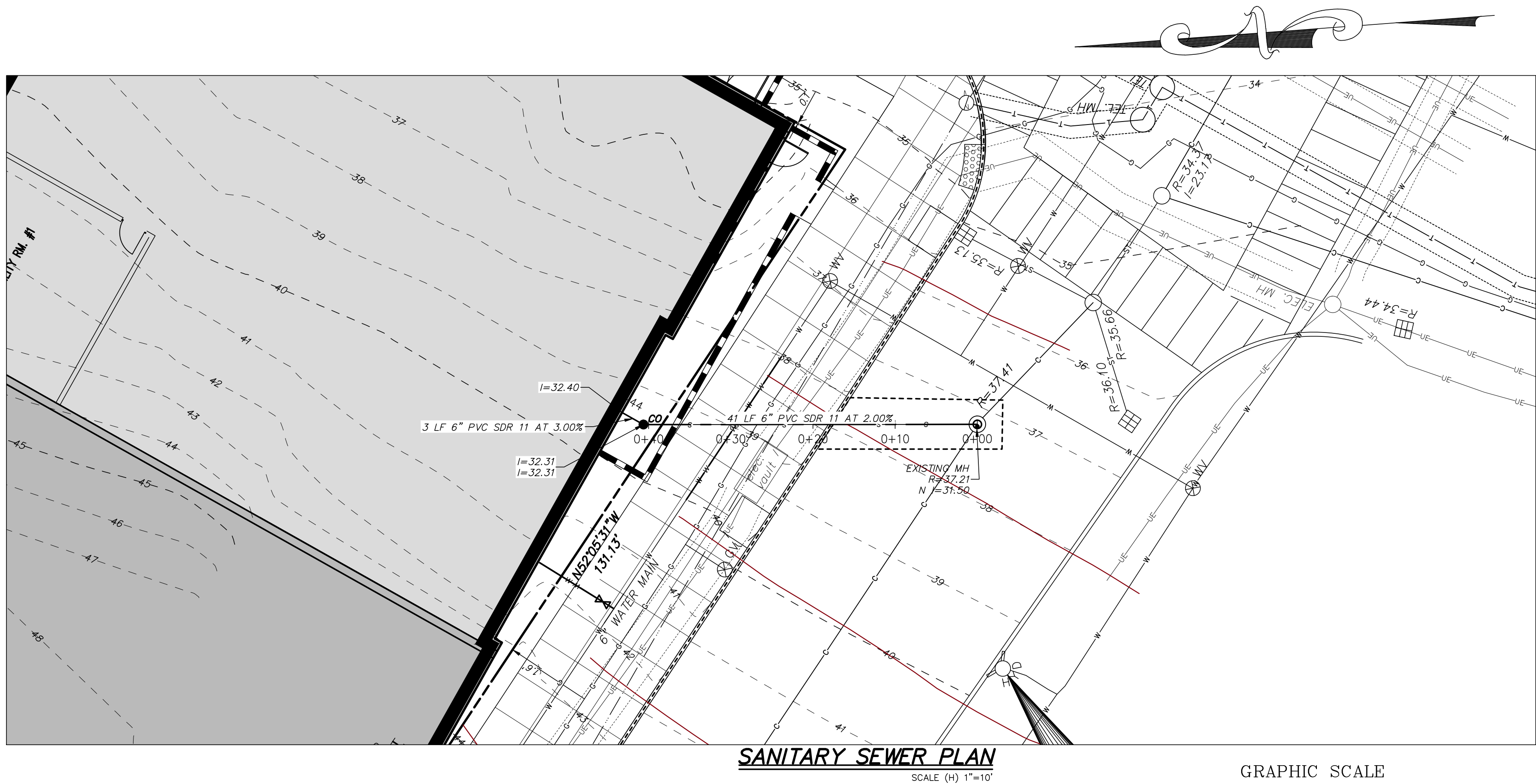

**HERSHBERG  
&  
HERSHBERG**  
Consulting Engineers  
and Land Surveyors

18 Locust Street  
Albany, New York 12203

ALTERATION OF THIS  
DOCUMENT EXCEPT BY A  
LICENSED PROFESSIONAL  
ENGINEER OR LAND  
SURVEYOR, IS ILLEGAL



DATE	REMARKS
8-27-2019	UTILITIES UPDATED
10-21-2019	GENERAL UPDATE
1-30-2020	BUILDING FOOTPRINT REVISED
5-18-2020	NEW BUILDING FOOTPRINT
6-23-2020	NEW BUILDING AND UTILITIES UPDATED
REVISIONS	

**SANITARY SEWER PLAN AND DETAILS**  
**No.67 LIVINGSTON AVENUE**  
**CITY OF ALBANY STATE OF NEW YORK**

FILE: 180196

DATE: 7-29-2019

CHK: DRH

BY: SAC

SCALE: 1"=5'

**C8**

FOR MUNICIPAL APPROVAL ONLY-NOT INTENDED FOR CONSTRUCTION



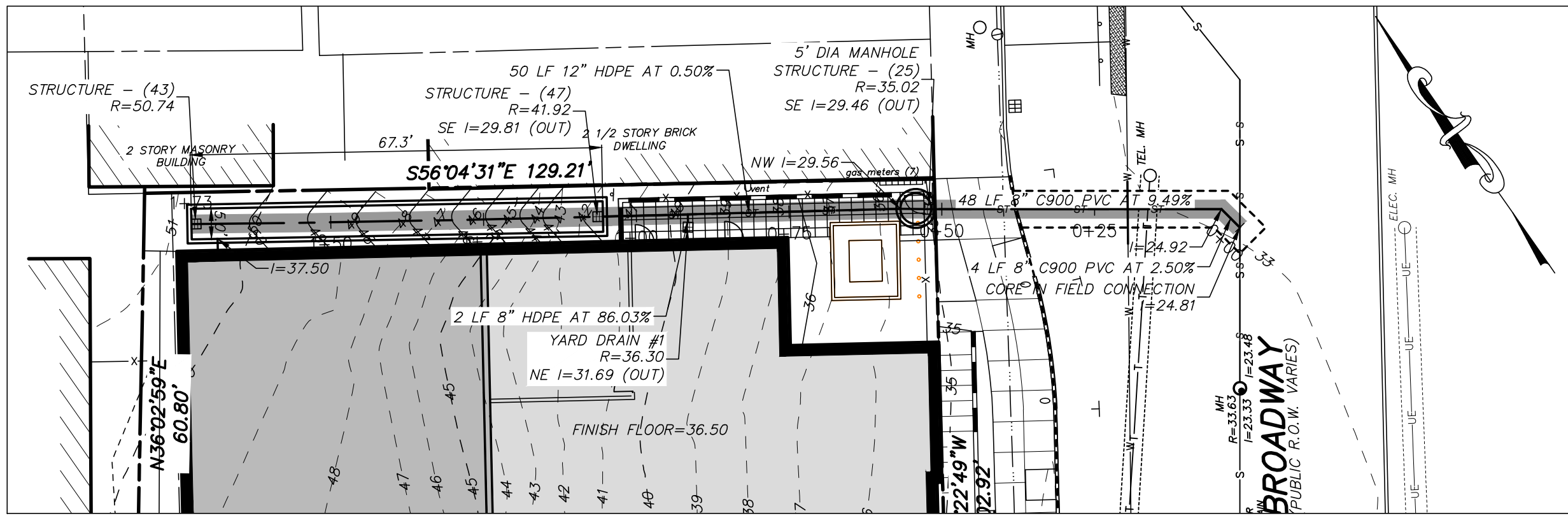

**STORM SEWER PLAN #1**  
SCALE 1"=20'

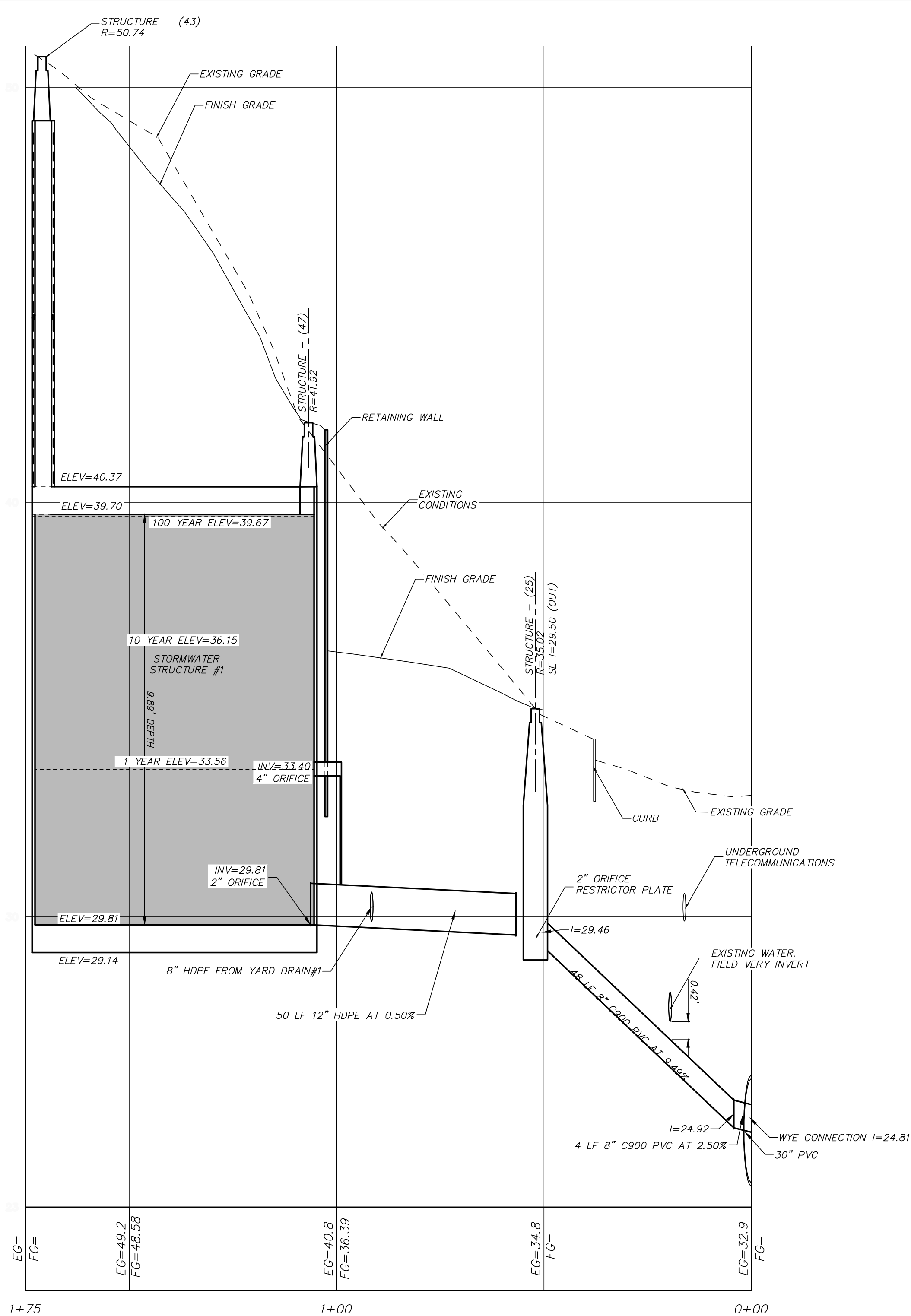

**STORM SEWER PROFILE #1**

SCALE (H) 1"=20'  
SCALE (V) 1"=2'

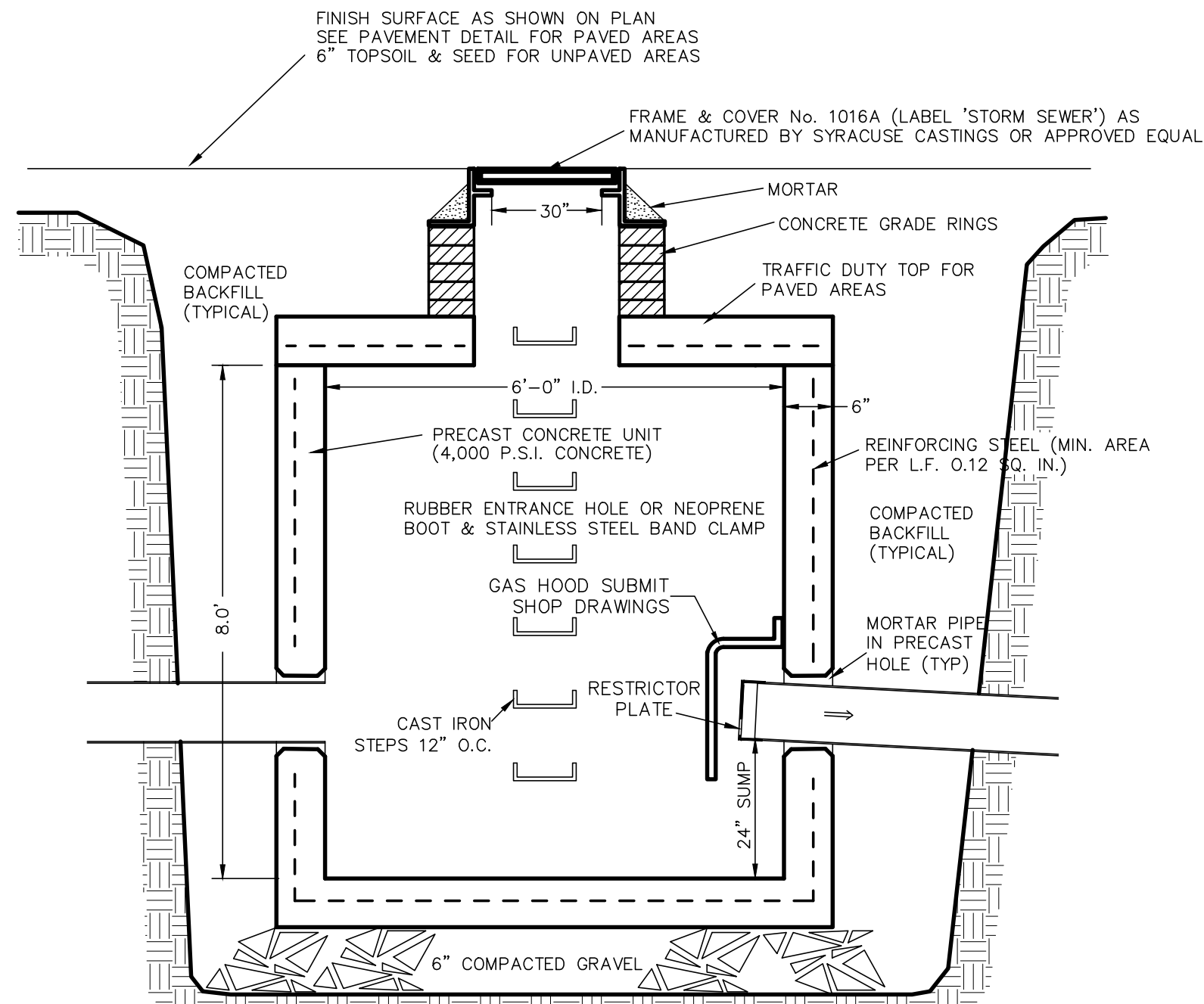

**1 C9 STORM MANHOLE DETAIL**  
NOT TO SCALE

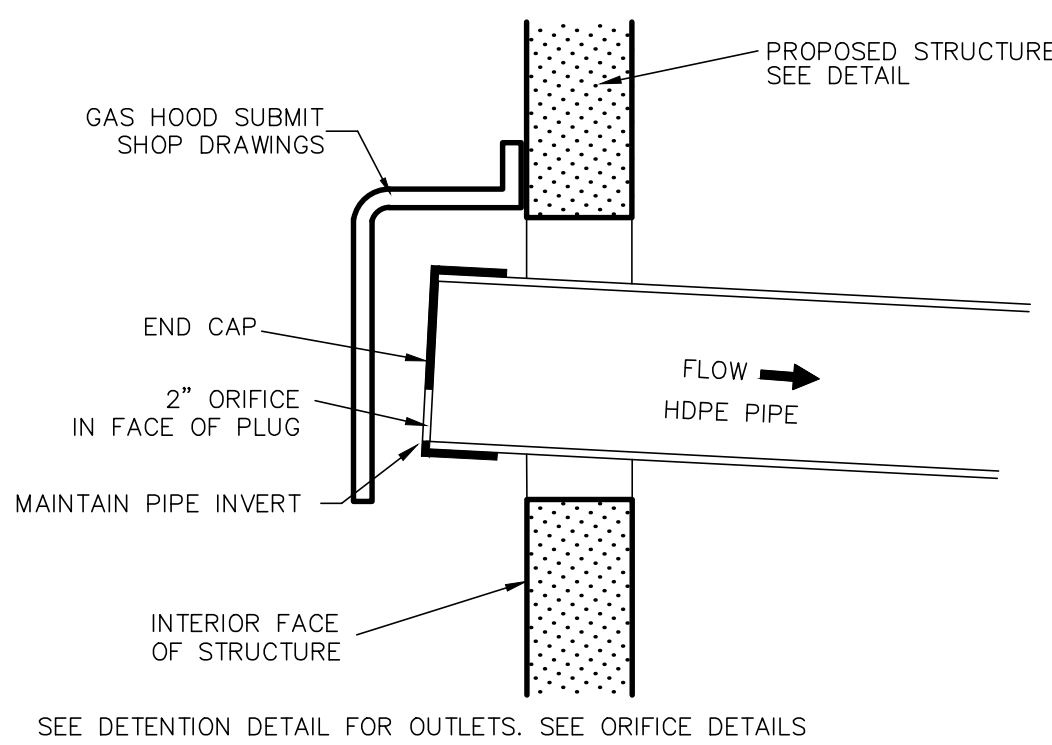

**2 C9 RESTRICTOR PLATE DETAIL**  
NOT TO SCALE

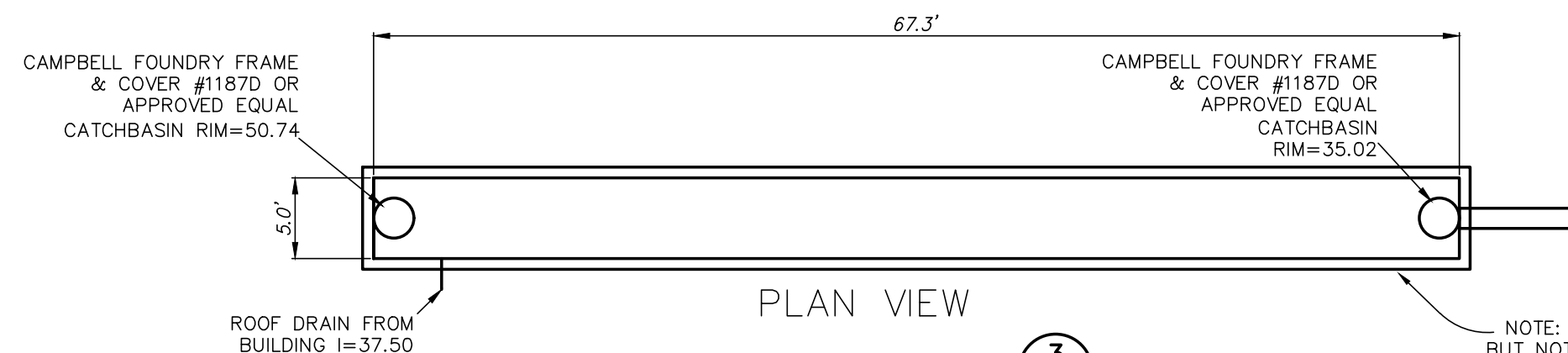

**3 C9 STORM STRUCTURE #1 DETAIL**  
NOT TO SCALE

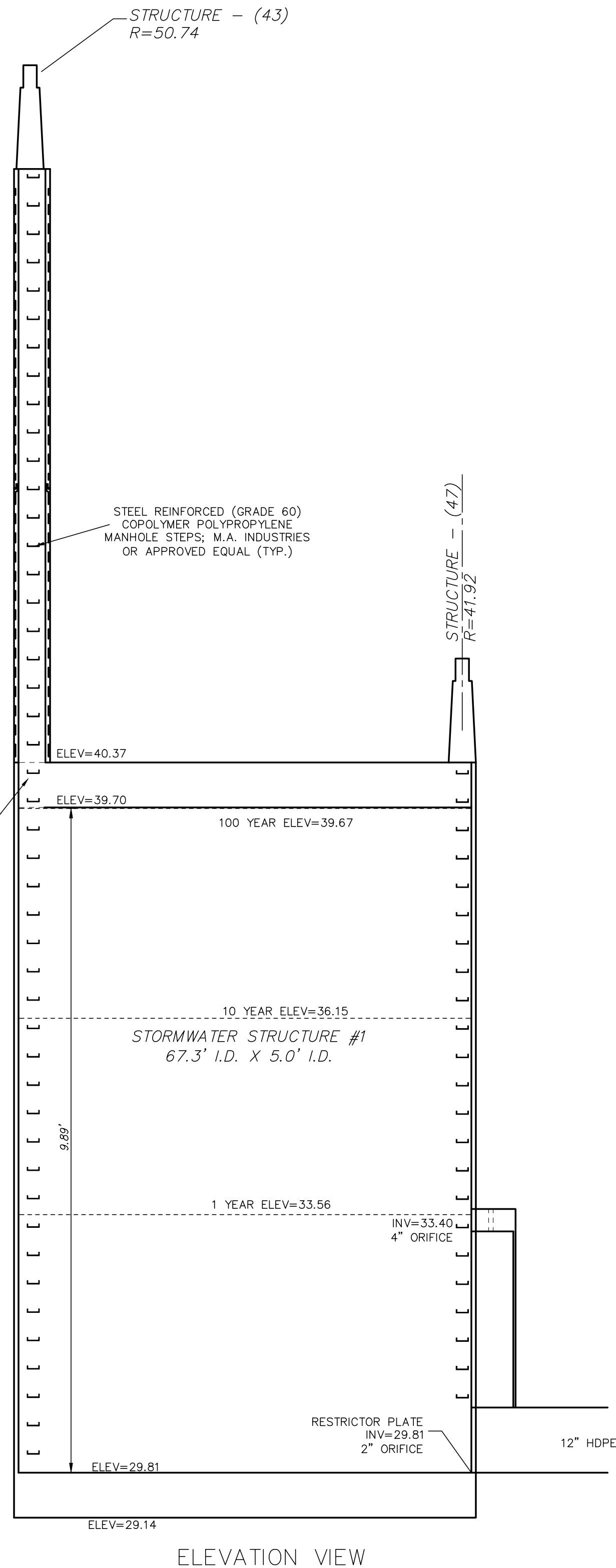

**ELEVATION VIEW**

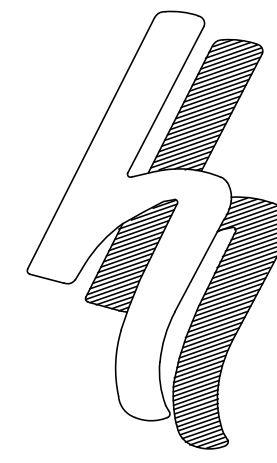

**HERSHBERG  
&  
HERSHBERG**

Consulting Engineers  
and Land Surveyors

18 Locust Street  
Albany, New York 12203

ALTERATION OF THIS  
DOCUMENT EXCEPT BY A  
LICENSED PROFESSIONAL  
ENGINEER OR LAND  
SURVEYOR, IS ILLEGAL

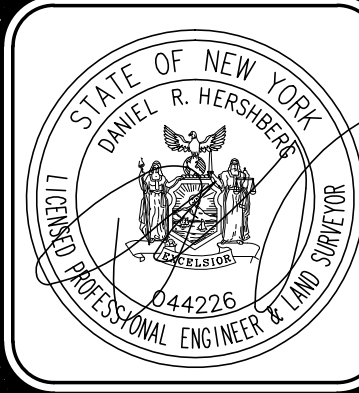

DATE	REVISIONS
8-27-2019	UTILITIES UPDATED
10-21-2019	GENERAL UPDATE
1-30-2020	BUILDING FOOTPRINT REVISED
5-18-2020	NEW BUILDING FOOTPRINT
6-23-2020	NEW BUILDING AND UTILITIES UPDATED

**STORM SEWER PLAN AND PROFILES**  
**No.67 LIVINGSTON AVENUE**  
**CITY OF ALBANY STATE OF NEW YORK**

FILE: 180196  
SCALE: AS NOTED  
BY: SAC  
CHK: DRH  
DATE: 7-29-2019  
180196-1.DWG

FOR MUNICIPAL APPROVAL ONLY-NOT INTENDED FOR CONSTRUCTION

**C9**



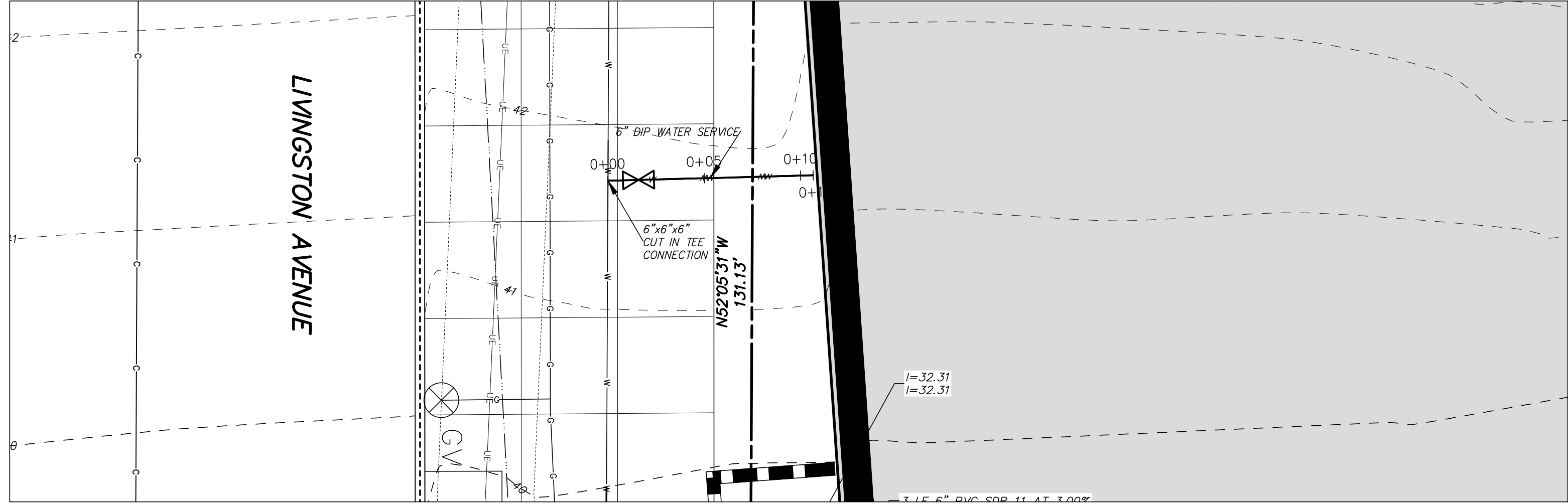
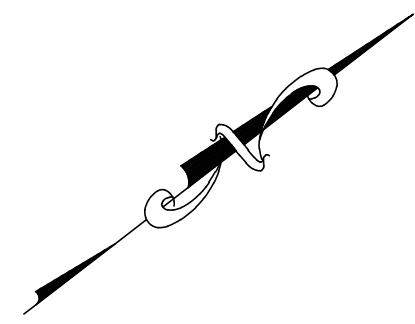

**WATER SERVICE PLAN #1**  
SCALE 1"=10'

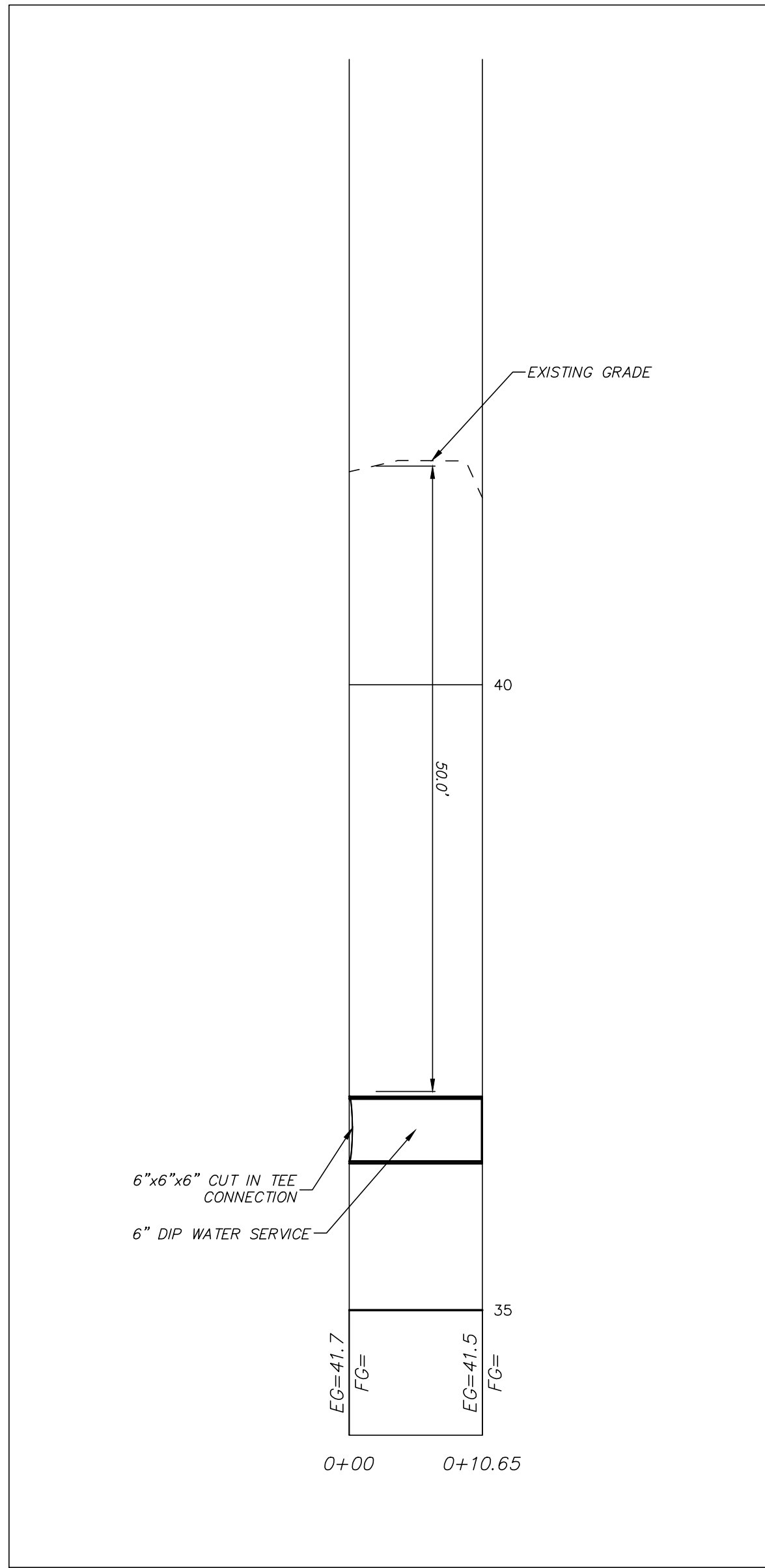
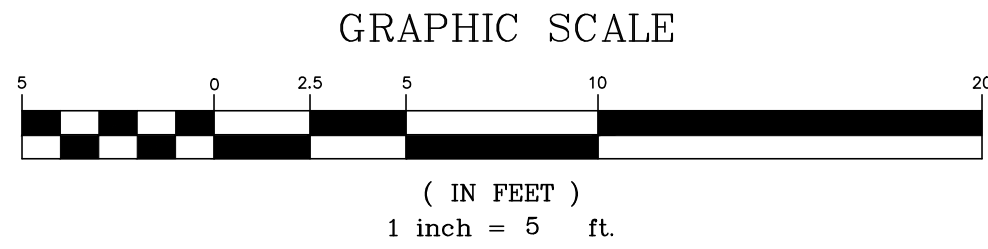

**WATER SERVICE PROFILE #1**  
SCALE (H) 1"=10'  
SCALE (V) 1"=1'

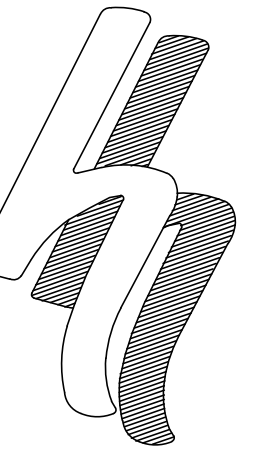
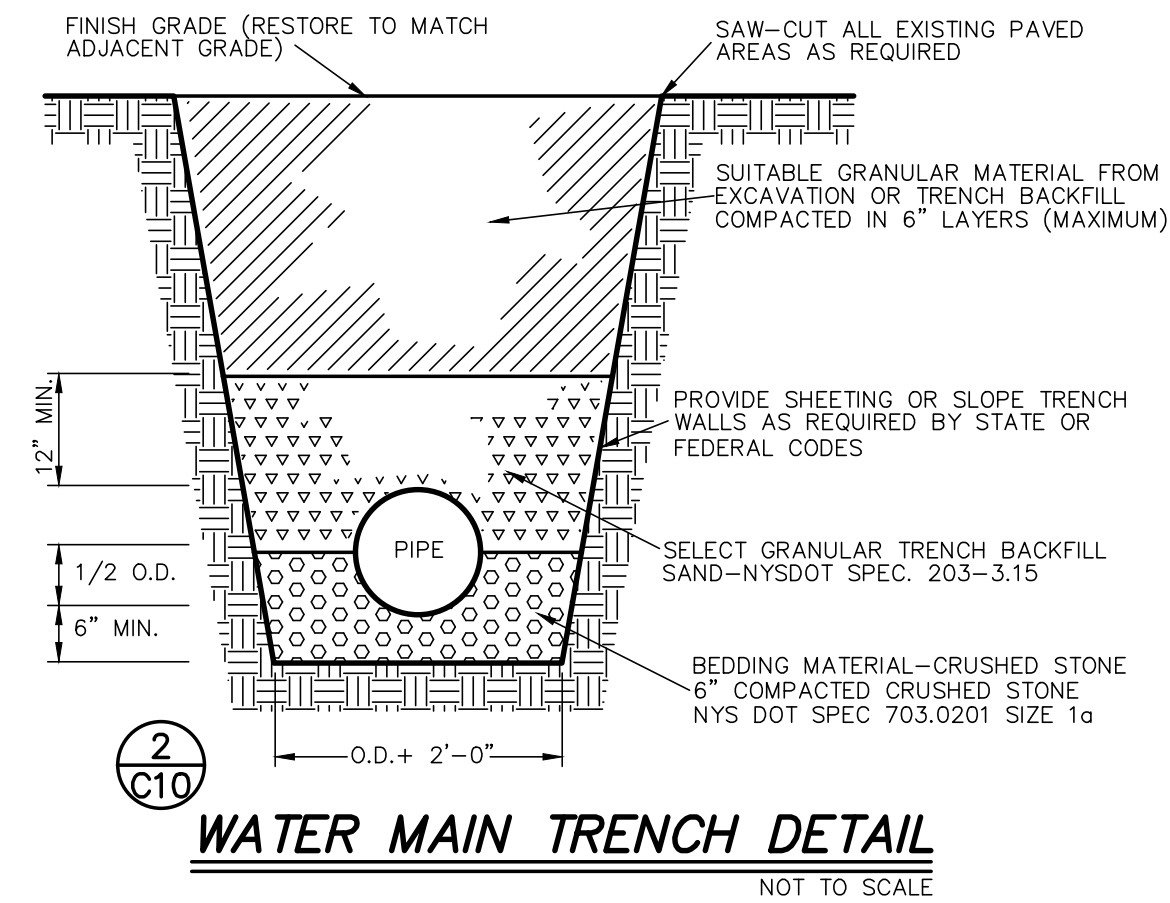
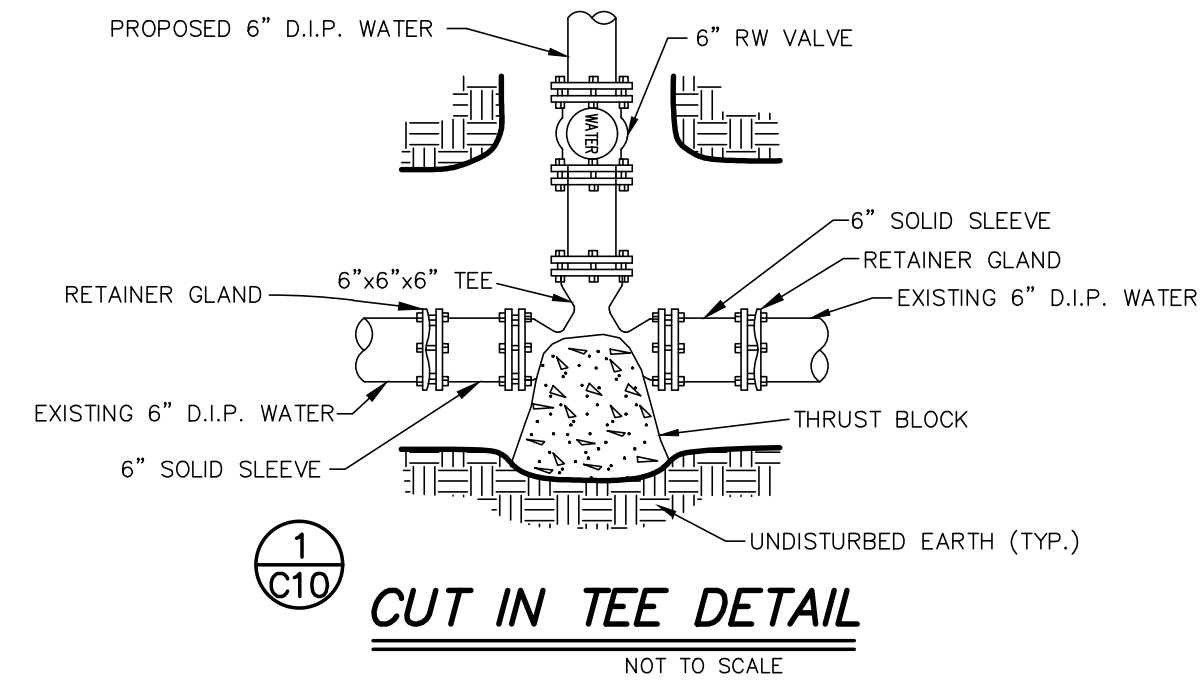

**HERSHBERG  
&  
HERSHBERG**  
Consulting Engineers  
and Land Surveyors

18 Locust Street  
Albany, New York 12203

ALTERATION OF THIS  
DOCUMENT EXCEPT BY A  
LICENSED PROFESSIONAL  
ENGINEER OR LAND  
SURVEYOR, IS ILLEGAL

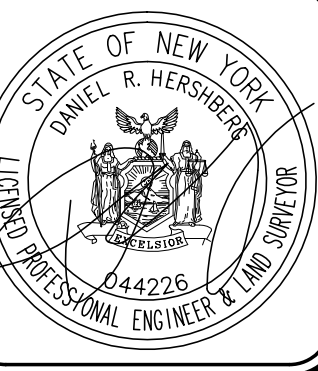

DATE	REMARKS	REVISIONS
8-27-2019	UTILITIES UPDATED	
10-21-2019	GENERAL UPDATE	
1-30-2020	BUILDING FOOTPRINT REVISED	
5-18-2020	NEW BUILDING FOOTPRINT	
6-23-2020	NEW BUILDING AND UTILITIES UPDATED	

**WATER PLAN AND PROFILES**  
**No.67 LIVINGSTON AVENUE**  
**CITY OF ALBANY STATE OF NEW YORK**

FILE: 180196  
SCALE: AS NOTED  
BY: SAGC  
CHK: DRH  
DATE: 7-29-2019  
180196-1.DWG

FOR MUNICIPAL APPROVAL ONLY-NOT INTENDED FOR CONSTRUCTION

**C10**