

EXISTING PARTIAL FIRST FLOOR PLAN ~ CITY HALL

SCALE 1/8" = 1'-0"

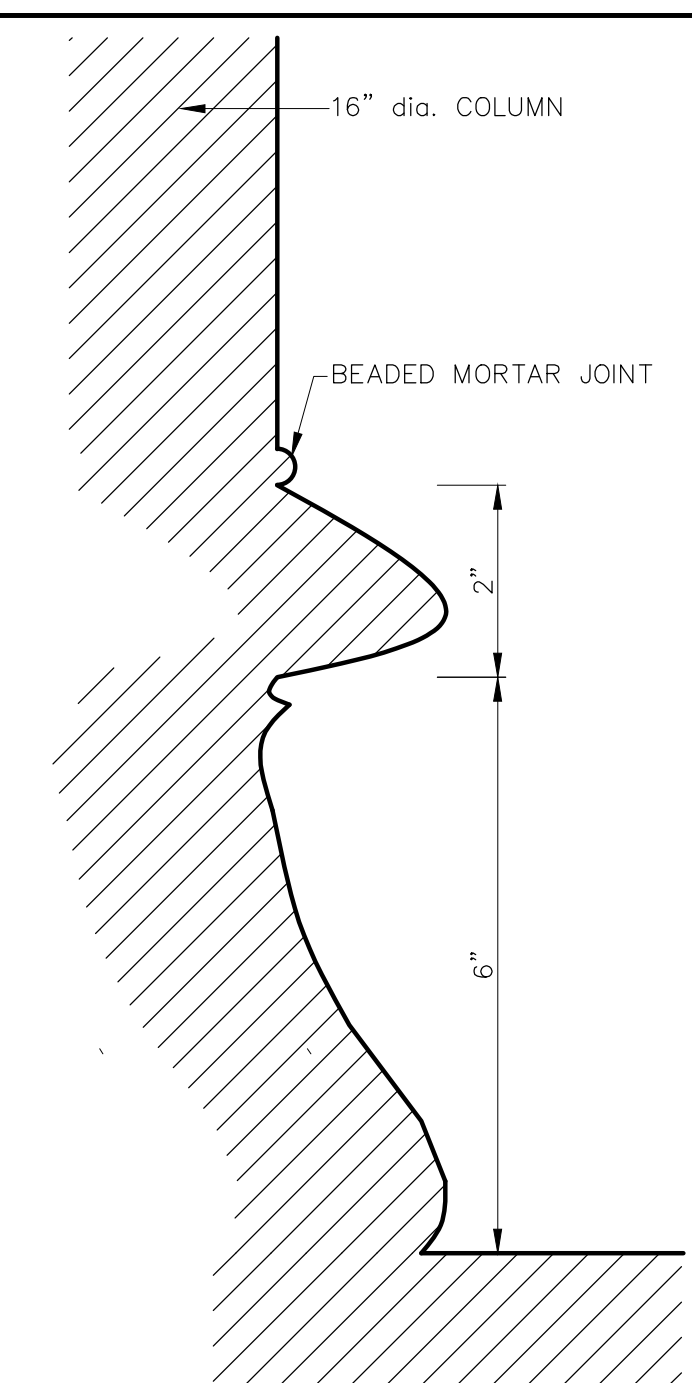

PROFILE OF COLUMN BASE

SCALE 6" = 1'-0"

NEW CONSTRUCTION SCHEDULE

ITEM	DESCRIPTION
100	INSTALL EDISON COATING, INC. - CUSTOM SYSTEM 45, TWO COMPONENT CEMENTIOUS REPAIR TO COLUMN BASE, NEW BASE REPAIR COLOR & TEXTURE SHALL MATCH THE EXISTING COLOR AND TEXTURE OF THE EXISTING COLUMN ABOVE.
101	INSTALL NEW "DUTCHMAN" COLUMN REPAIR PATCH MADE FROM "LONGMEADOW" STONE. INSTALL EDISON COATING, INC. - CUSTOM SYSTEM 45, TWO COMPONENT CEMENTIOUS REPAIR TO COLUMN BASE, NEW BASE REPAIR COLOR & TEXTURE SHALL MATCH THE EXISTING COLOR AND TEXTURE OF THE EXISTING COLUMN ABOVE.
102	PLANE 1/4" DEPTH FROM STONE RISER AND TREAD, REINSTALL STONE RISER AND TREAD IN ORIGINAL POSITIONS
103	INSTALL NEW RAILING AND POST SYSTEM. ALL POST SHALL BE INSTALLED IN ORIGINAL LOCATIONS.
104	INSTALL EDISON COATING, INC. - CUSTOM SYSTEM 45, TWO COMPONENT CEMENTIOUS REPAIR TO STAIR CHEEK WALLS & TOP, AND TRIM COURSE ABOVE CENTER ENTRANCE ARCH ALL NEW REPAIRS, COLOR & TEXTURE SHALL MATCH THE ADJOINING ORIGINAL SURFACES.
105	RE-INSTALL EXISTING DOORS, SILL, HARDWARE & RIXON BOXES IN ORIGINAL LOCATIONS
106	CLEAN EXISTING "LONGMEADOW" STONE ARCHES-SEE DRAWING A-2
107	CUT NEW "RIXON BOX" HOLES IN NEW LANDING STONE (ALTERNATE #1)
108	RAKE 150 LINEAR FEET OF MASONRY @ ENTRANCE ARCHES JOINTS 1" DEEP & INSTALL NEW POINTING MORTAR, MATCH COLOR AND TEXTURE OF EXISTING MORTAR
109	INSTALL NEW 4" CONCRETE WALK, BROOM FINISH (BASE BID)

LOCATION MAP

NO.	ISSUED	DATE

FINISH FIRST FLOOR ELEVATION 0'-0"

REMOVAL SCHEDULE

ITEM	DESCRIPTION
100	REMOVE EXISTING LOOSE MATERIAL AT COLUMN BASE OF PIER "A" & "B" (BASE BID)
101	REMOVE EXISTING COLUMN BASE @ PIER "A" & Pier "B" (ALTERNATE #1)
102	REMOVE EXISTING DAMAGED SECTION OF COLUMN - 6" h x CIRCUMFERENCE OF COLUMN (BASE BID)
103	REMOVE EXISTING STONE STEPS & LANDINGS (BASE BID & ALTERNATE #1)
104	REMOVE EXISTING RAILINGS AND POSTS. REMOVE LEAD & EPOXY FILLER FROM POST (BASE BID & ALTERNATE #1)
105	REMOVE EXISTING STUCCO REPAIRS TO TOP AND SIDES OF STAIR CHEEK WALLS (BASE BID)
106	REMOVE EXISTING DOORS, SILLS, HARDWARE & RIXON BOXES. STORE IN VESTIBULE (BASE BID)
107	REMOVE EXISTING CONCRETE WALK (BASE BID)

**SCOPE OF WORK
BASE BID / ALTERNATE #1**

- BASE BID SCOPE OF WORK:
- NUMBER EXISTING STONE w/ PAINT ON UNDERSIDE OF STONE.
 - REMOVE EXISTING ENTRANCE DOORS, SILLS AND RIXON BOXES FROM LANDING STONE.
 - WRAP DOORS IN PROTECTIVE BLANKETS AND TEMPORARILY STORE DOORS AND HARDWARE IN CITY HALL BASEMENT.
 - CONSTRUCT TEMPORARY OPENING CLOSURE WITH PLYWOOD AND WOOD STUDS. THE TEMPORARY OPENING CLOSURE SHALL BE SELF SUPPORTING AND NO ANCHORAGE TO THE SURROUNDING MASONRY SHALL BE PERMITTED. PAINT THE EXTERIOR OPENING ENCLOSURE "BLACK".
 - REMOVE THE EXISTING STONE STEPS AND RAILINGS. GAUGE 3/8" DEPTH FROM TOP OF TREAD.
 - REMOVE EXISTING PAINT AND STUCCO REPAIR FROM FACE OF RISER.
 - REINSTALL STAIR STONES IN MUD BED IN ORIGINAL LOCATIONS.
 - INSTALL NEW HANDRAIL SYSTEM.
 - INSTALL "DUTCHMAN" PATCH AT BASE OF COLUMN (PIER "B"), REPAIR COLUMN BASES AT PIER "A" & "B"
 - REPAIR STAIR CHEEK WALLS.
 - CLEAN EXISTING "LONGMEADOW" STONE ENTRANCES.
 - REMOVE TEMPORARY OPENING ENCLOSURE.
 - RE-INSTALL SILLS, RIXON BOXES AND DOORS.
 - REMOVE EXISTING CONCRETE WALK AND INSTALL NEW 4" CONCRETE WALK.

- ALTERNATE #1 SCOPE OF WORK:
- NUMBER EXISTING STONE w/ PAINT ON UNDERSIDE OF STONE.
 - REMOVE EXISTING ENTRANCE DOORS, SILL AND RIXON BOXES FROM LANDING STONE.
 - WRAP DOORS IN PROTECTIVE BLANKETS AND TEMPORARILY STORE DOORS AND HARDWARE IN CITY HALL BASEMENT.
 - CONSTRUCT TEMPORARY OPENING CLOSURE WITH PLYWOOD AND WOOD STUDS. THE TEMPORARY OPENING CLOSURE SHALL BE SELF SUPPORTING AND NO ANCHORAGE TO THE SURROUNDING MASONRY SHALL BE PERMITTED.
 - PAINT THE EXTERIOR OPENING ENCLOSURE "BLACK".
 - THE CONTRACTOR SHALL SUBMIT WITHIN TWO (2) WEEKS OF THE CONTRACT SIGNING, A DETAILED DESIGN TO THE ARCHITECT OF THE SYSTEM PROPOSED FOR THE SUPPORT OF THE EXISTING LOAD BEARING MASONRY WALL ABOVE THE COLUMN BASE AT PIER "A".
 - THE SUBMITTED SHORING PROPOSAL SHALL BE DESIGNED BY A NEW YORK STATE REGISTERED STRUCTURAL ENGINEER WHO SHALL FIELD INSPECT THE IN PLACE SHORING AND TO CERTIFY TO THE ARCHITECT IN WRITING THE SHORING SYSTEM HAS BEEN INSTALLED ACCORDING TO THE SHORING DOCUMENTS.
 - REMOVE THE EXISTING STONE STEPS AND RAILINGS.
 - STORE THE EXISTING STONE STEPS IN THE CITY HALL SUB-BASEMENT. SEPARATE EACH STONE WITH 2" x 4" DUNNAGE @ 48" o.c.
 - INSTALL NEW "RED QUARTZ" STONE STEPS IN MUD BED.
 - INSTALL NEW RAILING SYSTEM.
 - INSTALL NEW "LONGMEADOW" STONE COLUMN BASES (PIER A & B) & STONE "DUTCHMAN" COLUMN REPAIR AT PIER "B"
 - INSTALL NEW COLUMN BASES AT PIER "A" & "B".
 - REMOVE TEMPORARY OPENING ENCLOSURE AND SHORING SYSTEM.
 - RE-INSTALL SILL, RIXON BOX HARDWARE AND DOORS.

PAINT SCHEDULE

SURFACE	SPECIFICATION
FERRIS METAL	FIRST COAT: EXTERIOR LATEX PRIMER SECOND COAT & THIRD COATS: EXTERIOR SEMI-CLOSS ENAMEL

LEGEND

SYMBOL	DESCRIPTION
[Solid line]	EXISTING CONSTRUCTION TO REMAIN
[Dashed line]	EXISTING MASONRY TO BE REMOVED
[Hatched pattern]	EXISTING MASONRY TO BE REMOVED, REPAIRED OR REPLACED
[Stippled pattern]	NEW REPAIRS TO COLUMNS AND COLUMNS BASES

- THE CONTRACTOR SHALL LIMIT THE REMOVAL OF THE EXISTING STONE STEPS & LANDINGS TO TWO OF THE EXISTING BUILDING ENTRANCE STEPS, LEAVING ONE BUILDING ENTRANCE OPERATIONAL. WHEN TWO BUILDING ENTRANCE STEPS CONSTRUCTION IS COMPLETED THE CONTRACTOR MAY BEGIN CONSTRUCTION WORK ON THE REMAINING ENTRANCE.
- THE EXISTING STONE STAIRS, LANDINGS, DOORS AND HARDWARE SHALL BE REMOVED WITH THE UTMOST CARE SO AS NOT TO DAMAGE THE STONES. ALL DAMAGED STONES SHALL BE REPLACED BY THE CONTRACTOR "WITH IN KIND MATERIALS" AT THE EXPENSE OF THE CONTRACTOR. NO ADDITIONAL COMPENSATION SHALL BE ANTICIPATED.

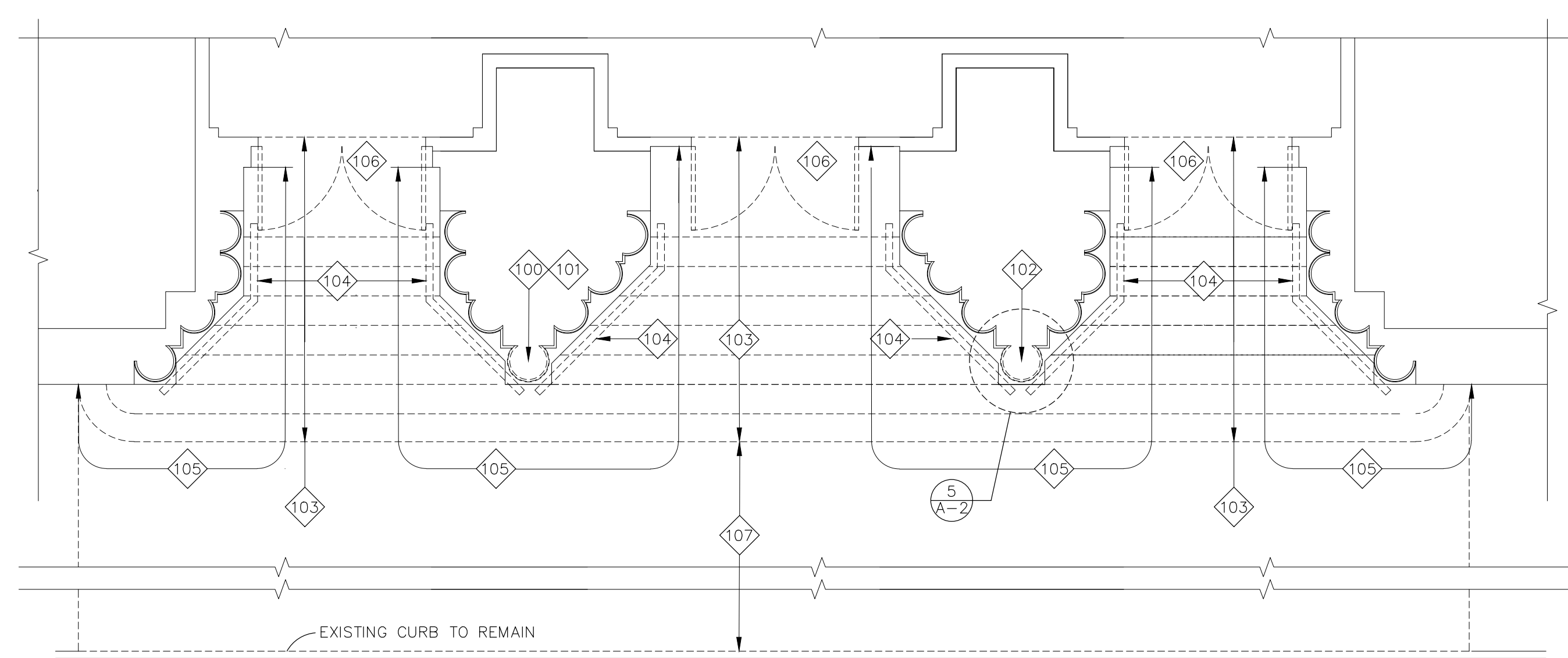

3 PARTIAL FIRST FLOOR REMOVAL PLAN

SCALE 1/4" = 1'-0"

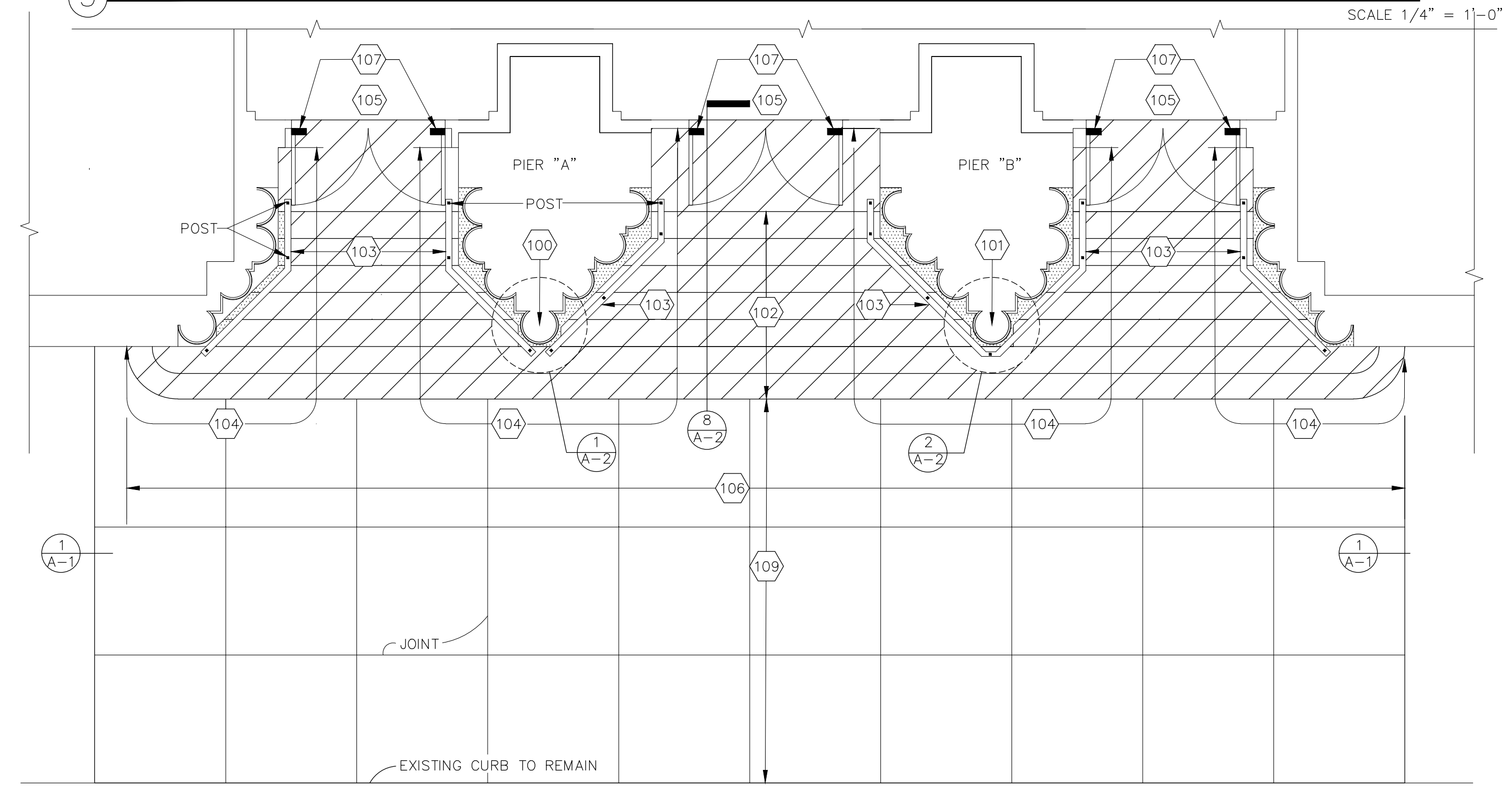

4 PARTIAL FIRST FLOOR PLAN

SCALE 1/4" = 1'-0"

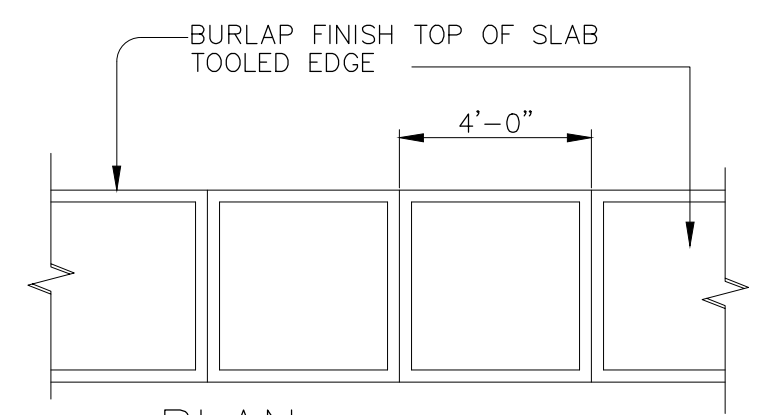

2 PLAN SCALE NONE

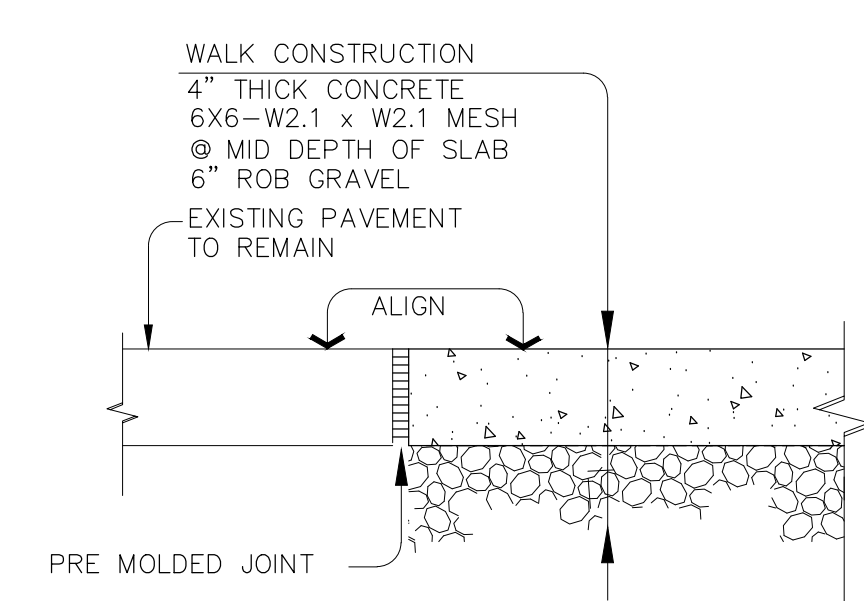

1 DETAIL SCALE 1-1/2" = 1'-0"

JAMES DALY TOBIN

ARCHITECTS



CITY OF ALBANY
DEPARTMENT OF GENERAL SERVICES
DIVISION OF ENGINEERING
CITY HALL

FLOOR PLANS & DETAILS

DATE
FEBRUARY 15, 2019

SCALE
AS NOTED

OPUS
18.120



A-1

ALBANY MASONRY 2019 - A1-178

518 - 668-3609

NEW YORK

LAKE GEORGE

15 DARK BAY ROAD