

KEYPLAN

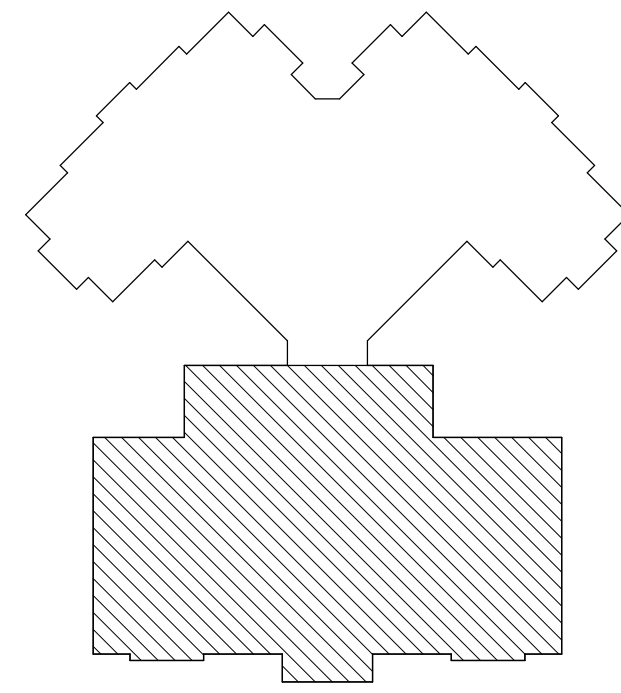

SEE A1.1A FOR GENERAL NOTES

- SYMBOL LEGEND**
- NEW INTERIOR PARTITION CONSTRUCTION
  - LINE OF SOFFIT (ABOVE) SEE A23 SERIES DRAWINGS FOR CONSTRUCTION AND A25 SERIES FOR HEIGHTS
  - VERIFY IN FIELD (CONTRACTOR SHALL NOTIFY THE ARCHITECT IMMEDIATELY OF ANY DISCREPANCIES FROM DIMENSIONS INDICATED)
  - DIMENSION STARTING POINT
  - DIMENSION LINE (CENTERLINE)
  - DIMENSION LINE (FACE OF WALL OR MATERIAL)
  - DIMENSION LINE (FACE OF STUD)
  - ROOMNAME AND NUMBER DESIGNATION
  - WALL SECTION DESIGNATION
  - ELEVATION DESIGNATION
  - WINDOW DESIGNATION (SEE A3 SERIES AND A30 SERIES FOR DETAILS)
  - 1/2" PLYWOOD SHEATHING APPLIED TO FACE OF STUDS (FULL HEIGHT) PRIOR TO GYPSUM BOARD INSTALLATION. SEE A1.1A AND A1.1B FOR LOCATIONS AND EXTENTS

ARCHITECTURE / INTERIOR DESIGN  
**WCGS ARCHITECTS**  
 20 CORPORATE WOODS BOULEVARD ALBANY, NEW YORK 12211  
 518 434-2856

ARCHITECTURE / INTERIOR DESIGN  
**HUSTON ENGINEERING**  
 400 TRUDY, NEW YORK 12180  
 518 326-0986

ARCHITECTURE / INTERIOR DESIGN  
**LYNCH MYKINS STRUCTURAL ENGINEERS**  
 8032 HOUSE DRIVE, SUITE 200, VIRGINIA BEACH, VIRGINIA 23462  
 757 671-6828

PROJECT NUMBER: 18001  
 FIRST PRINTING

NORTHERN RIVERS  
**BEHAVIORAL HEALTH CTR.**  
 80 ACADEMY ROAD  
 ALBANY, NEW YORK

RESIDENCE WING  
**FLOOR PLAN**  
 SCALE: 1/8" = 1'-0"

30 PERCENT PROGRESS SET FOR OMH REVIEW - SEPTEMBER 29, 2017