

1 PROPOSED LEVEL 1
1/8" = 1'-0"

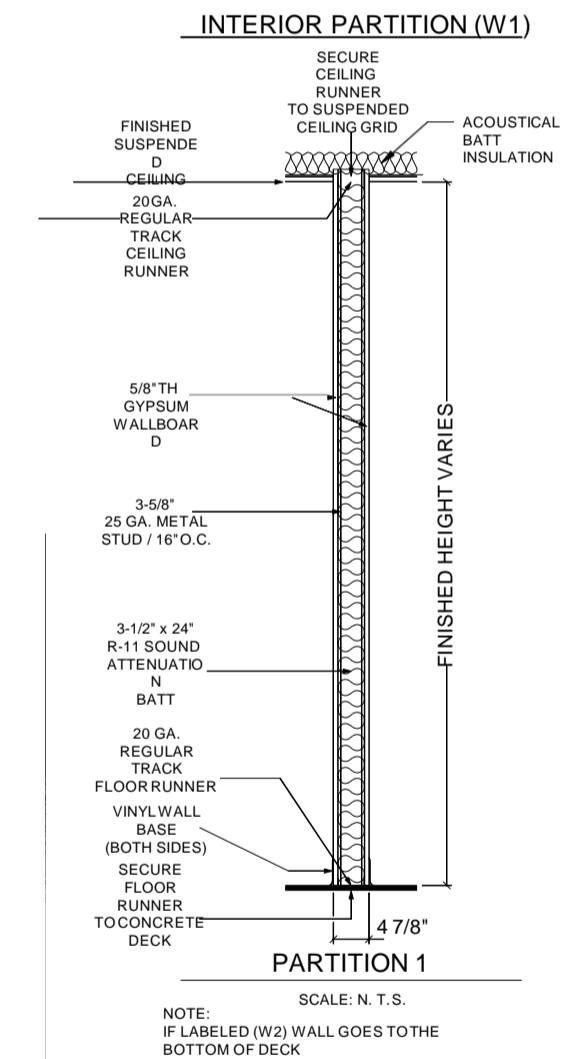

GYPSUM BOARD ASSEMBLIES

PART 1 GENERAL

1.01 REFERENCES

- A. ASTM C 475/C 475M - Standard Specification for Joint Compound and Joint Tape for Finishing Gypsum Board; 2002.
- B. ASTM C 840 - Standard Specification for Application and Finishing of Gypsum Board; 2005.
- C. ASTM C 1002 - Standard Specification for Steel Self-Piercing Tapping Screws for the Application of Gypsum Panel Products or Metal Plaster Bases to Wood Studs or Steel Studs; 2004.
- D. ASTM C 1396/C 1396M - Standard Specification for Gypsum Board; 2004.
- E. GA-216 - Application and Finishing of Gypsum Board; Gypsum Association; 2004.
- F. GA-600 - Fire Resistance Design Manual; Gypsum Association; 2006.

1.02 SUBMITTALS

- A. See Section 01300 - Administrative Requirements, for submittal procedures.
- B. Product Data: Provide data on gypsum board and joint finishing system.

1.03 QUALITY ASSURANCE

- A. Perform in accordance with ASTM C 840. Comply with requirements of GA-600 for fire-rated assemblies.

PART 2 PRODUCTS

2.01 GYPSUM BOARD MATERIALS

- A. Gypsum Wallboard: ASTM C 1396/C 1396M. Sizes to minimize joints in place; ends square cut.
 - 1. Regular Type:
 - a. Application: Use for vertical surfaces, unless otherwise indicated.
 - b. Thickness: 1/2 inch.
 - c. Edges: Tapered.
 - 2. Fire Resistant Type: Complying with Type X requirements; UL or WH rated.
 - a. At Assemblies Indicated with Fire-Rating: Use type required by indicated tested assembly; if no tested assembly is indicated, use Type X.
 - b. Edges: Tapered.

2.02 ACCESSORIES

- A. Joint Materials: ASTM C 475 and as recommended by gypsum board manufacturer for project conditions.
 - 1. Ready-mixed vinyl-based joint compound.
 - 2. Chemical hardening type compound.
- B. Screws: ASTM C 1002; self-piercing tapping type.

PART 3 EXECUTION

3.01 EXAMINATION

- A. Verify that project conditions are appropriate for work of this section to commence.

3.02 GYPSUM BOARD INSTALLATION



950 LOUDON RD LATHAM, NY 12110
T: 518-783-1663 F: 518-786-8294
WWW.COTLERARCHITECTURE.COM

COPYRIGHT 2016
COTLER ARCHITECTURE
Unauthorized alteration or addition to this document is a violation of Section 7209 Subdivision 2 of the New York State Education Law

PROJECT: OFFICE RENOVATION
Owner
Project Status
WASHINGTON AVENUE EXTENSION

DRAWING: PROPOSED FIRST FLOOR

SCALE: As indicated

DATE: 11/18/16

DRAWN BY: MS

CHECKED BY: DG

REVISIONS:

PERMIT SET: 11/18/2016

PROJECT NO:
1632

DRAWING NO:
A1.0